

20

TOWNSHIP 37S, RANGE 2W, W. M.

North

West

East

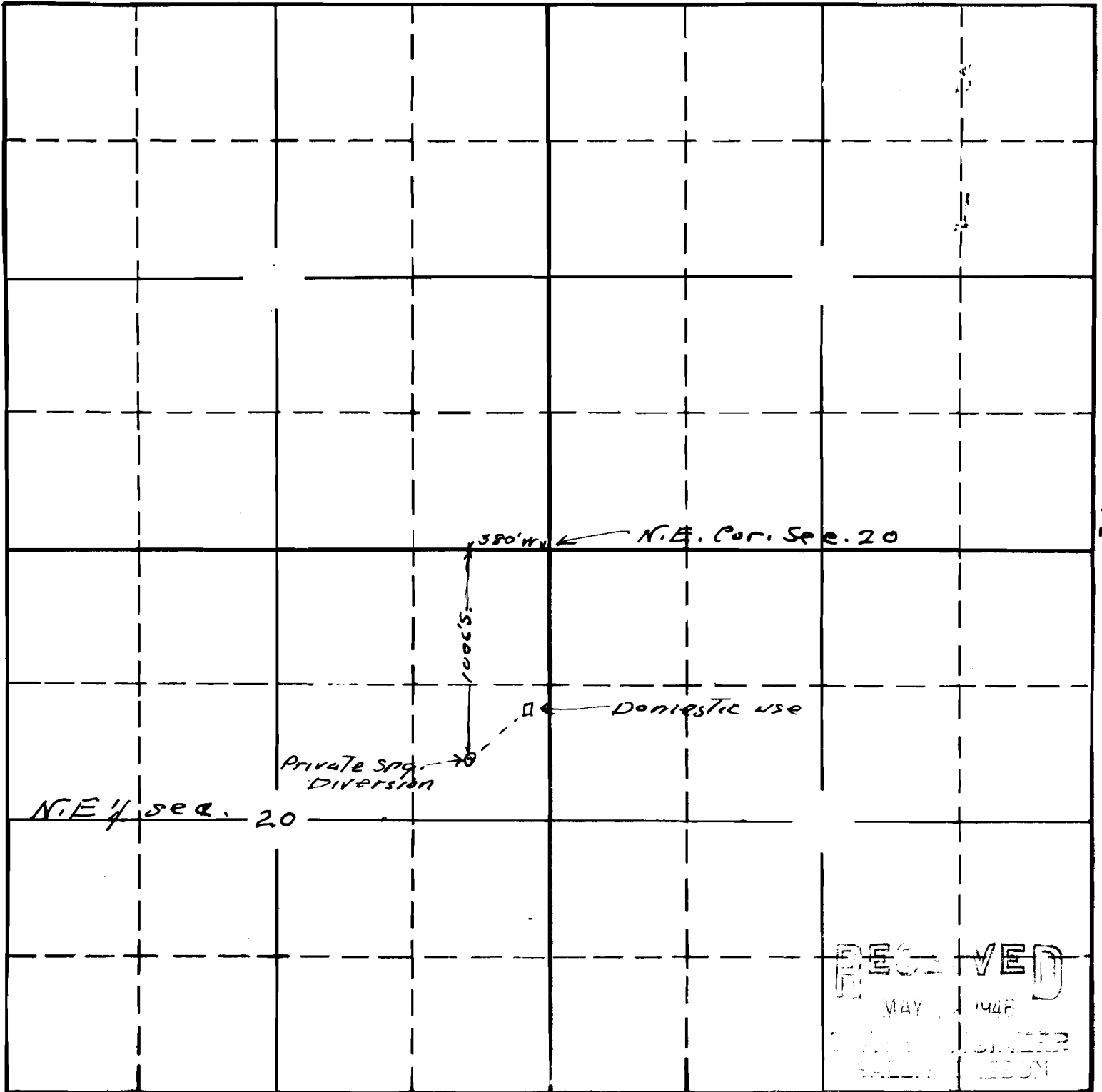

South

RECEIVED  
 MAY 1946  
 COUNTY CLERK  
 SULLY, ILLINOIS

21655

15-24

Map to accompany application of  
 H.A. McCullough for use of private  
 Spring for domestic and 1/2 ac garden

APPLICATION No. 21655  
 PERMIT No. 17009

This office 5/4/46 *[Signature]*