

# GRUB CREEK DITCH.

Mrs. J.M. Herburger  
Appropriator.

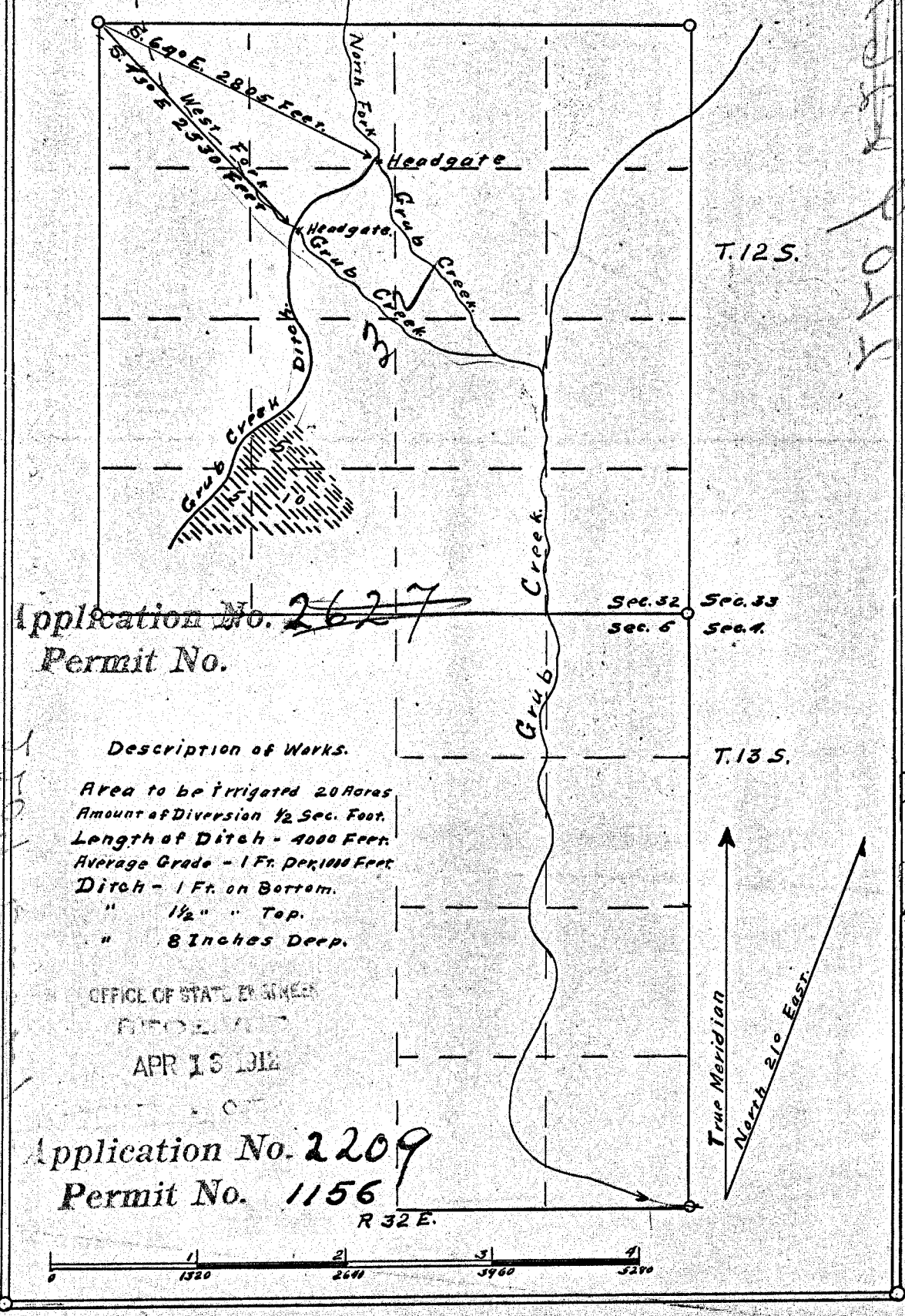

Application No. ~~2627~~  
Permit No.

### Description of Works.

- Area to be irrigated 20 Acres
- Amount of Diversion 1/2 Sec. Foot.
- Length of Ditch - 4000 Feet.
- Average Grade - 1 Ft. per 1000 Feet.
- Ditch - 1 Ft. on Bottom.
- " 1/2" " Top.
- " 8 Inches Deep.

OFFICE OF STATE ENGINEERS  
BUREAU OF IRRIGATION  
APR 13 1914

Application No. 2209  
Permit No. 1156

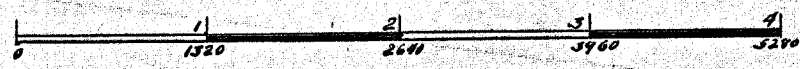

1000