

T.9S.R.2E.W.M.

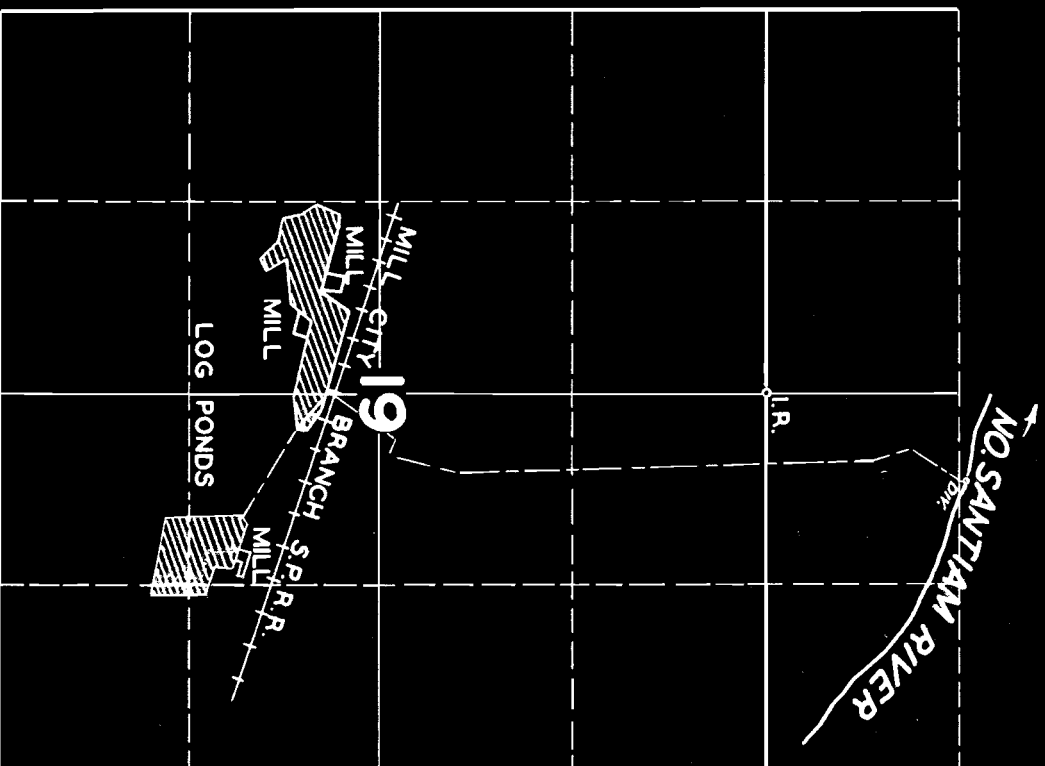

FINAL PROOF SURVEY

UNDER

R-22437

R-924

Application No. 22438 Permit No. 18114

IN NAME OF

FRERES LUMBER CO. & MT. JEFFERSON LUMBER CO.

MAY 10

Surveyed AUG. 27, 1948, by JAS. E. BUNNELL

MT JEFFERSON LUMBER CO.

Proposed Pipeline

Scale 1" = 200' March 1947

T. 9 S., R. 2 E. W.M.



I hereby certify that the survey notes indicated on this map are a true copy of the original survey made in March 1947.
Signed *A.H. Geddes*
Field work & Drawing by *L. Burl Smith*

R-21437
20438
P-984
18111

