

# T. 4 S., R. 4 W., W.M.

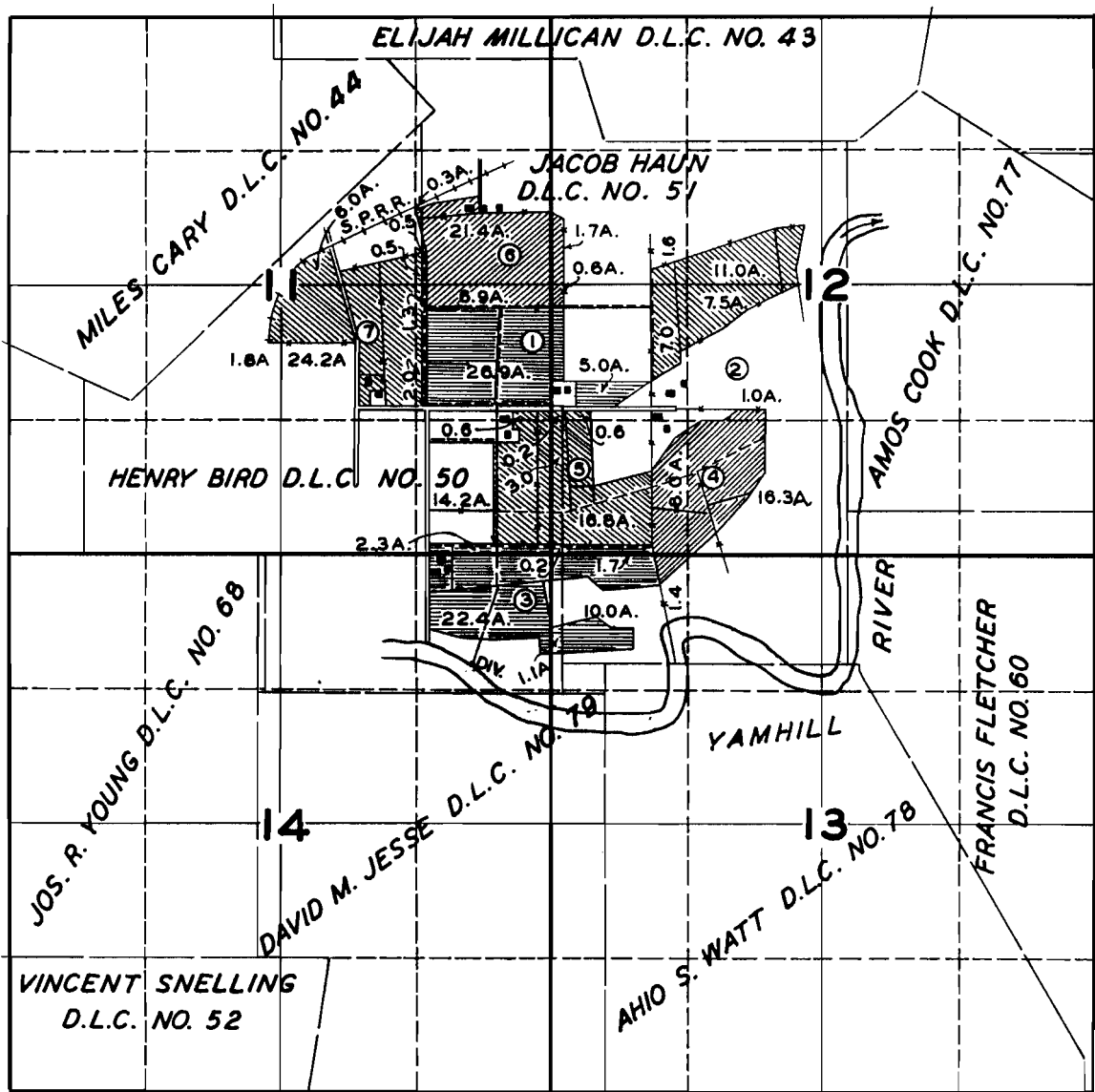

- ① CLAIR L. STRINGER & OLGA E. STRINGER—② GLYDE E. BOWEN & ELMA A. BOWEN  
 ③ HERBERT C. MC.GHEHEY & LUCILLE I. MC.GHEHEY—④ DON C. HOUGHAM & RUBY L. HOUGHAM  
 ⑤ LEO M. LAUNE & LILLIAN R. LAUNE—⑥ ORAL WINTERS & N. MARIE WINTERS  
 ⑦ STANLEY J. HERMENS & ERMA A. HERMENS.

## FINAL PROOF SURVEY

UNDER  
 17710 13389  
 Application No. 18128 Permit No. 13776  
 IN NAME OF

Surveyed AUG. 13 1948 by JAS. E. BUNNELL