

31

TOWNSHIP 34S, RANGE 4W, W. M.

North

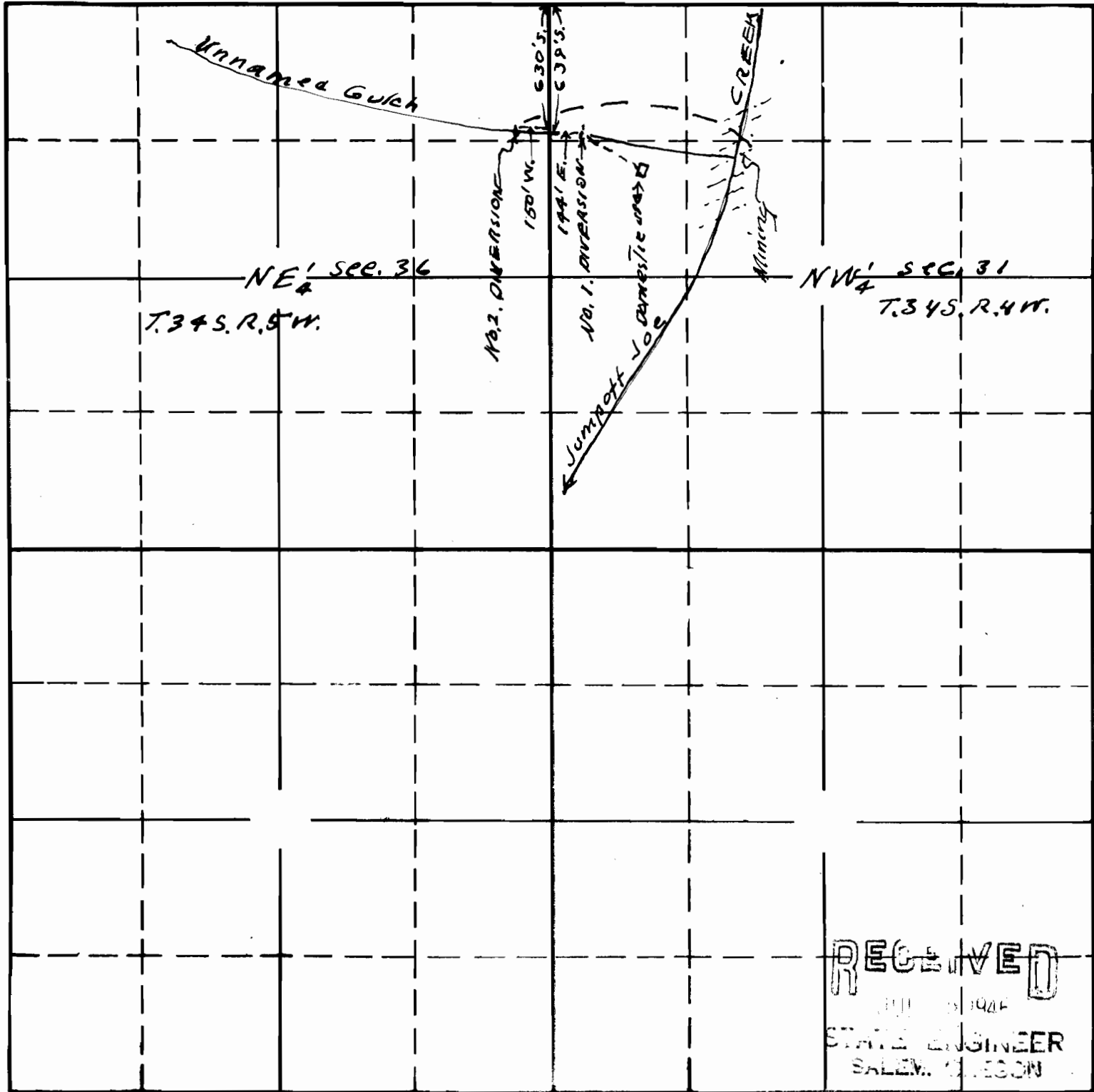

West

East

RECEIVED
 JUN 29 1946
 STATE ENGINEER
 SALEM, OREGON

21778 15-78E

Map to accompany application of
 Mrs Hazel Campbell for use of
 waters from Unnamed Gulch for
 Mining domestic & 1/2 ac of garden

APPLICATION No. 21778
 PERMIT No. 17132

This office June 29/46 *AS*