

SECTION

33

TOWNSHIP 32 S, RANGE 3 E, W. M.

North

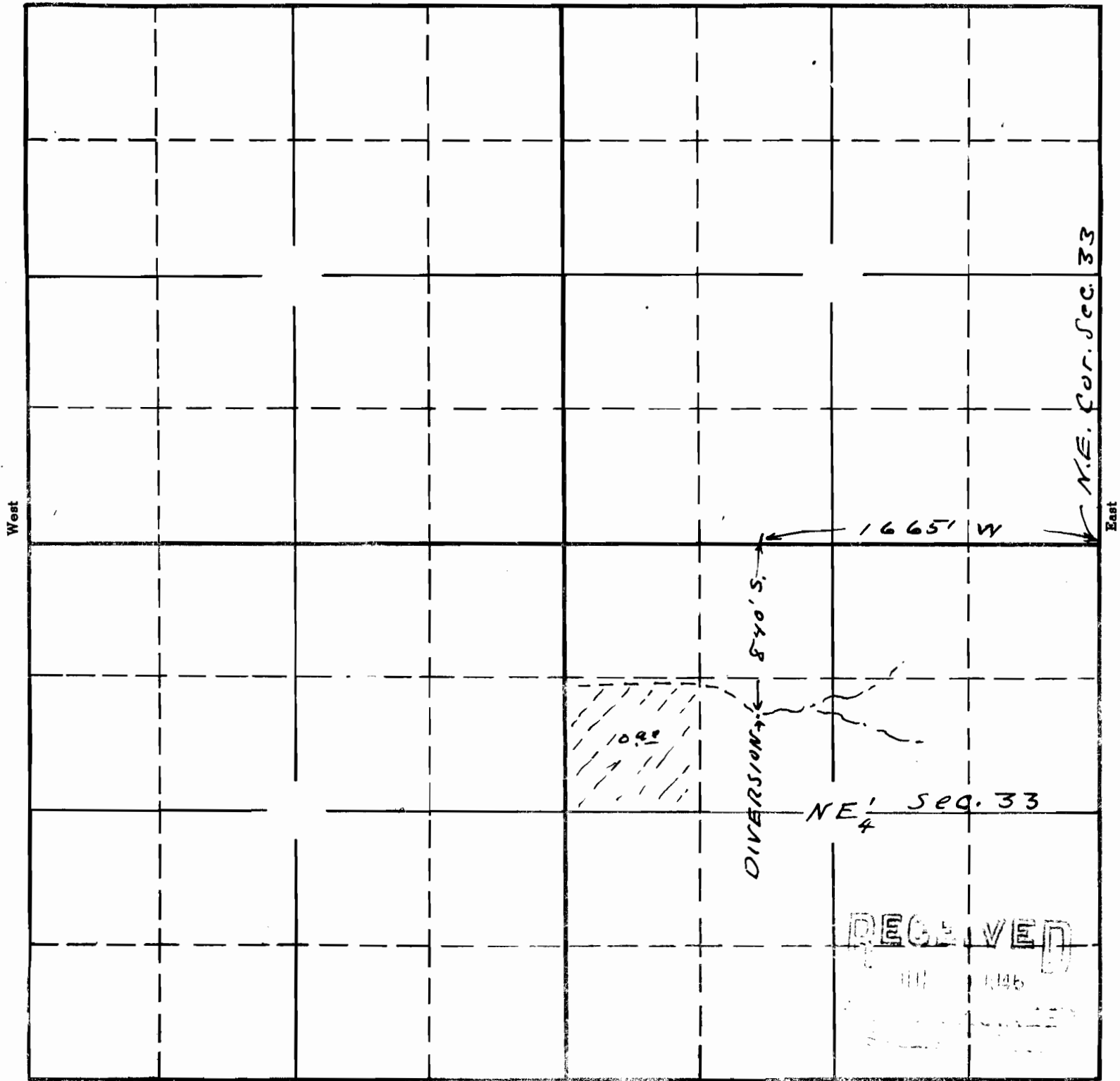

South

Map To accompany application of
 Clifford E Green for use of
 waste and runoff waters from
 Ditch north fields for irrigation

This office 7/13/46 Smith

RECEIVED

21815 15-785
 APPLICATION No. ~~21815~~
 PERMIT No. 21815
 17221