

15

14

13

22

23

24

27

26

25

31

35

36

Lexington

Dam

Pehlund Ditch - Capacity  
ordinary 1.25 Sec. feet

1ac

16ac

12ac

20ac

15ac

26ac

2

1ac

FROM OFFICE OF THE STATE ENGINEER, SALEM, OREGON

*Willow Creek Adjudication.*

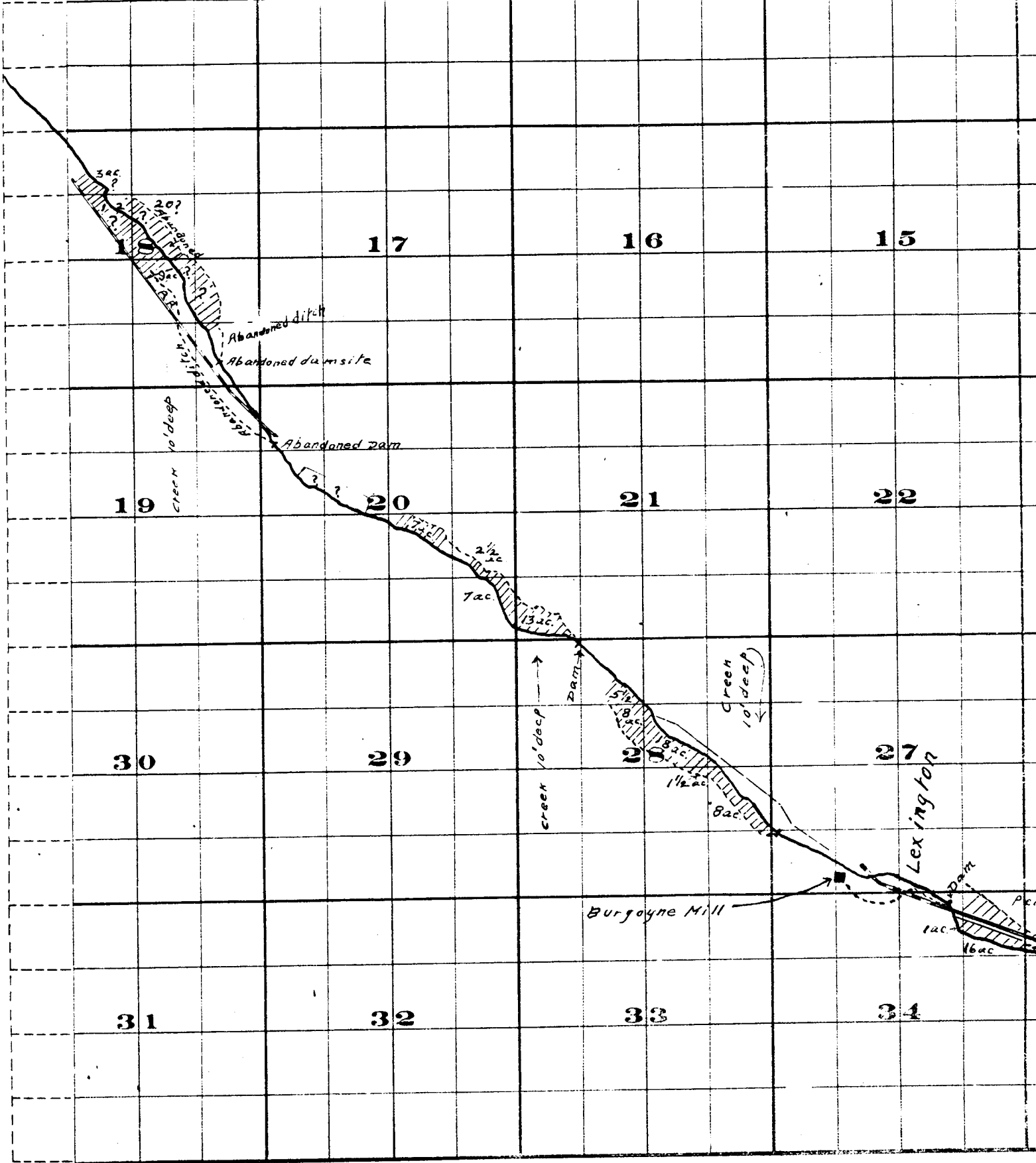

THE S. A. BRISTOL CO. PRINTERS & BOOKBINDERS 117 ART BLDG.

Surveyed by R.D. Gooper - July 1909

John H. Lewis - State Engineer

Examined July 14, 1909.

Township 1 S. , R:

