

2496

0057

OFFICE OF STATE ENGINEER  
RECEIVED  
APR 13 1915  
SALEM, OREGON

# WM. LEDFORD DITCHES

## CROOK COUNTY

### ORE.

Application No. 4200  
Permit No. 2496

T.16S.R.19E.

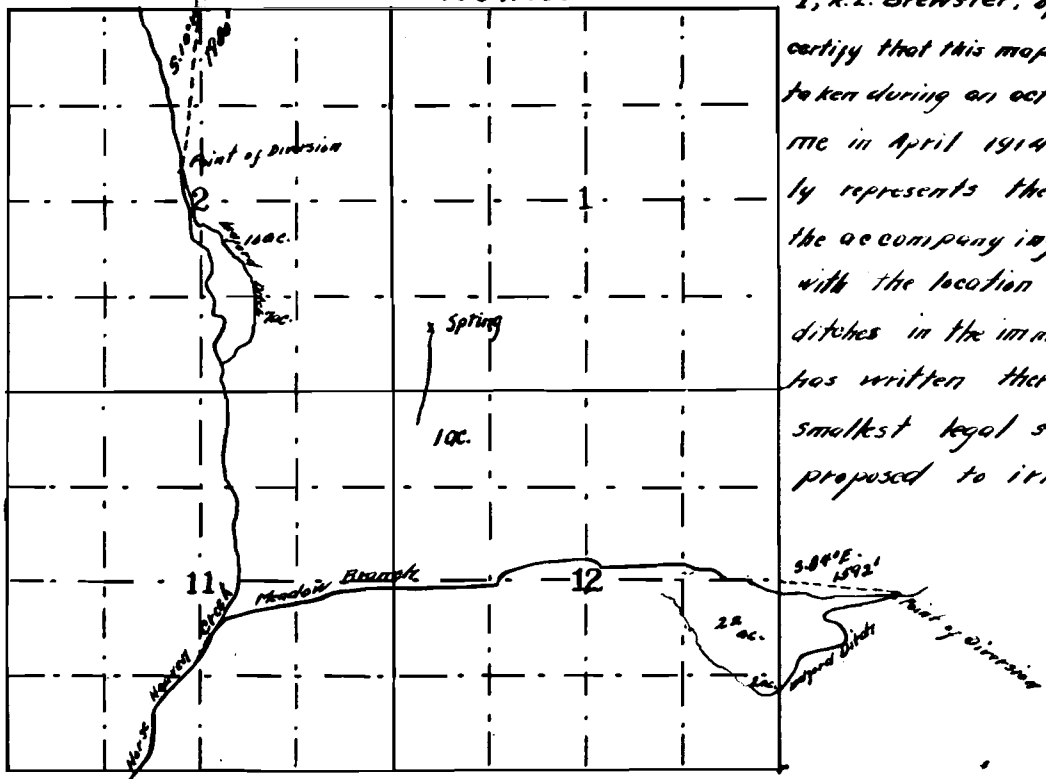

I, R.L. Brewster, of Prineville Ore. hereby certify that this map was made from notes taken during an actual survey made by me in April 1914 and that, it correctly represents the works described in the accompanying application together with the location of streams and other ditches in the immediate vicinity and has written thereon the area in each smallest legal subdivision which it is proposed to irrigate

R.L. Brewster  
Surveyor

0  
0  
h  
t

0057