

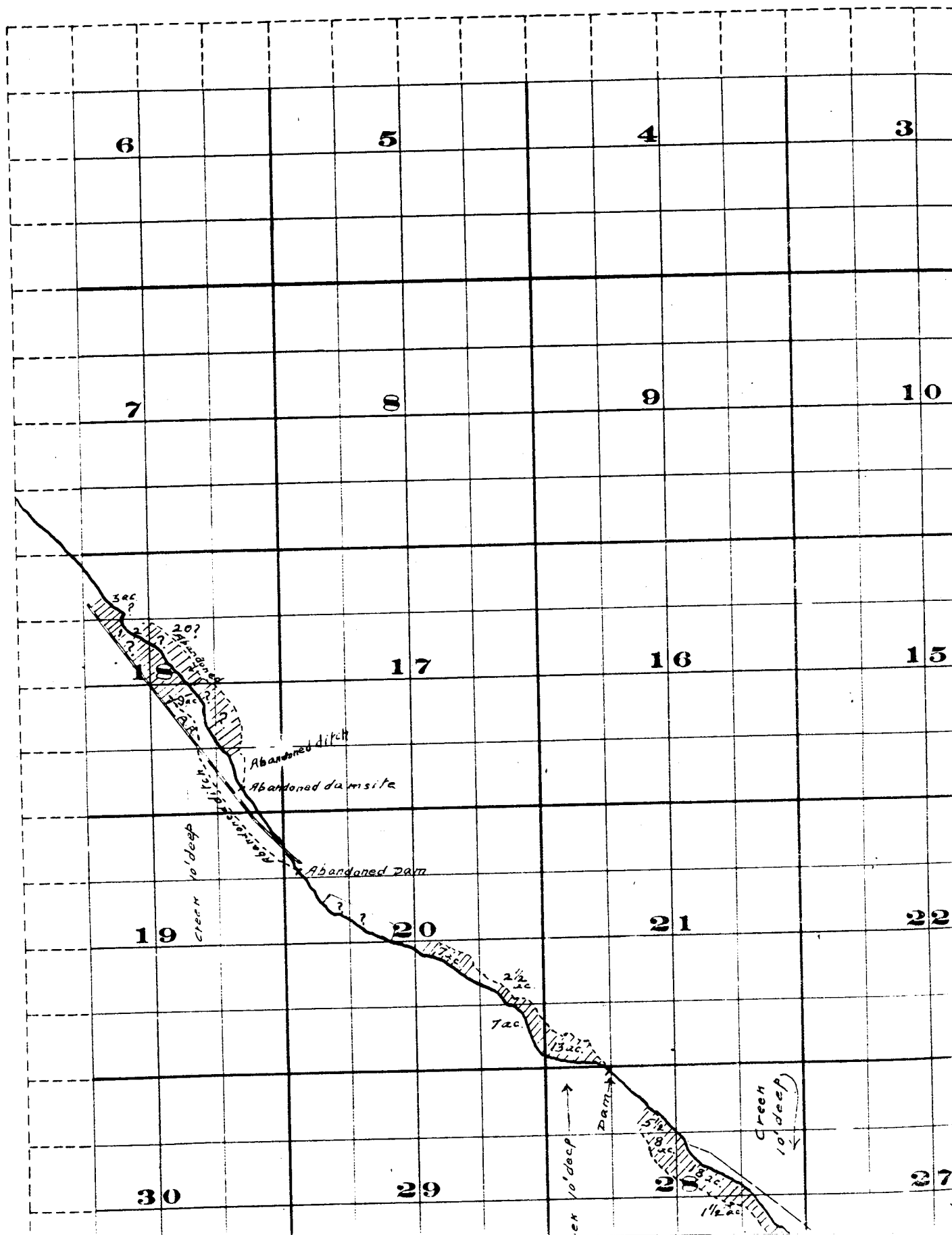

Township 1 S. , R.

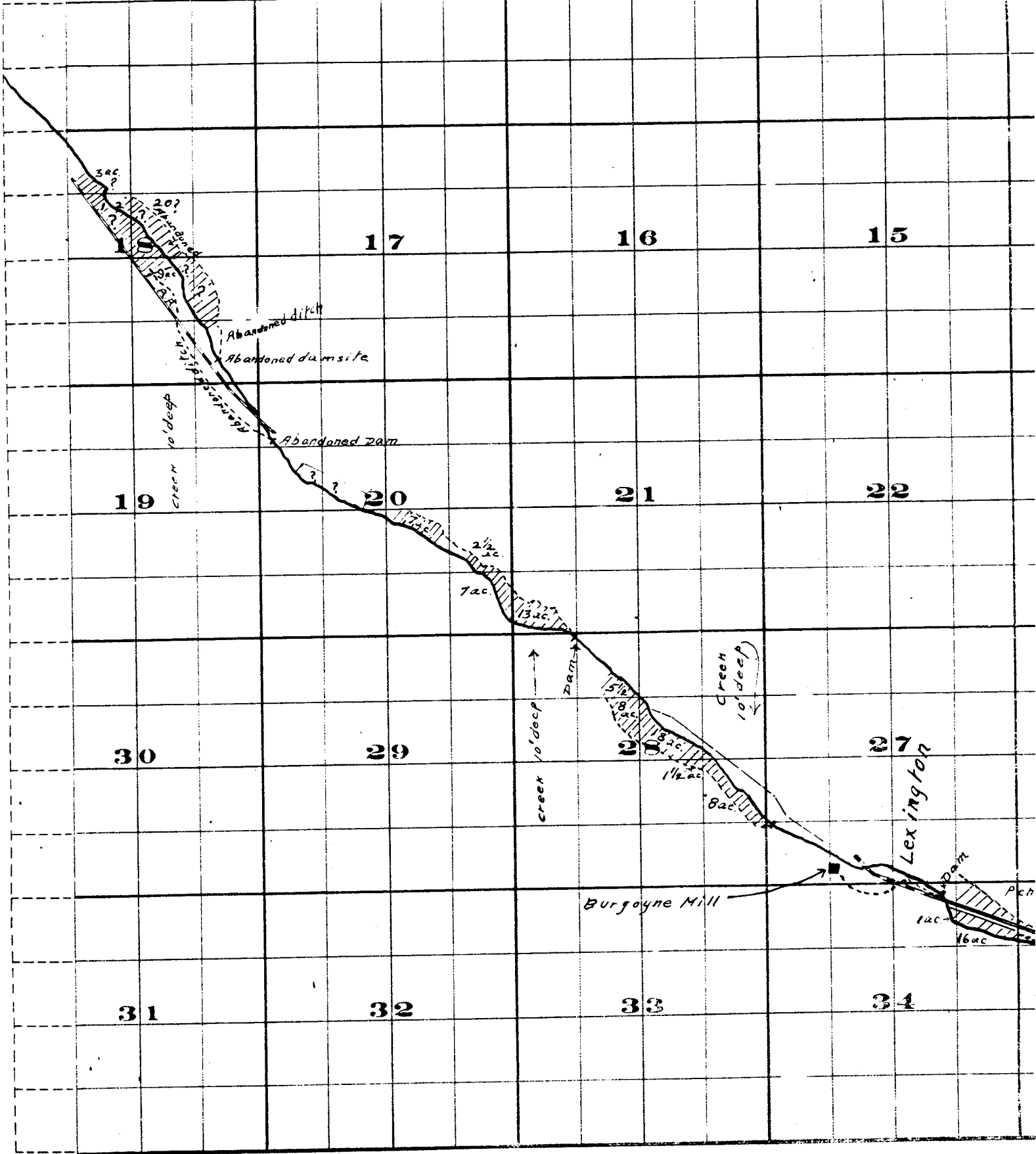



THE S. A. BRISTOL CO. PRINTERS & BOUNDERS, 107 N. 2ND ST., PHOENIX, ARIZ.

Surveyed by R.D. Gooper - July 1909

John H. Lewis - State Engineer

Examined July 14, 1909.

15

14

13

22

23

24

27

26

25

34

35

36

Lexington

Dam

Pehland Ditch - Capacity ordinary 1.25 sec. feet

1ac

16ac

12ac

20ac

15ac

20ac

2ac

6ac

1ac

FROM OFFICE OF THE STATE ENGINEER, SALEM, OREGON

*Willow Creek Adjudication.*