

1609

MAP OF
LOCATION OF DAM SITE
AND
PIPE LINE ROUTE
FOR

CARLTON CITY WATER WORKS

To accompany application for permit to appropriate
public water

Scale 2 in = 1 mi.

Nov. 1911.

CEA

I, R.W. Jones,

certify that this map was
made by an actual survey made
under my direct supervision (or
under the immediate supervision of
an actual surveyor) and that it
correctly shows the location of
the proposed dam and pipe line
and that it correctly shows the
location of the streams in the
immediate vicinity of the
proposed dam and pipe line.

1609
Section 914

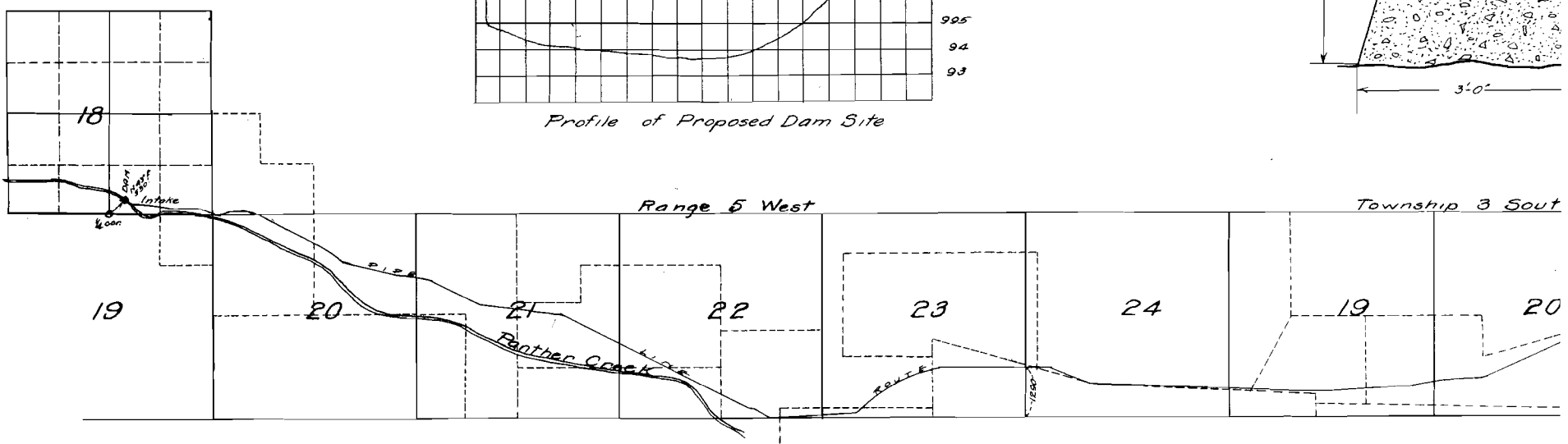
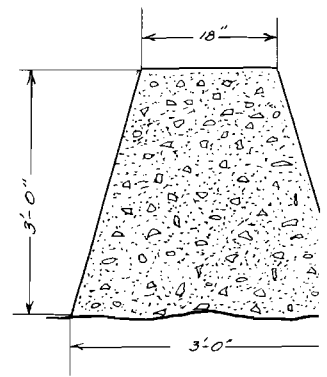
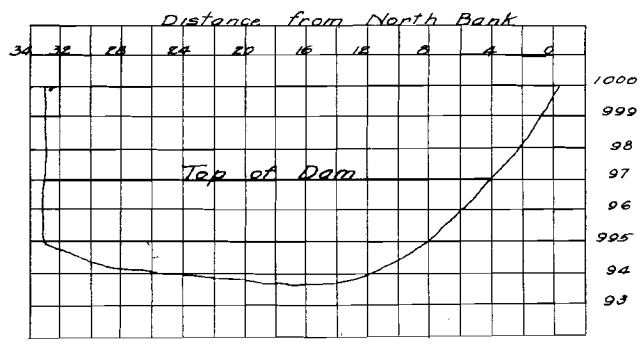

1007

1001

MAP OF
 V OF DAM SITE
 AND
 LINE ROUTE
 FOR
 CITY WATER WORKS
 Application for permit to appropriate

Nov. 1911.

Application No. 1609
 Permit No. 914

CERTIFICATE OF SURVEYOR

I, R.W. Jones of McMinville, Ore., do hereby certify that this map was made from notes taken during an actual survey made by me (and under my immediate supervision) on March 23, (and subsequent days) 1911, and that it correctly represents the works described in the accompanying application, together with the location of streams in the immediate vicinity.

R. W. Jones,
 SURVEYOR

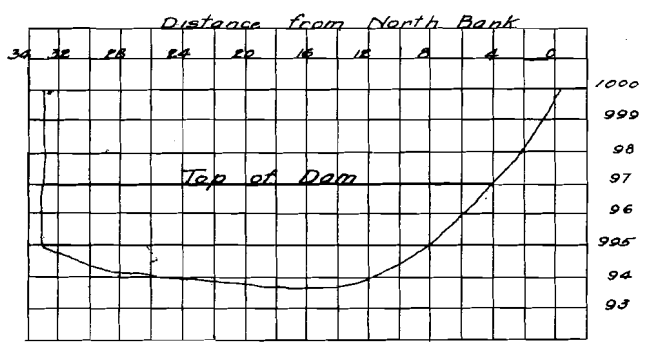

Profile of Proposed Dam Site

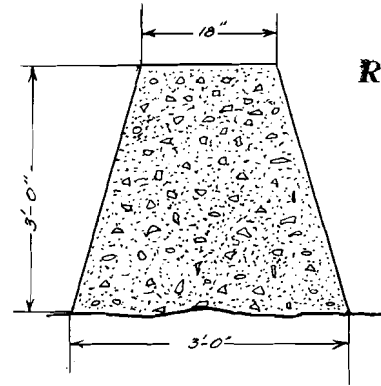

Application No. 1609
 Reservoir Permit No.

SECTION
 OF
 CONCRETE DAM
 SCALE 1/4" = 1'

OFFICE OF STATE ENGINEER
 BOOE ID
 NOV 17 1911

