

8

TOWNSHIP 34S, RANGE 6W, W. M.

North

Scale 1/8" = 1 Mi.

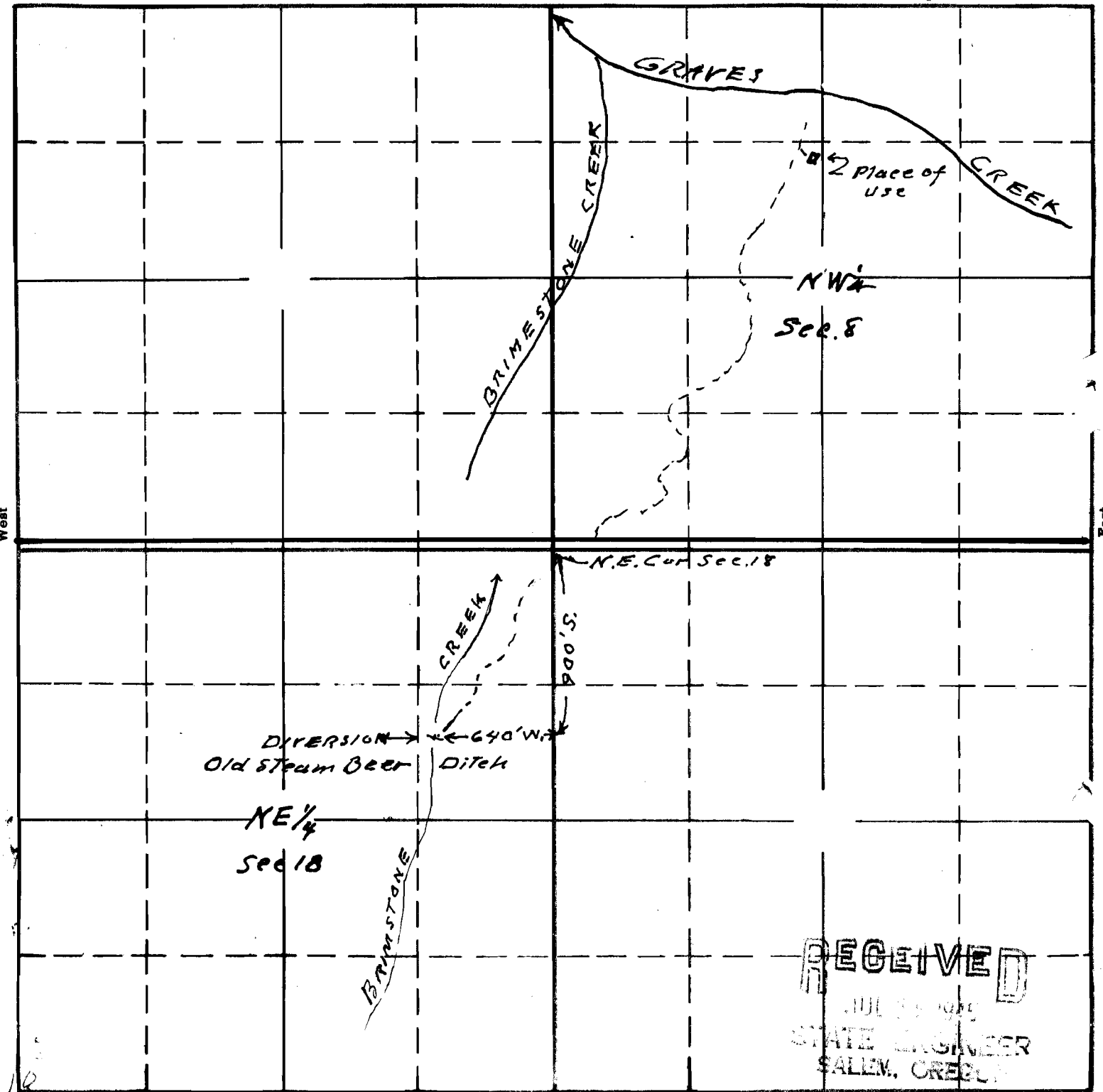

RECEIVED
 JUL 25 1945
 STATE ENGINEER
 SALEM, OREGON

20975
 15-48A

APPLICATION No. 20975
 PERMIT No. 16421

Map To accompany application of
 A Lespy for use of waters of
 Brimstone Creek for domestic & garden
 and fire protection

This office 7/11/45 [Signature]