

3331

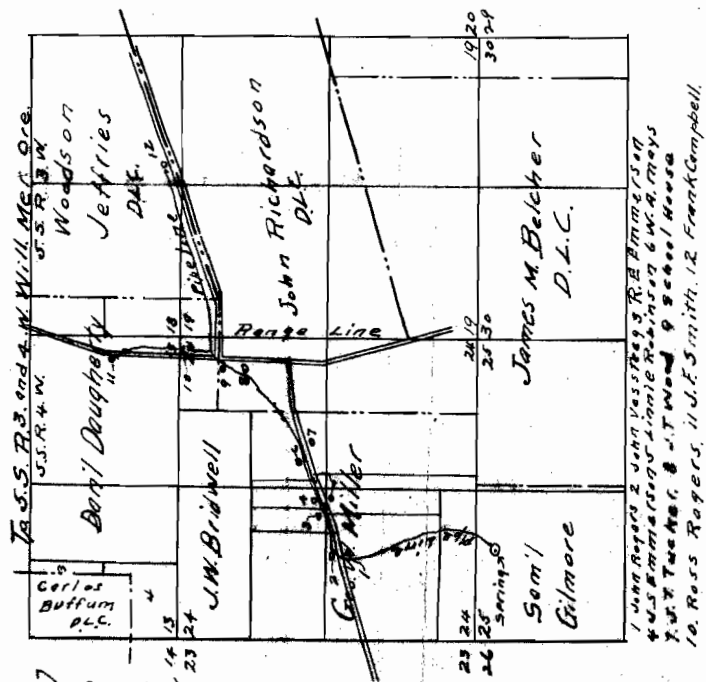

Application - Permit -
 Map to accompany application to appropriate the public waters of the State of Oregon Spring 15 354.6 feet South and 1066.7 feet West of the 1/4 Section Post between Sections 24 and 25 17 T. J. S. R. 4. W. Will. Mer. Yamhill County Ore.

Cross Section of Collecting Reservoir
 4 x 4 1/2 x 6 feet inside

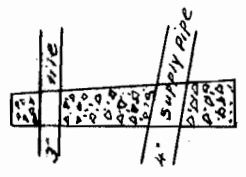
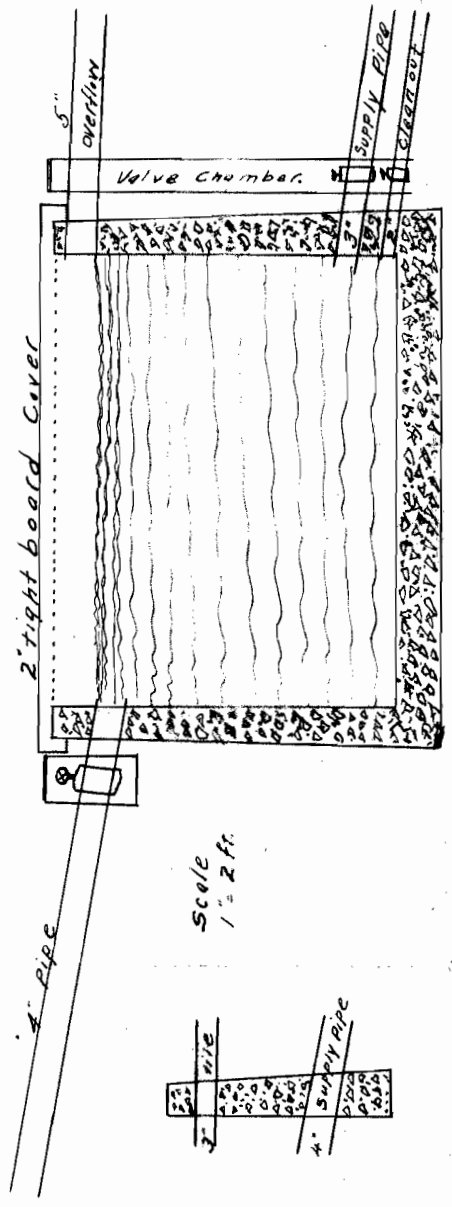

Scale 1" = 2 ft.

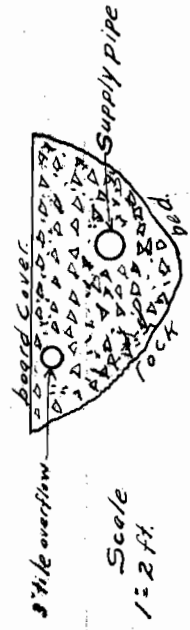

Scale 1" = 2 ft.

Concrete dam to be built around Spring
 With board cover. Dam to be from 1 1/2 to 3 feet outside buried

Certificate of Surveyor.

DEC 3 1913
 SALEM, OREGON.

I, H. W. Herring of McMinnville Oregon do hereby certify that this map was made from notes taken during an actual survey made by me on December 3 1913 and that it correctly represents the same.

3331

3331