

T. 38 S., R. 8 W., W. M.  
 Scale 4" = 1 Mile. July 1947

Deer Creek Ranch

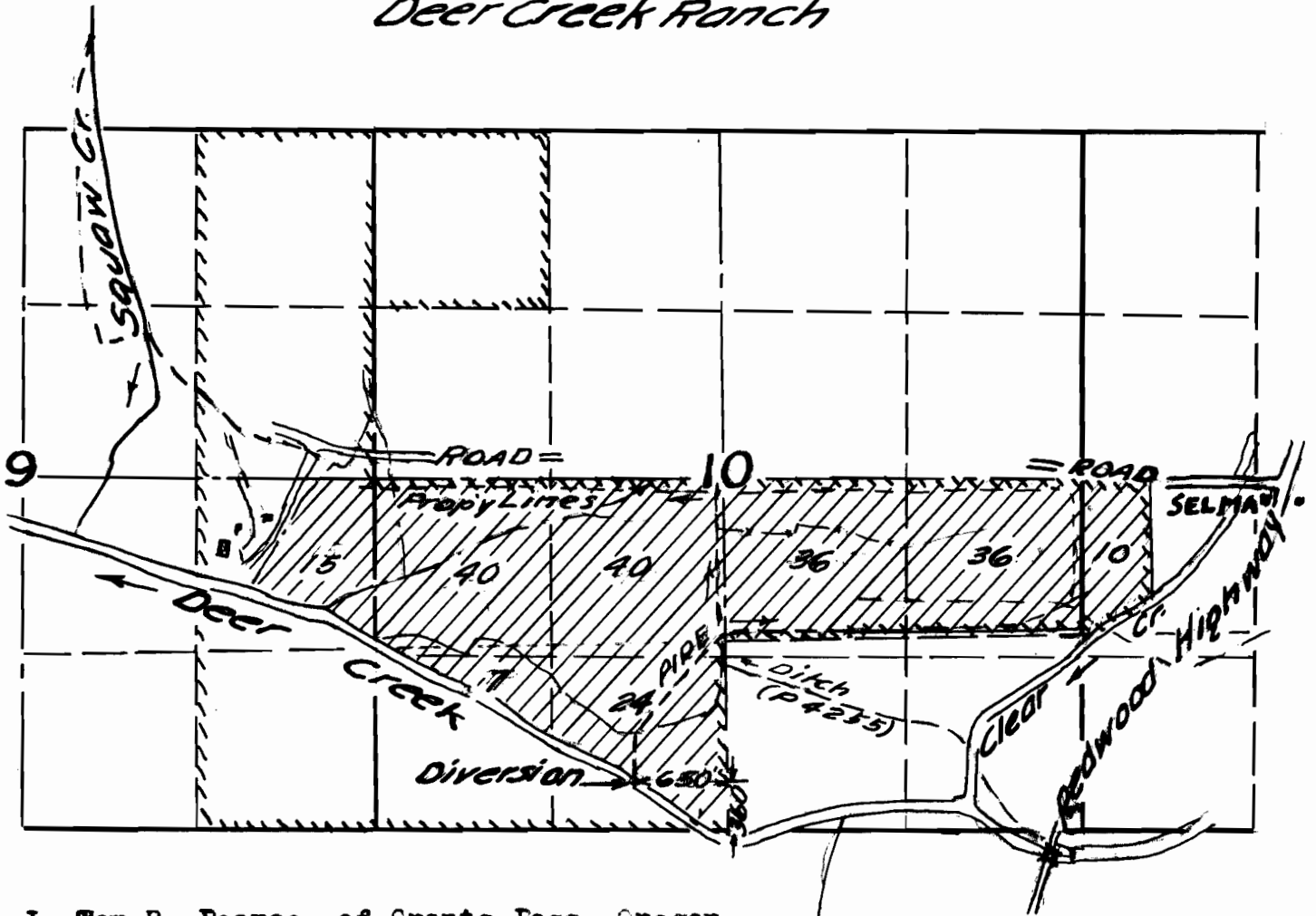

I, Tom R. Pearce, of Grants Pass, Oregon do hereby certify that this map was made from notes taken during an actual survey made by me on August 5, 1947; that the monument shown on this map consisting of 2" pipe and foundation structures is 360 feet North and 650 feet West from the South Quarter corner of Section 10 T38 South R8 West Willamette Meridian.

22760  
 15-56-

RECEIVED

STATE ENGINEER  
 OREGON

Application No. 22760  
 Permit No. 17867

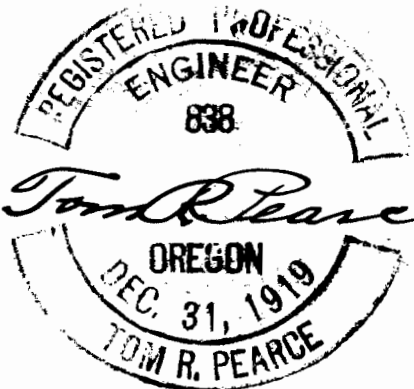

J. H. Fomeroy

Application No.  
 Permit No.