

20234-880
2466

OFFICE OF STATE ENGINEER
FEECE AND
OCT 18 1911
SALES & EXCH

Application No. 1738
Permit No. 880

PLAT
OF
ACERAGE IRRIGATED BY
Osburn Ditch
Accompanying Application #1738
Scale: 1" = 40 cts.

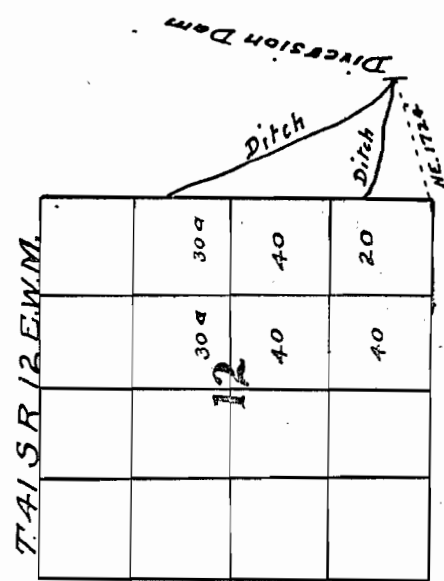

West Rv. Music