

MAP

Accompanying application for permit
to appropriate water

Scale: 2 in. = 1 mi. May 1926

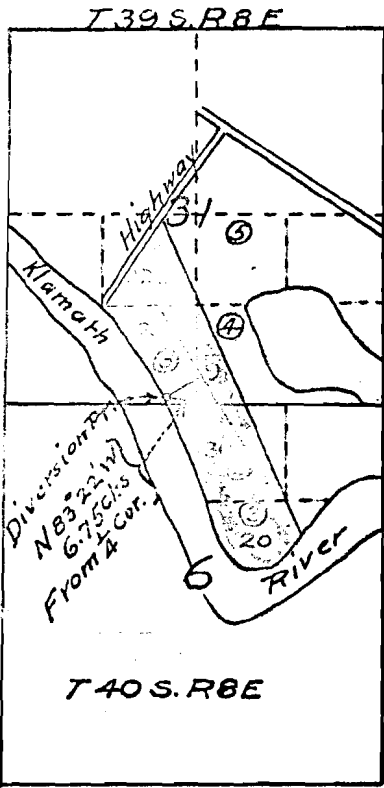

I, Don J. Zumwalt, of Klamath Falls, Oregon,
do hereby certify that this map was made from notes
taken during an actual survey made by me on April
26, 1926, and that it correctly represents the works
described in the accompanying application, together
with the location of streams and other ditches
in the immediate vicinity.

Don J. Zumwalt.

Registered Professional Eng.
Oregon No. 238
Reg. Dec. 8, 1919

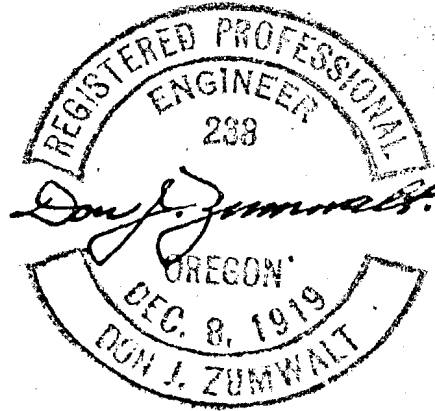

Application No. 10844
Permit No. 8307

Klamath River

10844

10844