

SEC. 11 T 27 S., R 3 W W.M.

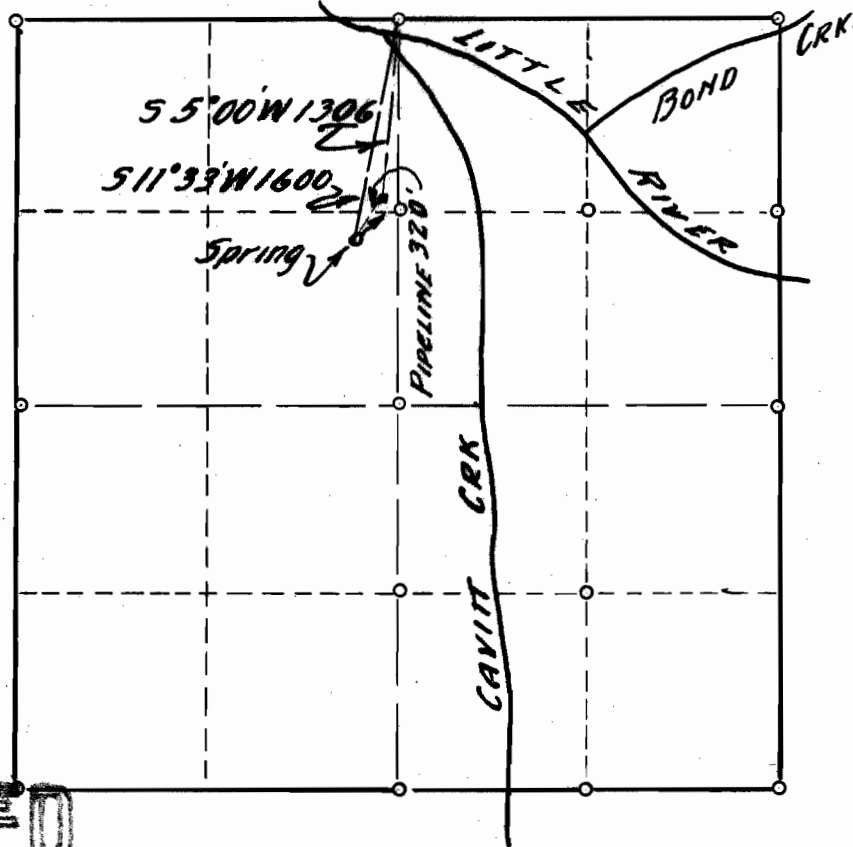

SCALE  
4" = 1 mile.

**RECEIVED**

JUN 25 1945

STATE ENGINEER  
SALEM, OREGON

DOMESTIC WATER SYSTEM  
J. F. SOWERS  
GLIDE OREGON

COUNTY SURVEYOR'S OFFICE  
DOUGLAS COUNTY OREGON

I, BEN. B. IRVING of ROSEBURG, OREGON, do hereby Certify that this map was made from notes taken during an actual survey made by me on APRIL 26 1945 and that it correctly represents the works described in the accompanying application together with the location of streams and other ditches in the immediate vicinity

*Ben B. Irving*

REGISTERED PROFESSIONAL  
ENGINEER.

20919  
16-28A

OREGON No. 240  
Nov. 8, 1919

Application No. 20919  
Permit No. 16383