

Map accompanying application of Elsie O. Waters, for permit to appropriate water, in West 1/2 of S.E. 1/4 of section 33, Tp. 8 S. Range 25 E. - W.M.

RECORDED
JAN 18 1914
SALEM, OREGON,

APPROVED
1864

I, H. F. C. Haldtmann, of Fossil, Oregon do hereby certify that this map was made from notes taken during an actual survey made by me on September 16th-17-1911 and December 8th 1913, and that it correctly represents the works described in accompanying application, together with the location of streams and other ditches in the immediate vicinity, and has written thereon the area in each smallest subdivision which it is proposed to irrigate.

H. F. C. Haldtmann,
Surveyor.

Spray Ditch Company Flumes

John Day River

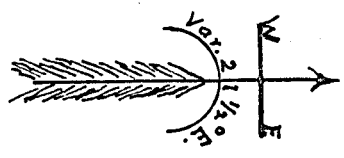
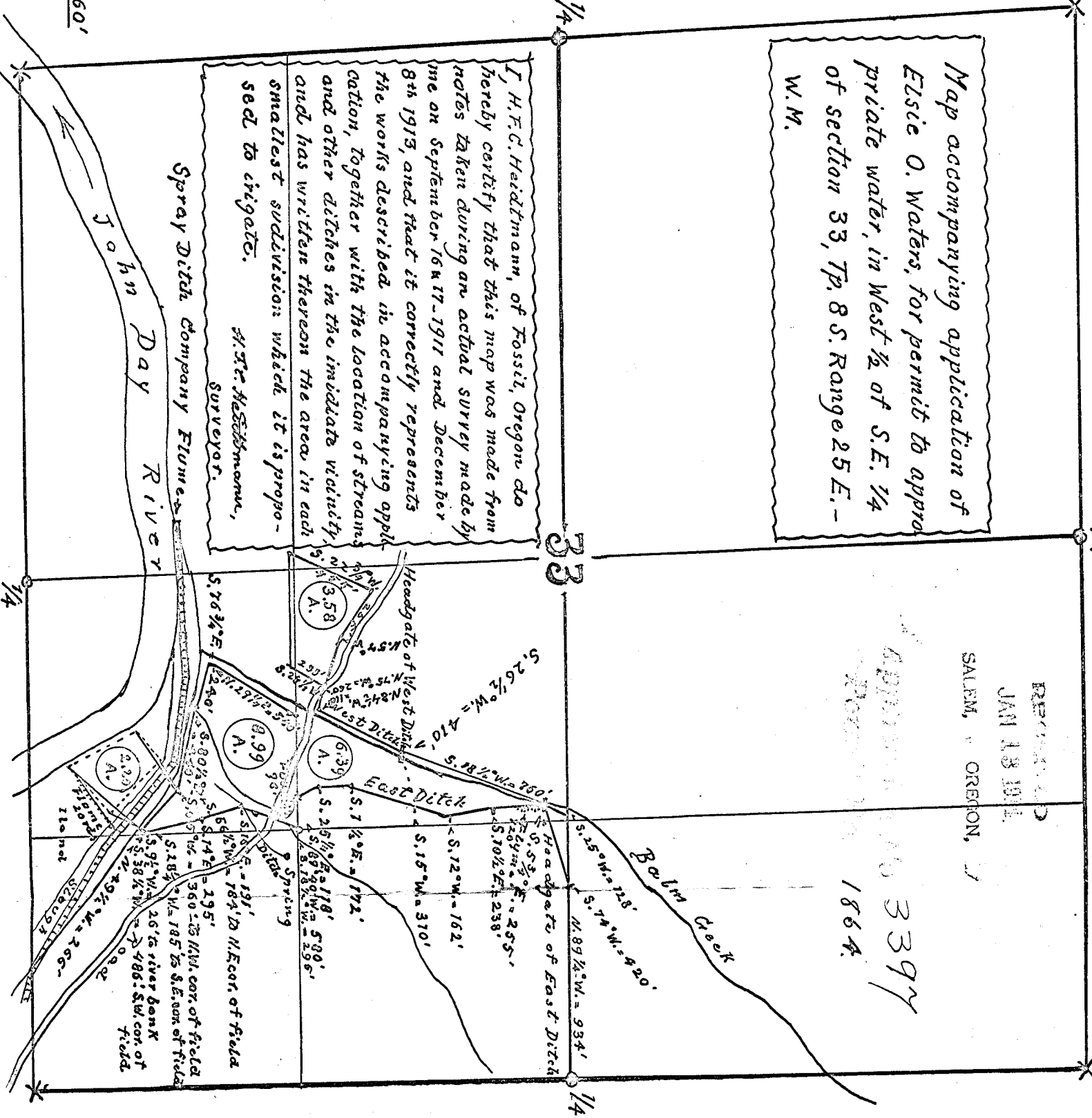

Scale - 1" = 660'