

Section 20 Tp. 1 S. Range 25 E.W.M.

2673
2154

Morrow County, Oregon.

Map Showing Land of Lawrence A. Palmer

to be irrigated under this permit.

Scale, 1 inch = 10 chains.

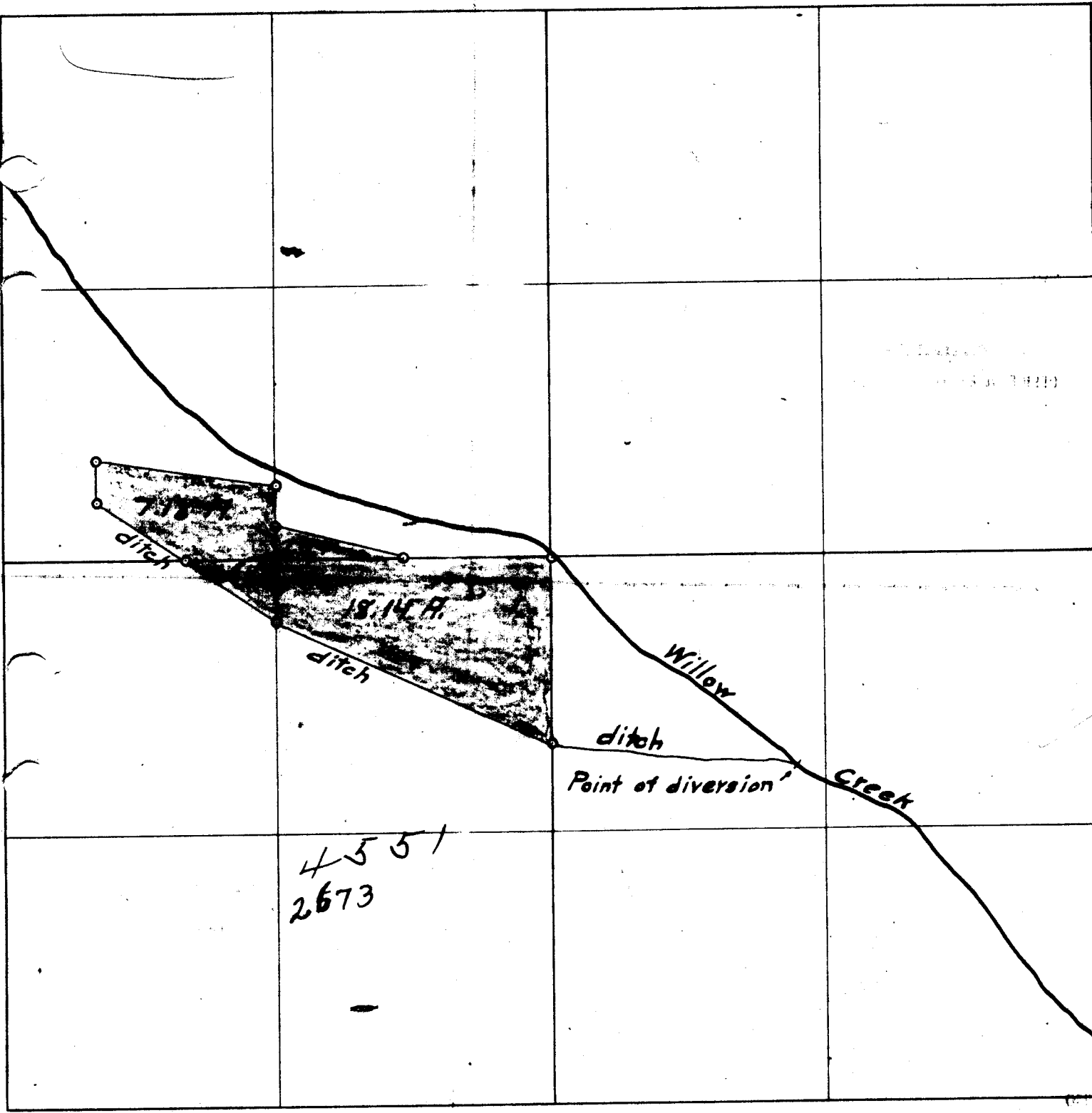

I, Loy M. Turner of Morrow Co., Oregon do hereby certify that this map was made from notes taken during an actual survey made under my supervision, on