

R33 E.W.M.

R34 W.M.

10
X

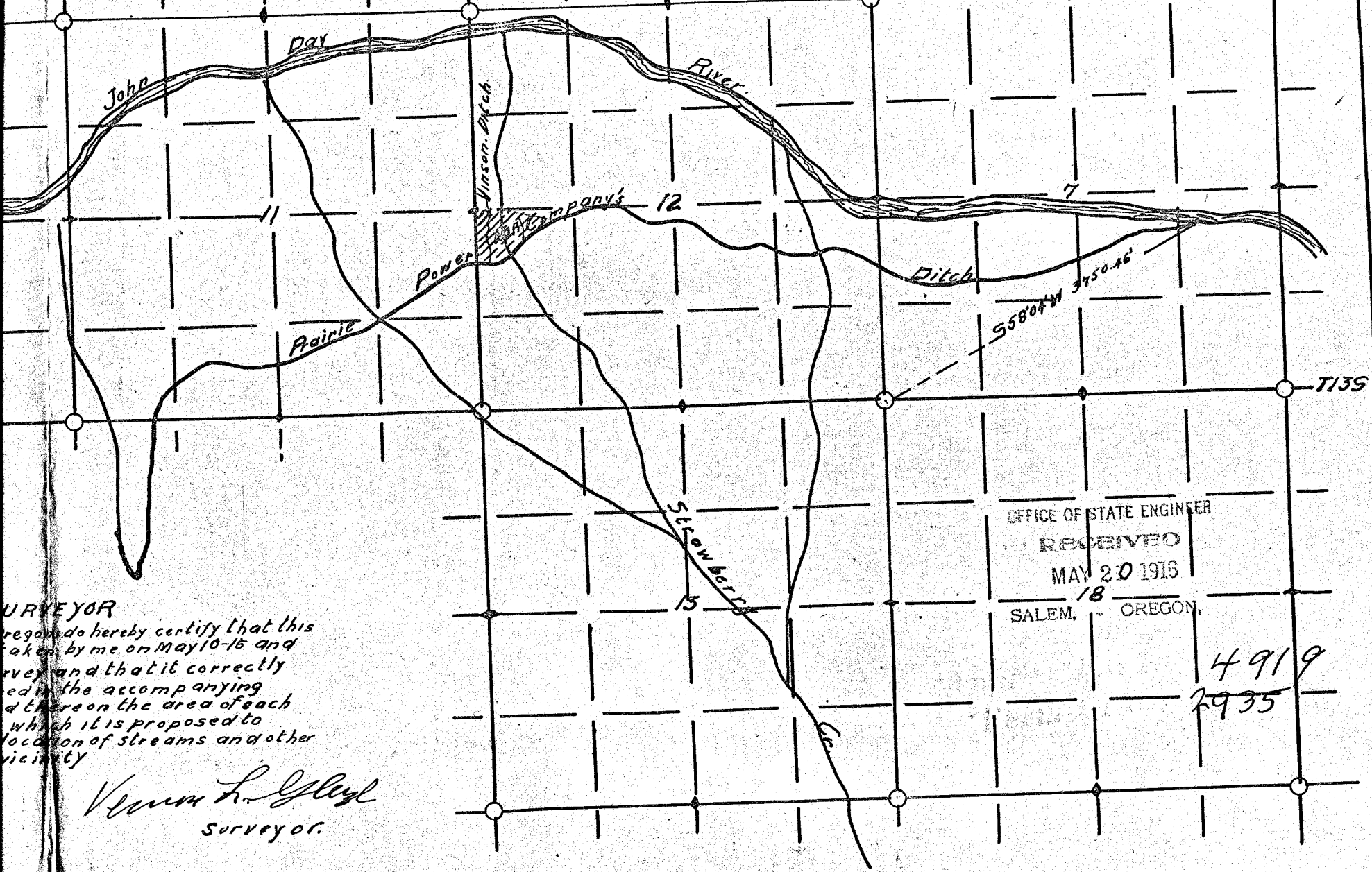

SURVEYOR
 I do hereby certify that this
 survey was taken by me on May 10-15 and
 that it correctly
 shows the location of each
 stream and other
 features on the area of each
 section which it is proposed to
 locate.

Vernon L. Gleyd
 Surveyor.

OFFICE OF STATE ENGINEER
 RECEIVED
 MAY 20 1916
 18
 SALEM, OREGON.

4919
~~2935~~

7010

2935
 2158

R33 E.W.M.

R34 W.M.

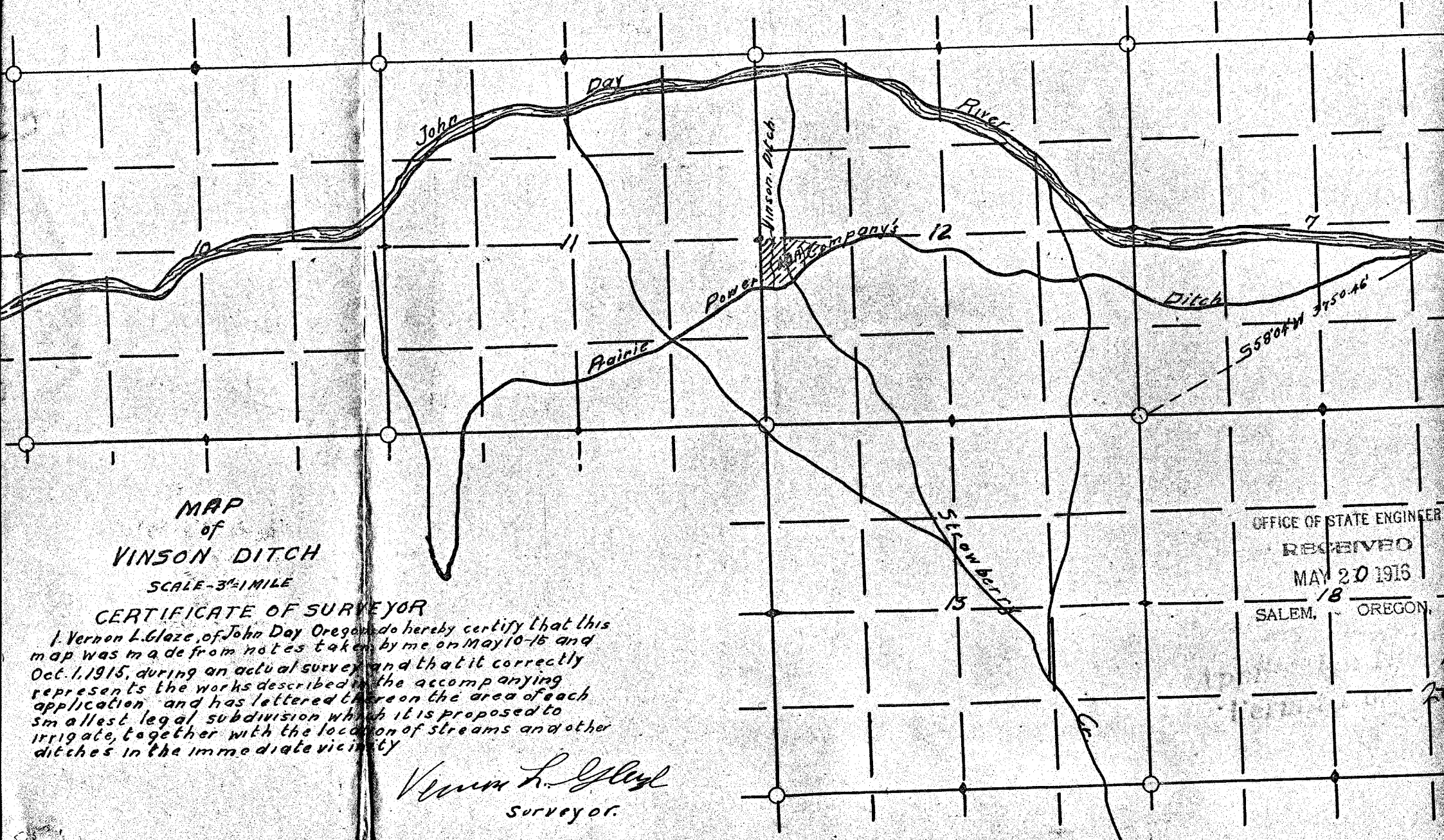

MAP
of
VINSON DITCH

SCALE - 3/4 MILE

CERTIFICATE OF SURVEYOR

I, Vernon L. Glaze, of John Day Oregon do hereby certify that this map was made from notes taken by me on May 10-15 and Oct. 1, 1915, during an actual survey and that it correctly represents the works described in the accompanying application and has lettered thereon the area of each smallest legal subdivision which it is proposed to irrigate, together with the location of streams and other ditches in the immediate vicinity.

Vernon L. Glaze
Surveyor.

OFFICE OF STATE ENGINEER
RECEIVED
MAY 20 1916
18
SALEM, OREGON.

70