

LOT 4

22202  
1948

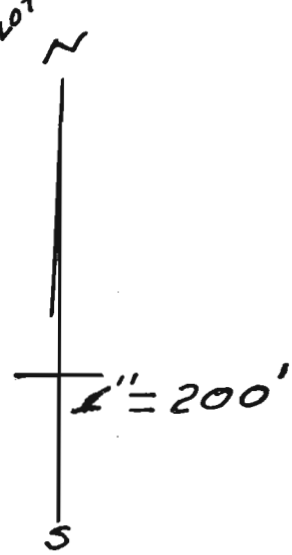

I, A. M. GOULD, OF COQUILLE, OREGON, DO HEREBY CERTIFY THAT THIS MAP WAS MADE FROM NOTES TAKEN DURING AN ACTUAL SURVEY MADE BY ME ON JANUARY 22, 1947 AND THAT IT CORRECTLY REPRESENTS THE WORKS DESCRIBED IN THE ACCOMPANYING APPLICATION TOGETHER WITH THE LOCATION OF THE STREAMS IN THE VICINITY

*A. M. Gould*

NO. 1127 JANUARY 21, 1920