

OFFICE OF STATE ENGINEER

RECEIVED

AUG 30 1921

SALEM, OREGON

MAP

of Section 26 and 27 T. 25 S. R. 12 W. M. Coos Co. Ore.  
To Accompany Application for Permit  
To appropriate water  
by  
School District #36 Coos County Ore  
(Coos River Consolidated)

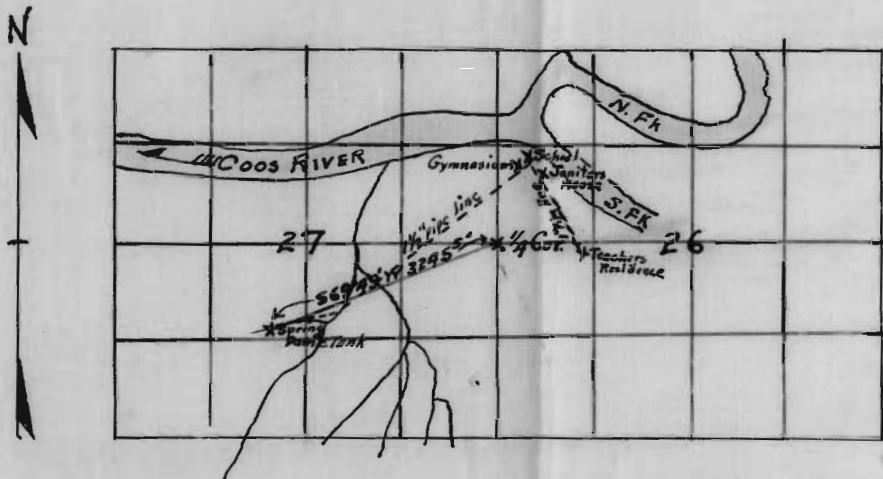

I, D. L. Buckingham, of Marshfield, Coos County Ore.  
do hereby certify that this map was made from notes taken by me  
during an actual survey made Aug 25, 1921 and that it correctly represents  
the works described in the accompanying application together with the  
location of streams, intake and terminals of the system

D. L. Buckingham

Application No. 8068  
Permit No. 5210

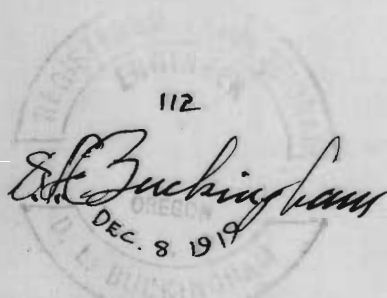

2222