

777

R 877

T. 135.

R 877

Application No. 5844
 Permit No. 3596

R.26E.

W.R. Mascoll, Dayville, Ore.
 Appropriator.

08-10

Scale 6"=1 Mi.

PLAT of BOB'S DITCH

Nov. 14, 1917.

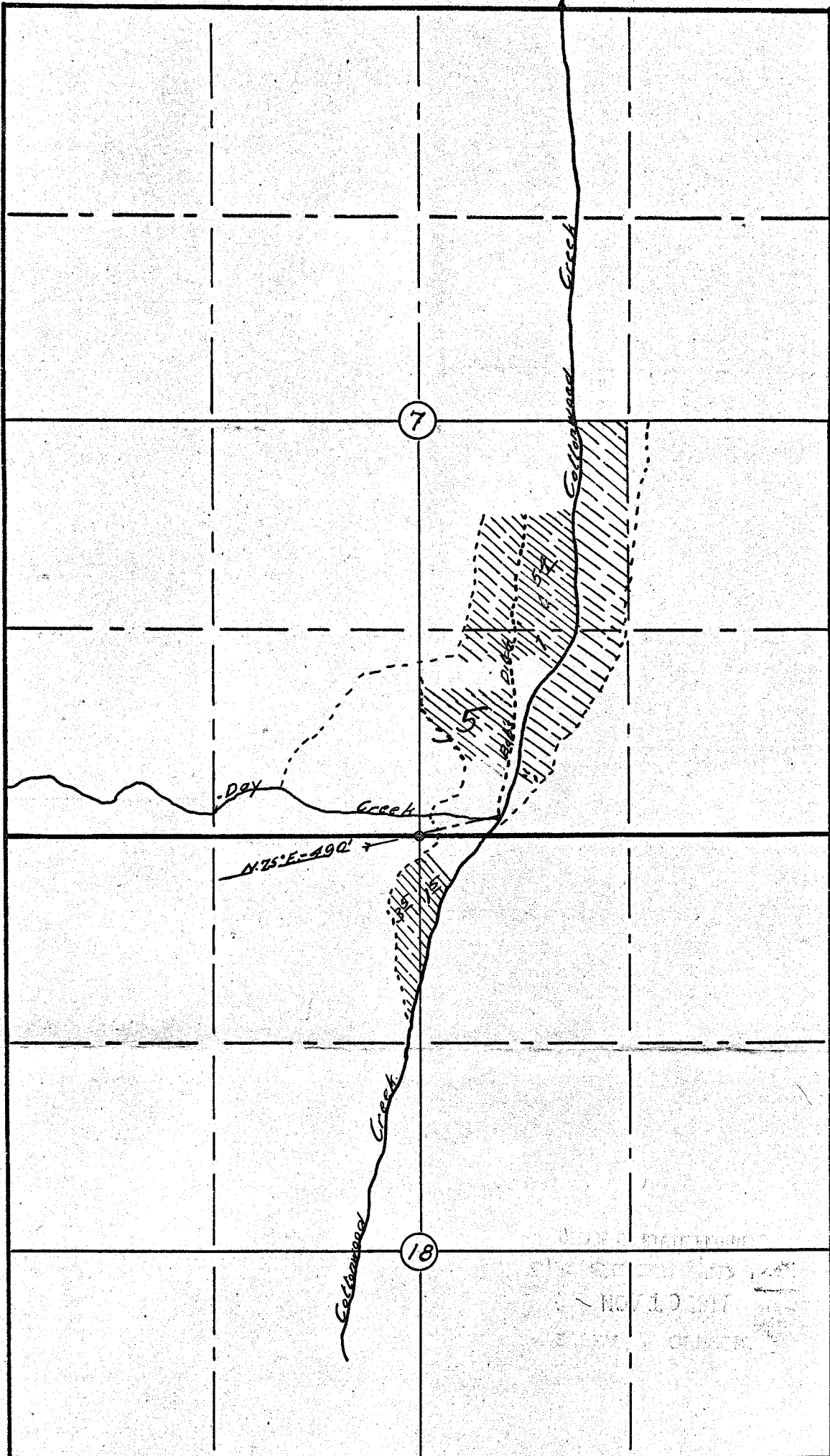

2877

T. 155.

2877

2877

PLAT
NO. 10107
STATE OF MISSOURI