

Range 26 E.W.M.

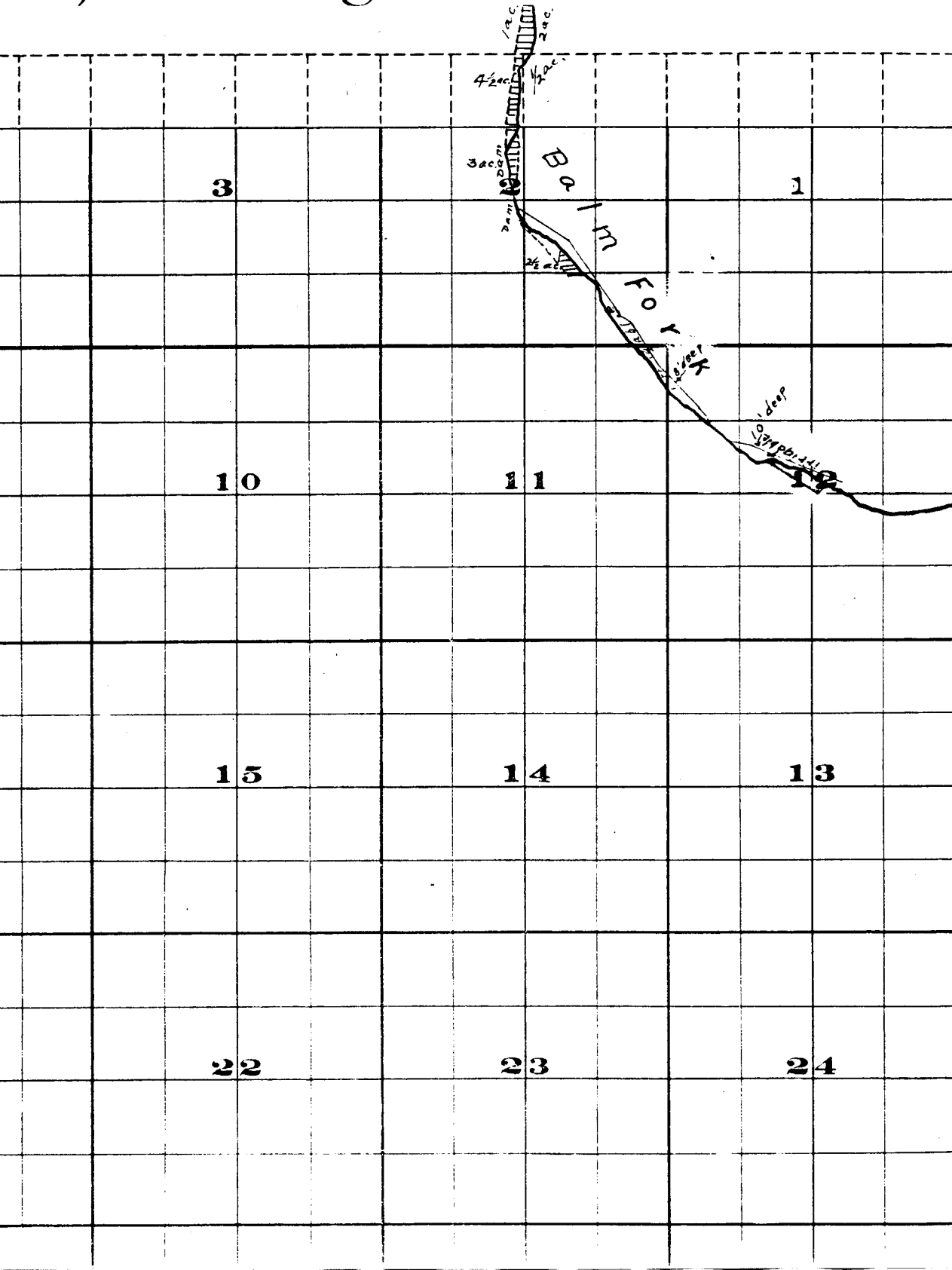

Township 3. S. , R

	6			5				4		3
	7			8				9		10
	18			17				16		15
	19			20				21		22
	30			29				28		27

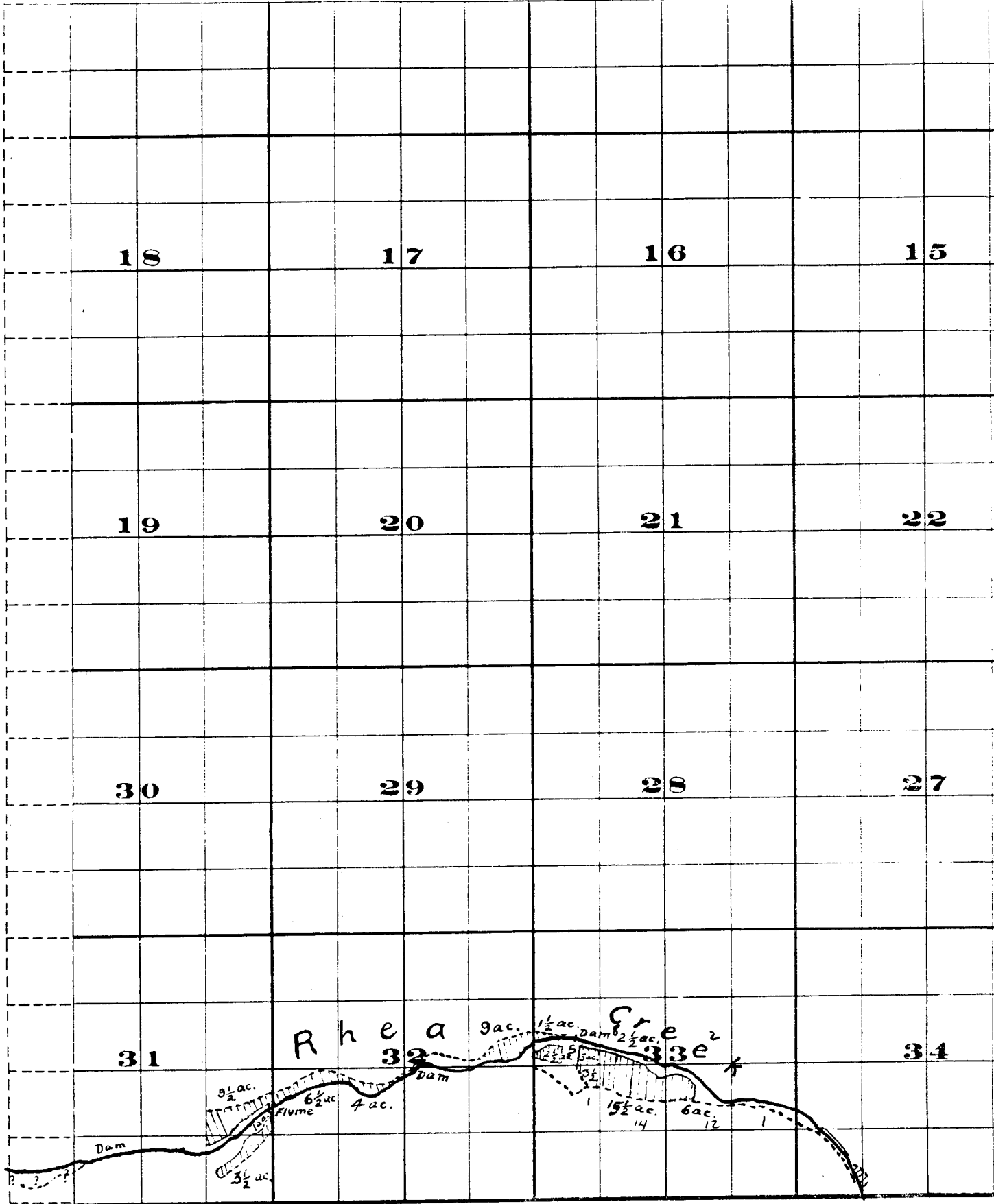

THE S. A. BRISTOL CO. PRINTERS & BOUNDINGERS CHELSEA, N.Y.

Surveyed by H. K. Donnelly July 1909

John H. Lewis - State Engineer

Examined - July 14, 1909.

	<b>15</b>			<b>14</b>				<b>13</b>	
	<b>22</b>			<b>23</b>				<b>24</b>	
	<b>27</b>			<b>26</b>				<b>25</b>	
	<b>34</b>			<b>35</b>				<b>36</b>	

FROM OFFICE OF THE STATE ENGINEER, SALEM, OREGON

*Willow Creek Adjudication*

3 S. 26 E.

, Range 25 E.W.M. .

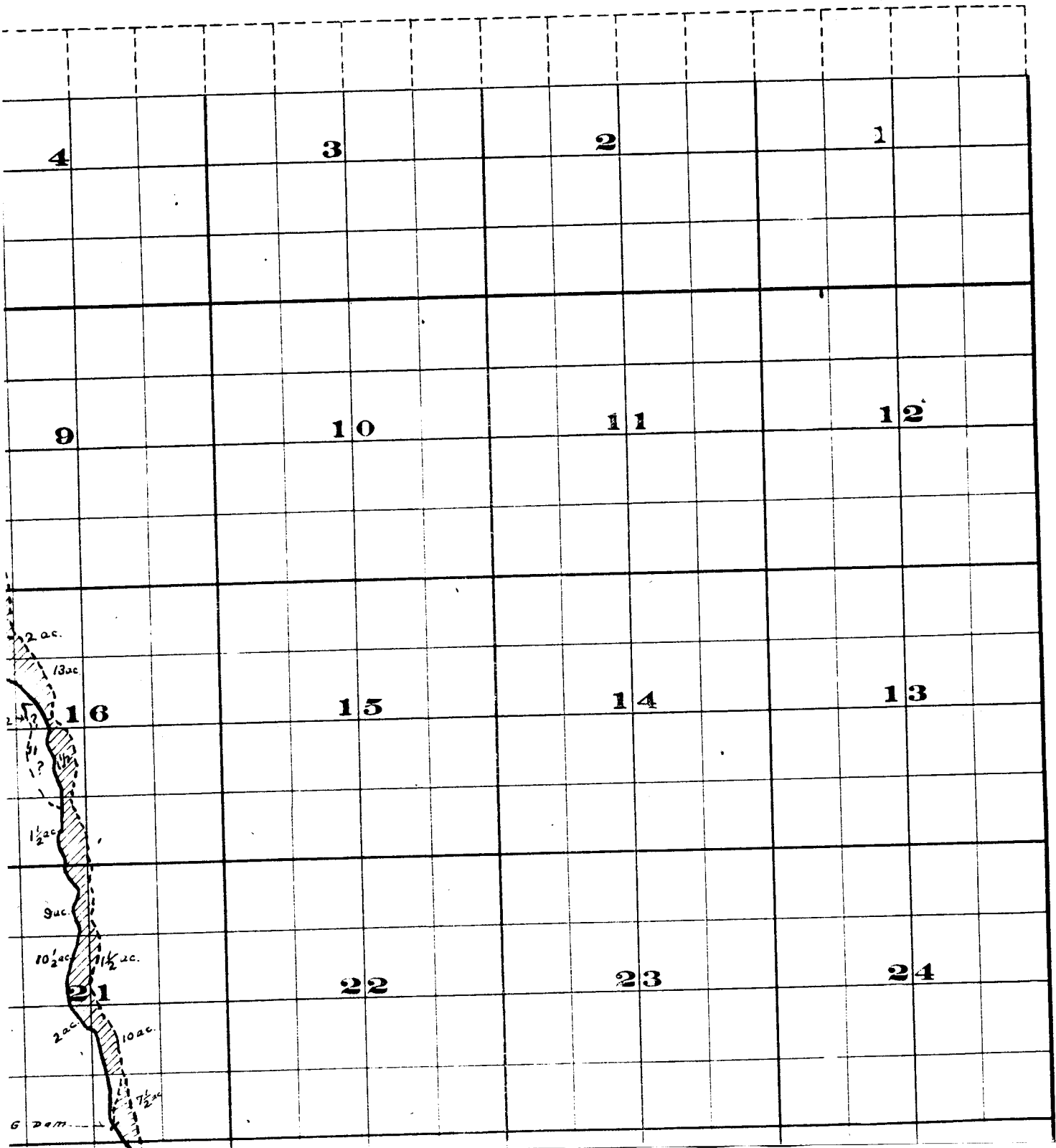

# Township 3 S.

, R. 1

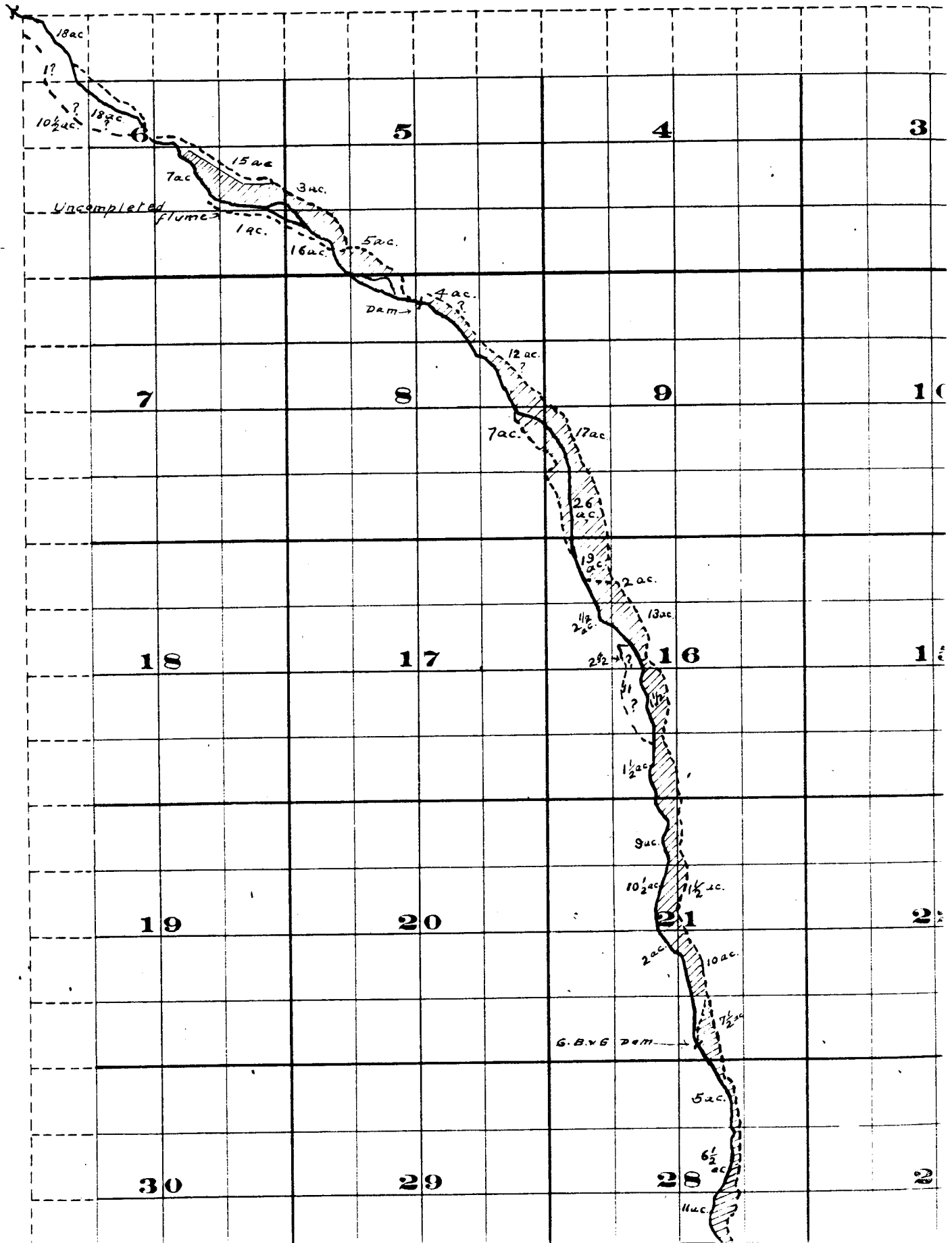

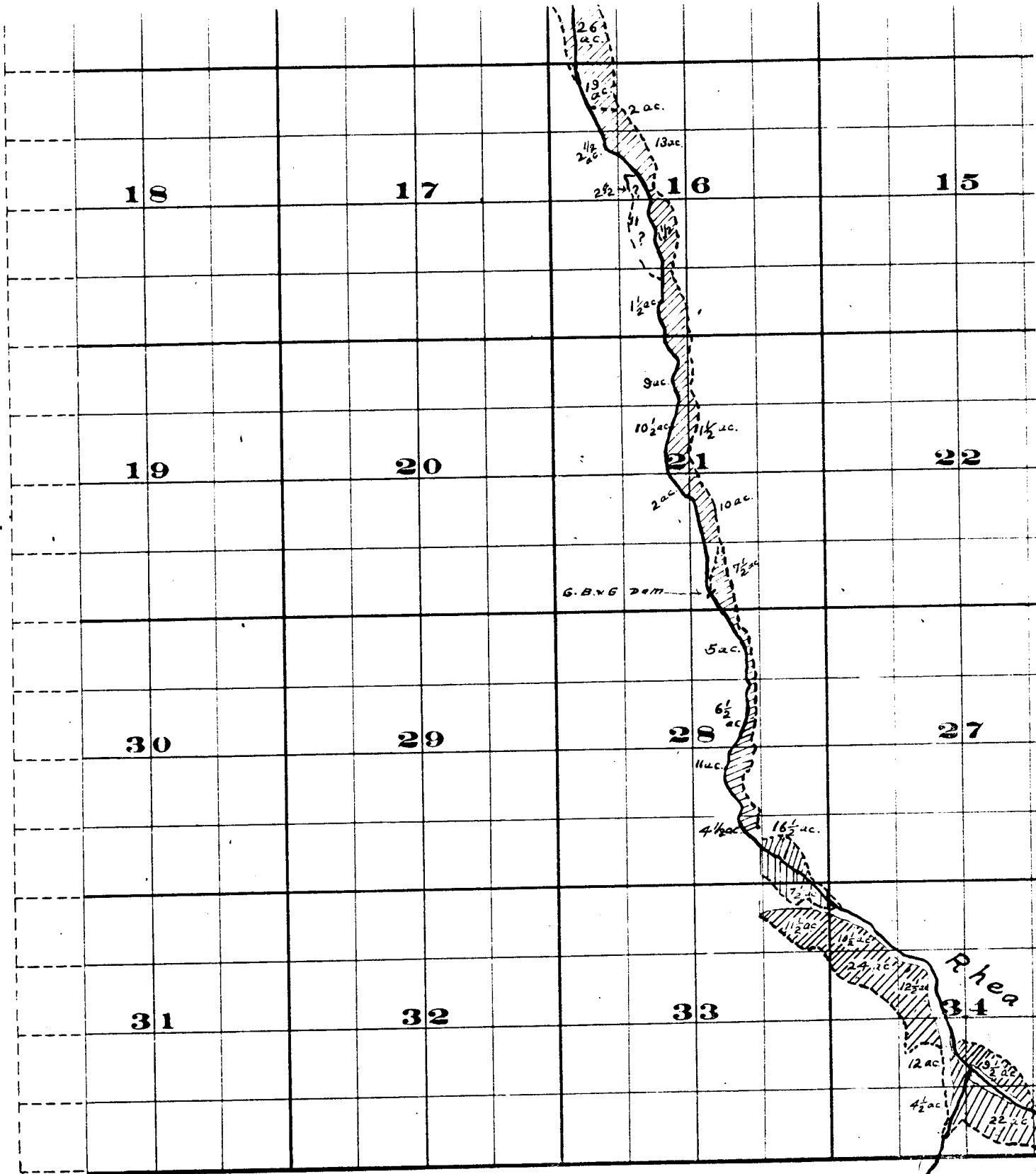

THE S. BRISTOL CO. PRINTERS & BOOK-BINDERS PITTSBURGH, PA.

S. 28 - North Surveyed by R. D. Cooper July  
 S. 33 - South Surveyed by H. K. Donnelly July  
 John H. Lewis - State Engineer  
 Examined July 14, 1909.

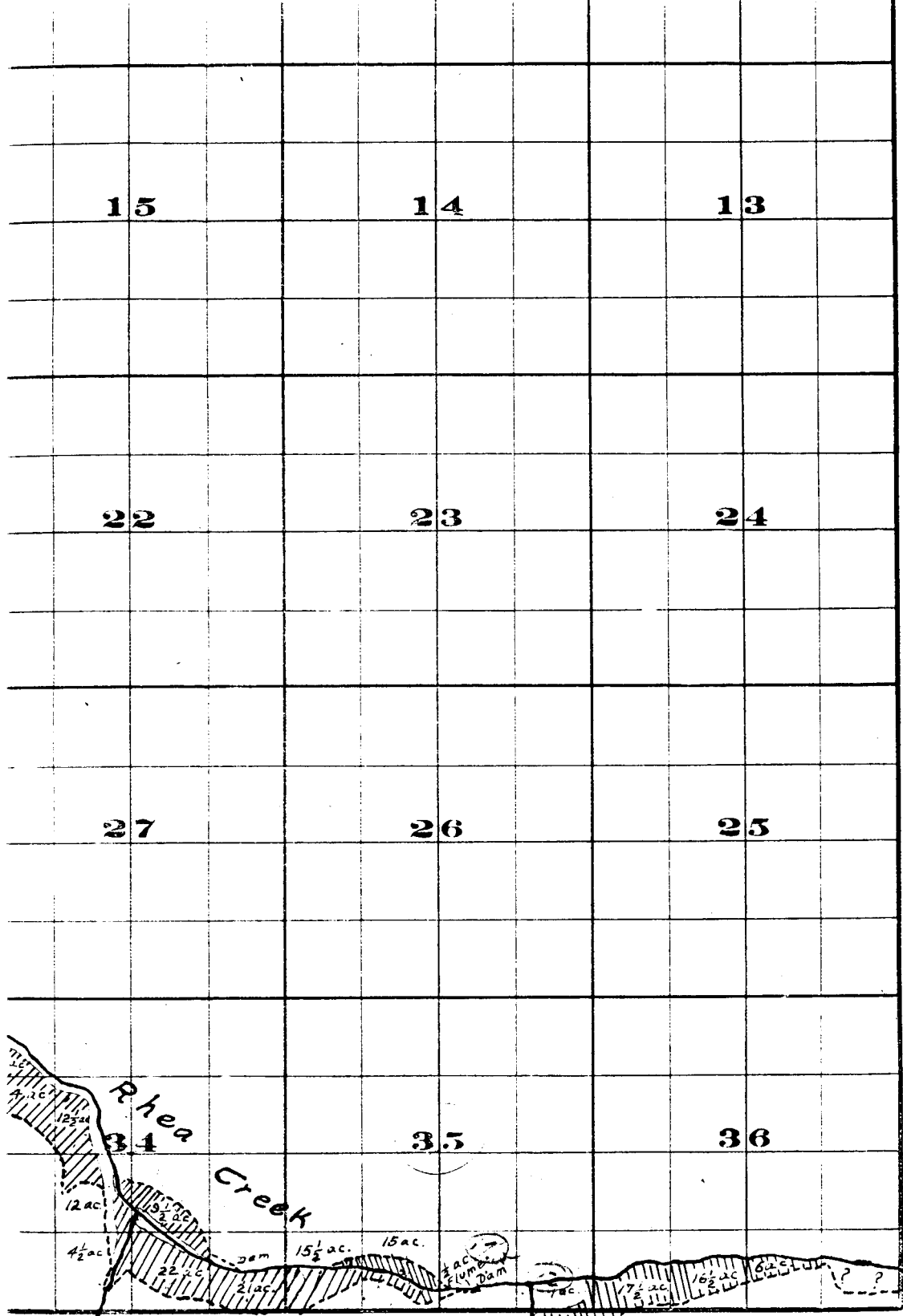

FROM OFFICE OF THE STATE ENGINEER, SALEM, OREGON

July 1909

July 1909

Willow Creek Adjudication

3 S. 25 E.

Part 4 S. 25 E.