

Gene Weitman
Application No. 22188
Permit No. 17472
Priority - January 15, 1947
Find in Rogue River ~~Miss.~~,
Vol. 1

Note: The accompanying
reservoir application for
permit was abandoned.

CERT. # 22458

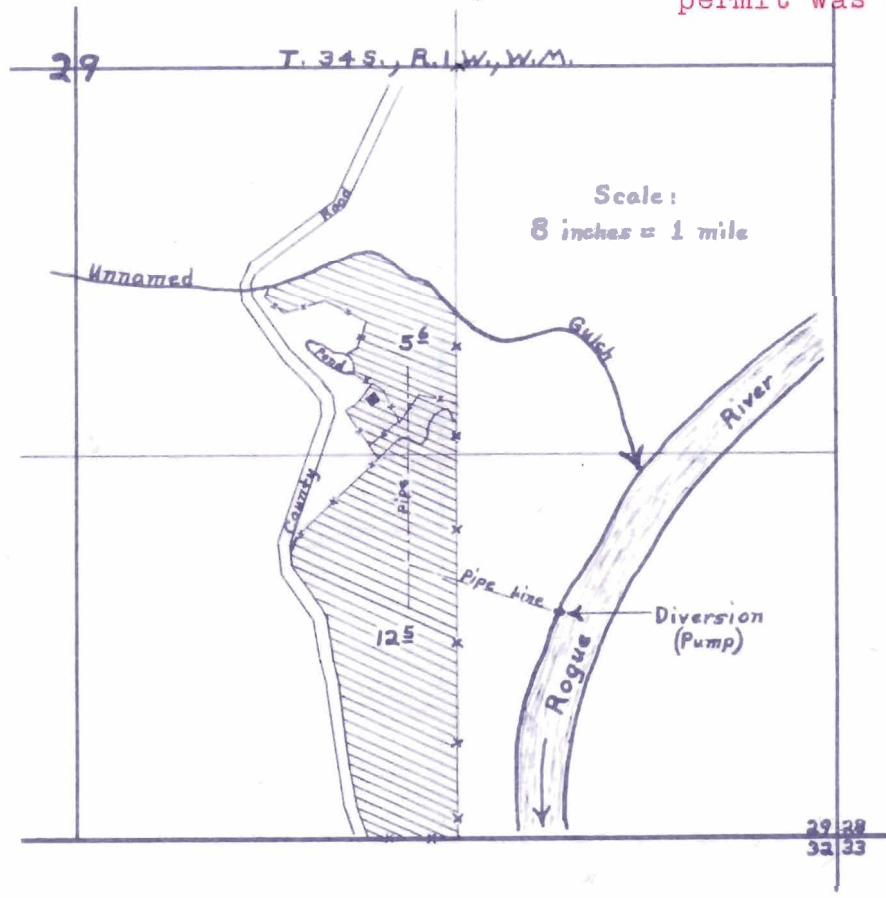

FINAL PROOF SURVEY UNDER

Application No. 22188 ... Permit No. 17472
IN NAME OF

Gene Weitman

Surveyed Jan. 4... 1957., by D.C. Hendrix, W.M.