

Map accompanying application, by Wills Bros. Shingle Mill Co., Mill City, Oregon, for a permit to divert water from North Santiam River for log pondage purpose. The point of water diversion is located in the SE⁴ of SW⁴ of Sec. 29, T. 9 S. R. 3 E. W. M., Marion Co., Oregon.

← NORTH SANTIAM RIVER
Point of diversion → ← Pump
South Bank of River

Discharge pipe →

RR. Right of Way

N. 56° 36' E.

↑
Scale 1" = 100 Feet.

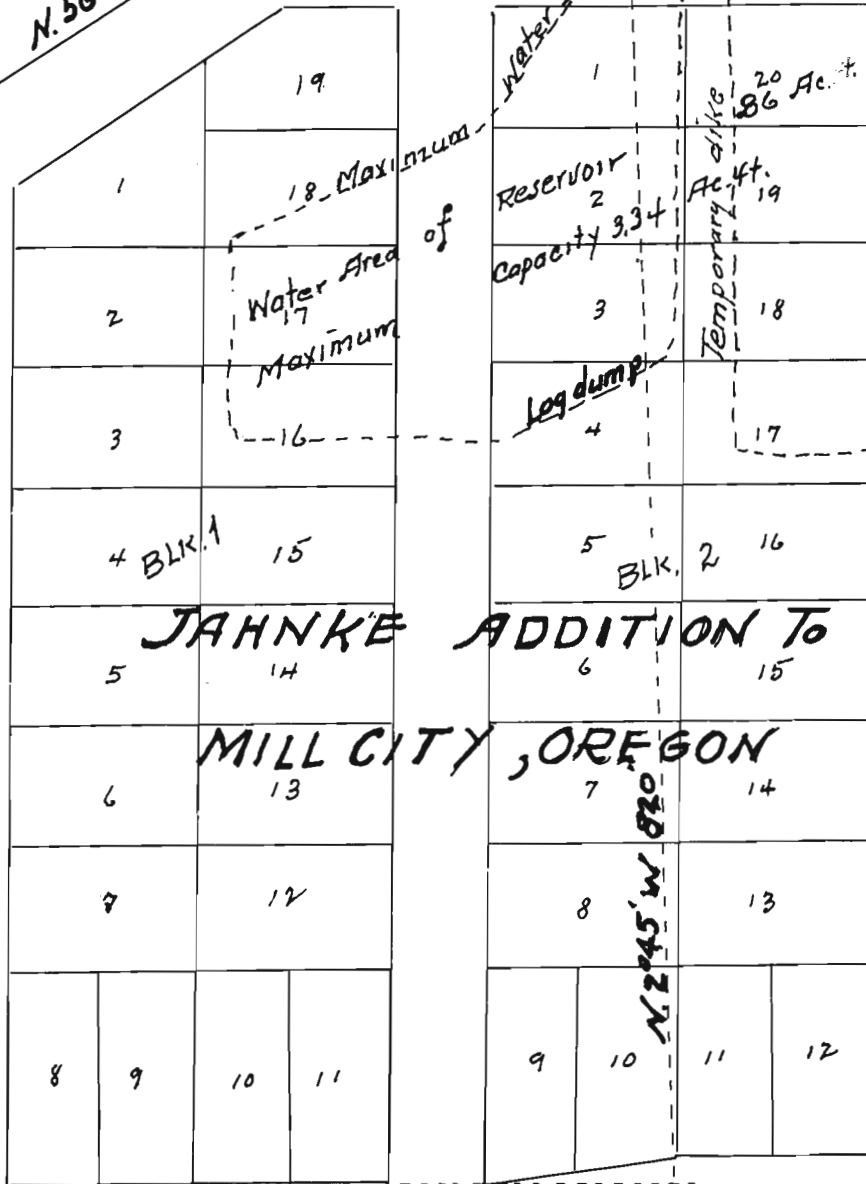

I, hereby certify, that I have made this map from notes of a field survey made by me and data taken from an authentic map of JAHNKE ADDITION TO MILL CITY, OREGON, and that it reasonably represents the location of and dimensions of the project features pertinent to the application for water diversion.

Signed: *C. T. Orley*
Application No. R-29214-29215
Permit No. 1649

South 1/4 Cor. of Sec. 29, T. 9, S. R. 3 E. W. M.

R-29214
29215