

RECEIVED
 SEP 1 1953
 STATE ENGINEER
 SALEM, OREGON

SE 1/4 of NE 1/4 Section 26
 T4S R3E WM

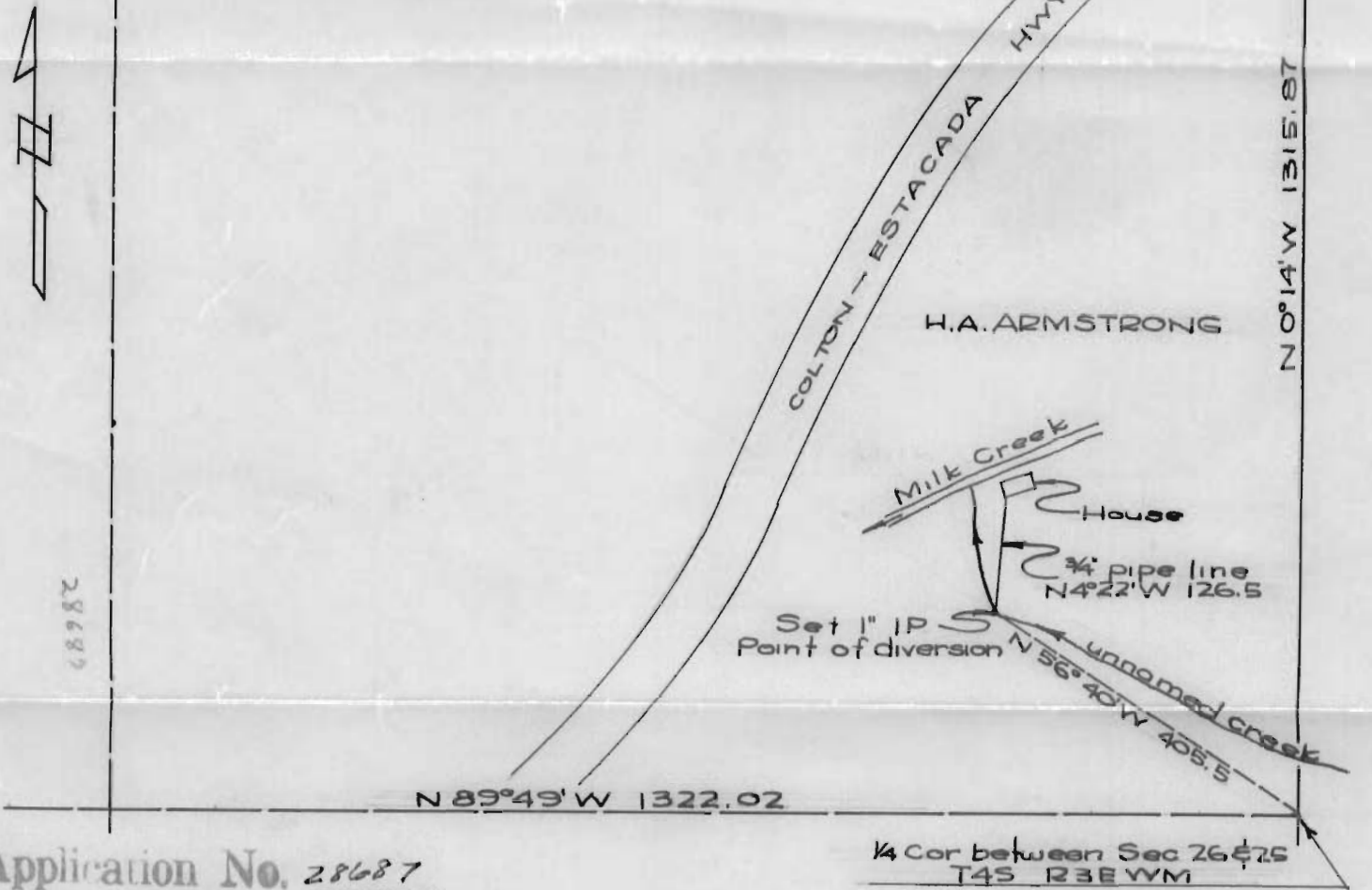

Application No. 28687
 Permit No. 22588

WATER RIGHT MAP FOR H.A. ARMSTRONG
SECTION 26 T4S R3E WM
CLACKAMAS COUNTY, OREGON
 July 1953
 Scale ~ 1" = 200'

I, Edward A. Armstrong of Eugene, Oregon do hereby certify that this map was made from notes taken during an actual survey made by me on July 18, 1953; that the monument shown for the point of diversion consisting of a one inch pipe 36 inches long is North 56°40' West 405.5 feet from the one quarter corner between Sections 26 & 25 in Township 4 South Range 3 East of the Willamette Meridian.

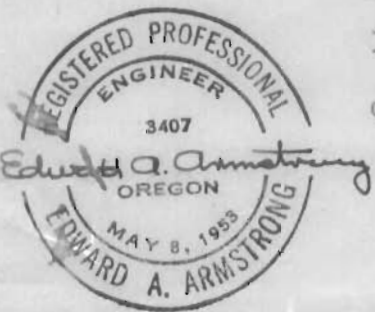

Edward A. Armstrong