

MAP  
OF

INTAKE LOCATION.

Field Notes of Traverse.

CITY OF CORVALLIS,  
ORE.

T. 12 S. - R. 6 & 7 W. W.M.

R.A. Lockwood - Eng. - March 5, 1912.  
Scale 1 1/2" = 40 Chs.

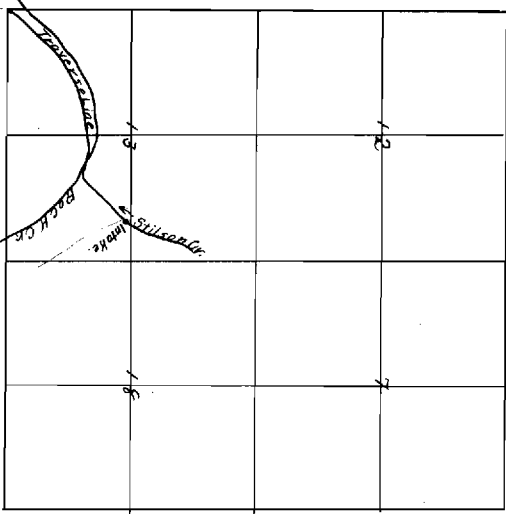

| Sta   | 0-1       | 1-2       | 2-3       | 3-4       | 4-5       | 5-6         | 6-7       | 7-8       | 8-9       | 9-10      | 10-11     | 11-12     | 12-13     | 13-14     | 14-15     | 15-16                     |
|-------|-----------|-----------|-----------|-----------|-----------|-------------|-----------|-----------|-----------|-----------|-----------|-----------|-----------|-----------|-----------|---------------------------|
| Angle | N44°02'E. | N43°43'E. | N51°14'E. | N40°22'E. | N34°32'E. | N44°04'9"E. | N60°12'E. | N36°18'E. | N74°19'E. | S73°06'E. | N80°54'E. | N71°03'E. | N89°22'E. | S69°16'E. | N63°33'E. | S10°45'E.                 |
| Dist. | 1350 FT.  | 304.5 "   | 260.0 "   | 552.4 "   | 158.0 "   | 344.7 "     | 155.3 "   | 193.1 "   | 230.2 "   | 461.2 "   | 513.3 "   | 274.0 "   | 178.5 "   | 408.9 "   | 248.8 "   | 199.0 "                   |
| Notes |           |           |           |           |           |             |           |           |           |           |           |           |           |           |           | Top of Blow off           |
|       |           |           |           |           |           |             |           |           |           |           |           |           |           |           |           | 19 " Note Corvallis Main  |
|       |           |           |           |           |           |             |           |           |           |           |           |           |           |           |           | Int. of Water Main with   |
|       |           |           |           |           |           |             |           |           |           |           |           |           |           |           |           | Stilson Cr.               |
|       |           |           |           |           |           |             |           |           |           |           |           |           |           |           |           | 2096 "                    |
|       |           |           |           |           |           |             |           |           |           |           |           |           |           |           |           | 2648 "                    |
|       |           |           |           |           |           |             |           |           |           |           |           |           |           |           |           | 421.8 "                   |
|       |           |           |           |           |           |             |           |           |           |           |           |           |           |           |           | 228.5 "                   |
|       |           |           |           |           |           |             |           |           |           |           |           |           |           |           |           | 138.7 " Stilson Cr Intake |

Elevation of Stilson Cr. Intake above the  
Corvallis Rock Cr. Water Main at Sta 15 is 70 FT.

Certificate of Surveyor.

I, R. A. Lockwood, of Corvallis, Benton County, Ore., do hereby certify that this map was made from notes taken during an actual survey made by me on the 28th and 29th of Feb. 1912. and that it correctly represents the works described in the accompanying application and the above notes.

R. A. Lockwood,  
Engineer.

Application No. 1892  
Permit No. 1085