

Whiskey Creek Map

T. 36 S. R. 17 E. W. 11

T. 36 S. R. 12 E 30

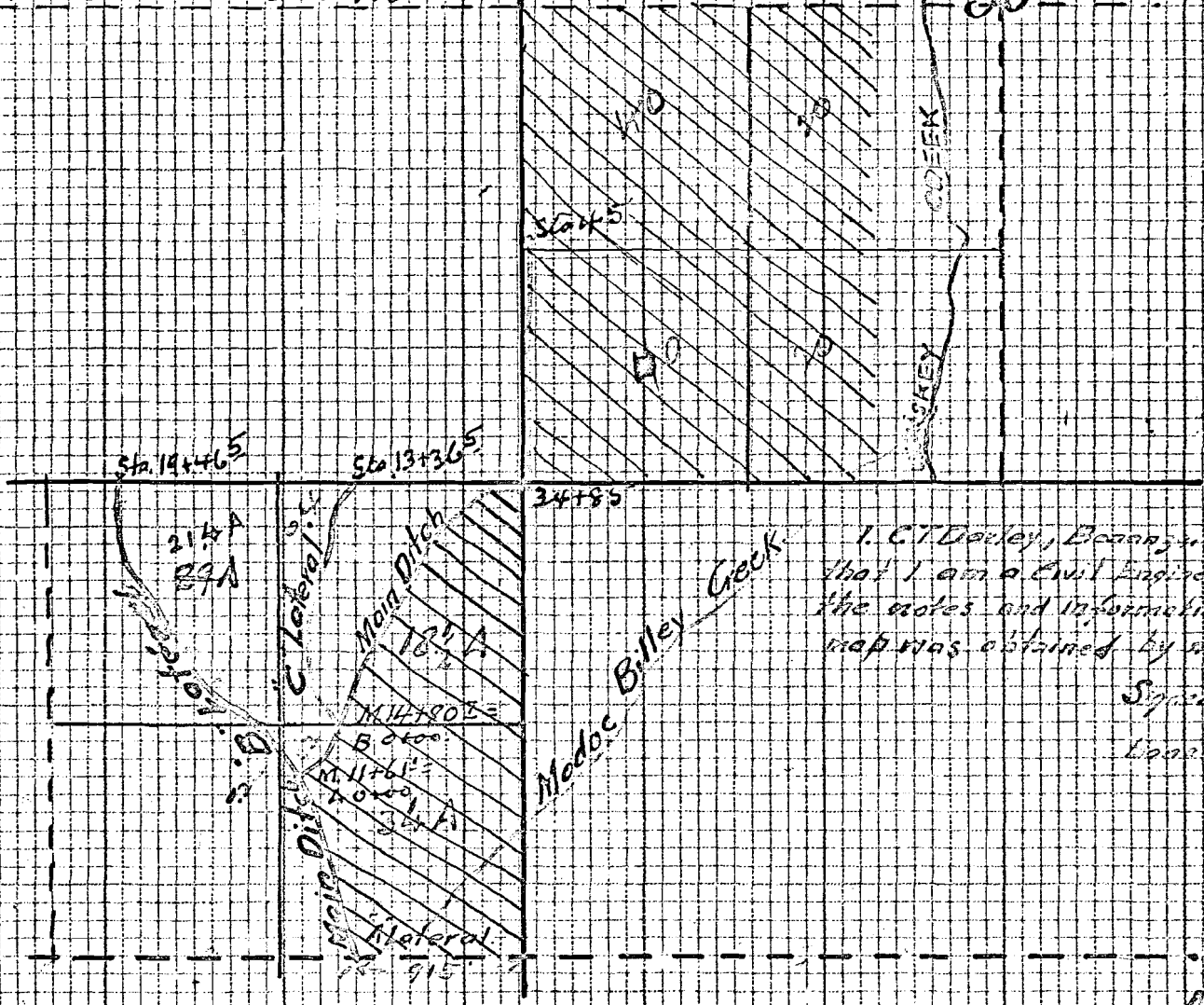

Scale 1" = 100'

I, C.T. Dowley, County Clerk, do hereby certify that I am a Civil Engineer & Surveyor, and that the notes and information on the accompanying map was obtained by me and are correct.

Signed by C.T. Dowley at
Lawrence, Ore. Nov. 6, 1910

App. No. 46642
2754

Map
Showing location of
DREN'S DITCH

" TEC " CROSS SECTION. 10 X 10 TO 1 INCH .

2754
2368