

28 27
33 34

Per 23709
23722

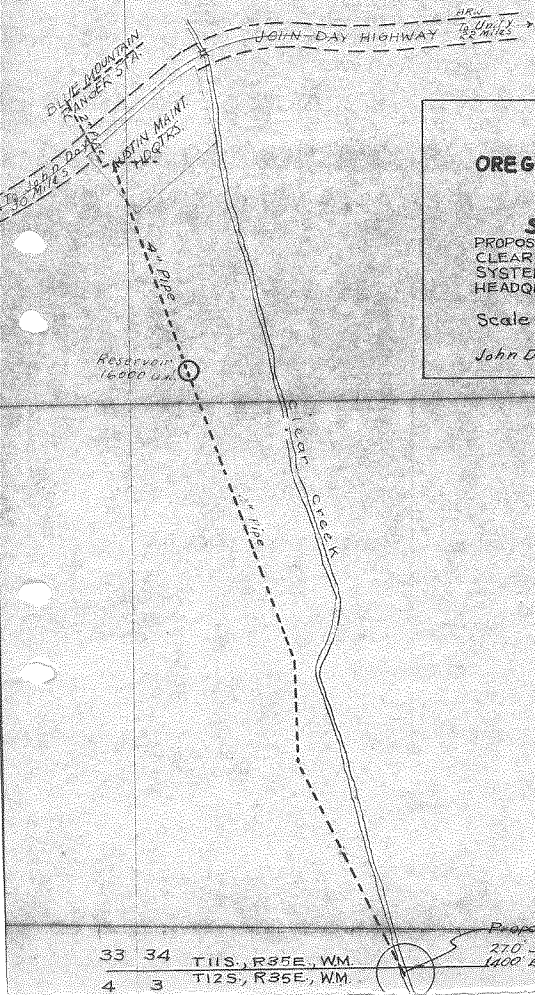

OREGON STATE HIGHWAY COMMISSION

SKETCH MAP

PROPOSED WATER INTAKE FROM CLEAR CREEK FOR NEW WATER SYSTEM - AUSTIN MAINTENANCE HEADQUARTERS

Scale 1" = 500' May 19, 1955

John Day Hwy. Grant Co.



App 30084
Per 23709

33 34 T11S., R35E., WM.
4 3 T12S., R35E., WM.

Proposed Intake
270' South } From the S.W. Corner
1400' East } Section 34, T11S., R35E.