

Surveyed by H. K. Donnelly & D. D. Cooper July  
 John H. Lewis - State Engineer  
 Examined July 14, 1909.

# Township 2 S

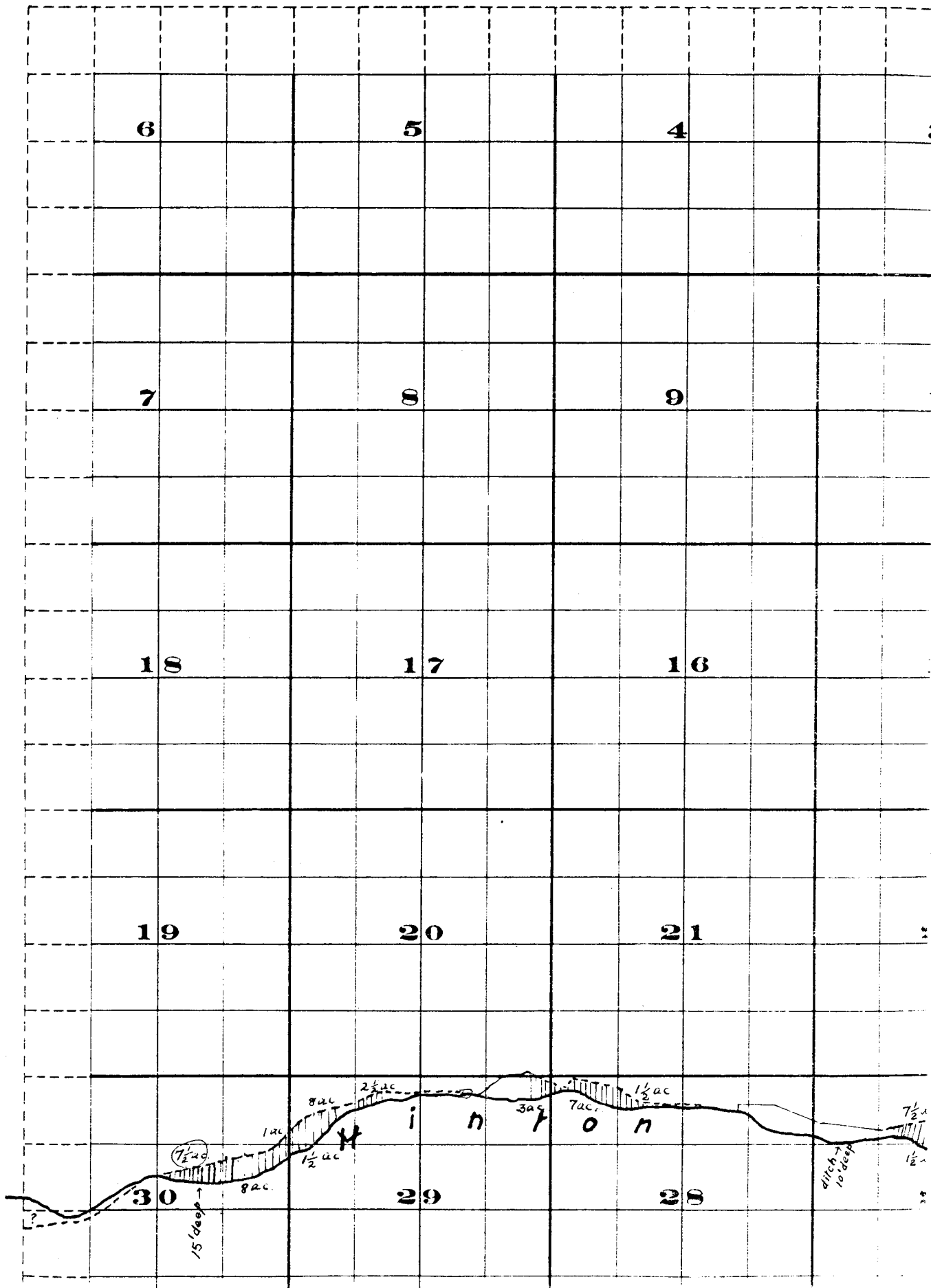

, Range 27 E.W.M.

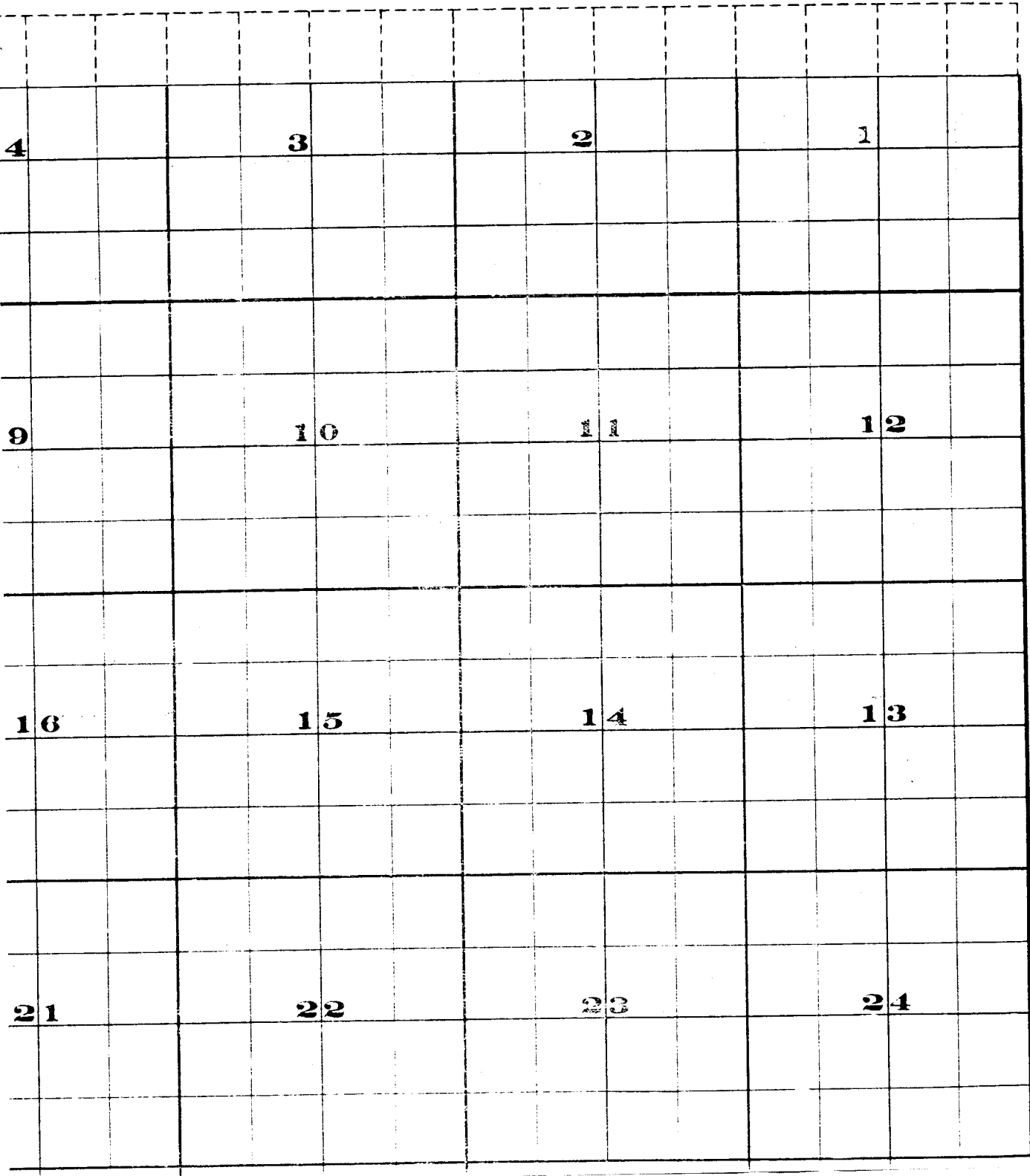

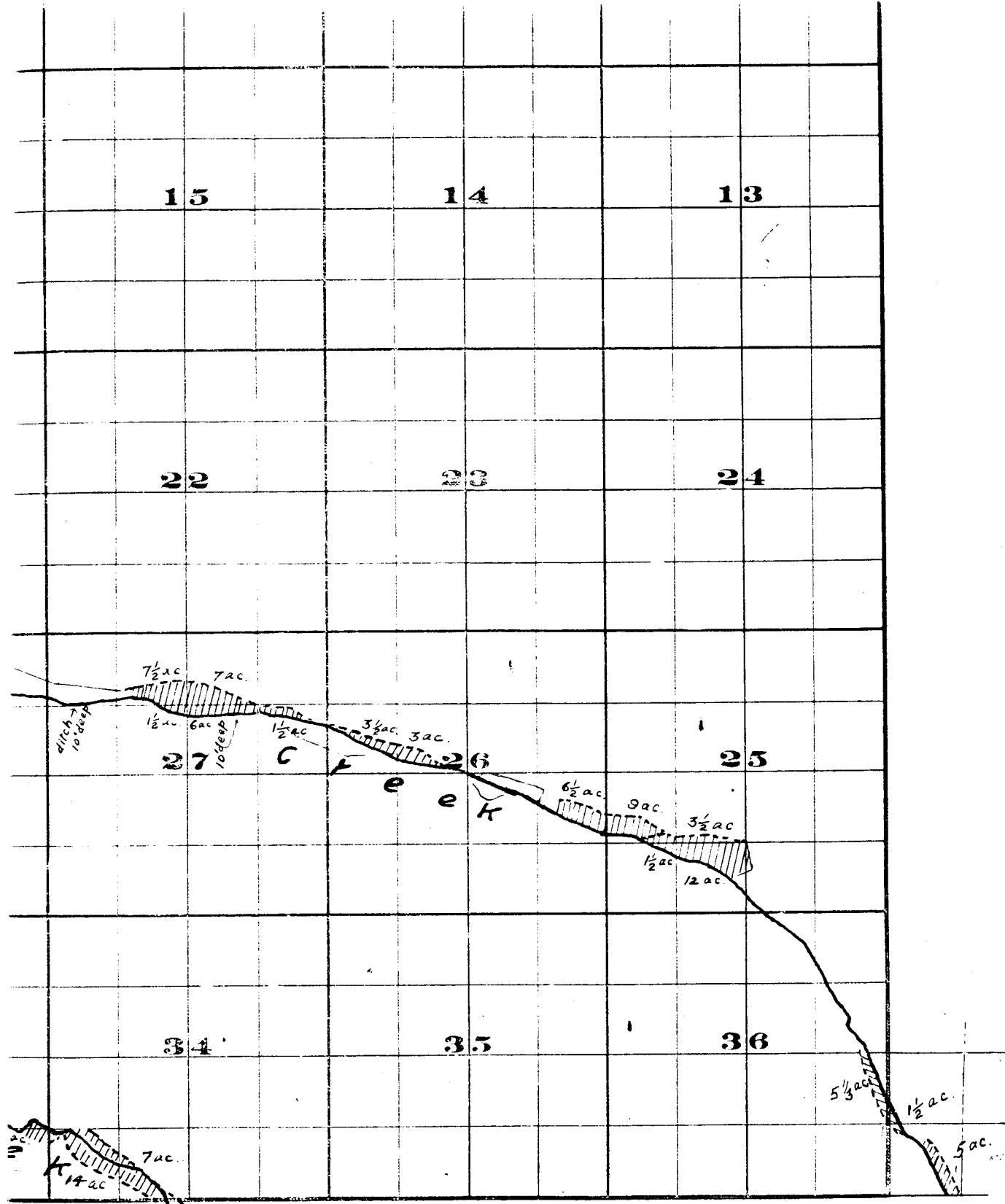

FROM OFFICE OF THE STATE ENGINEER, SALEM, OREGON

per July 1909  
 State Engineer

Willow Creek Adjudication

2 S. 27 E  
 Part 2 S. 28 E  
 Part 3 S. 27 E

S. , Range 26 E. W. M.

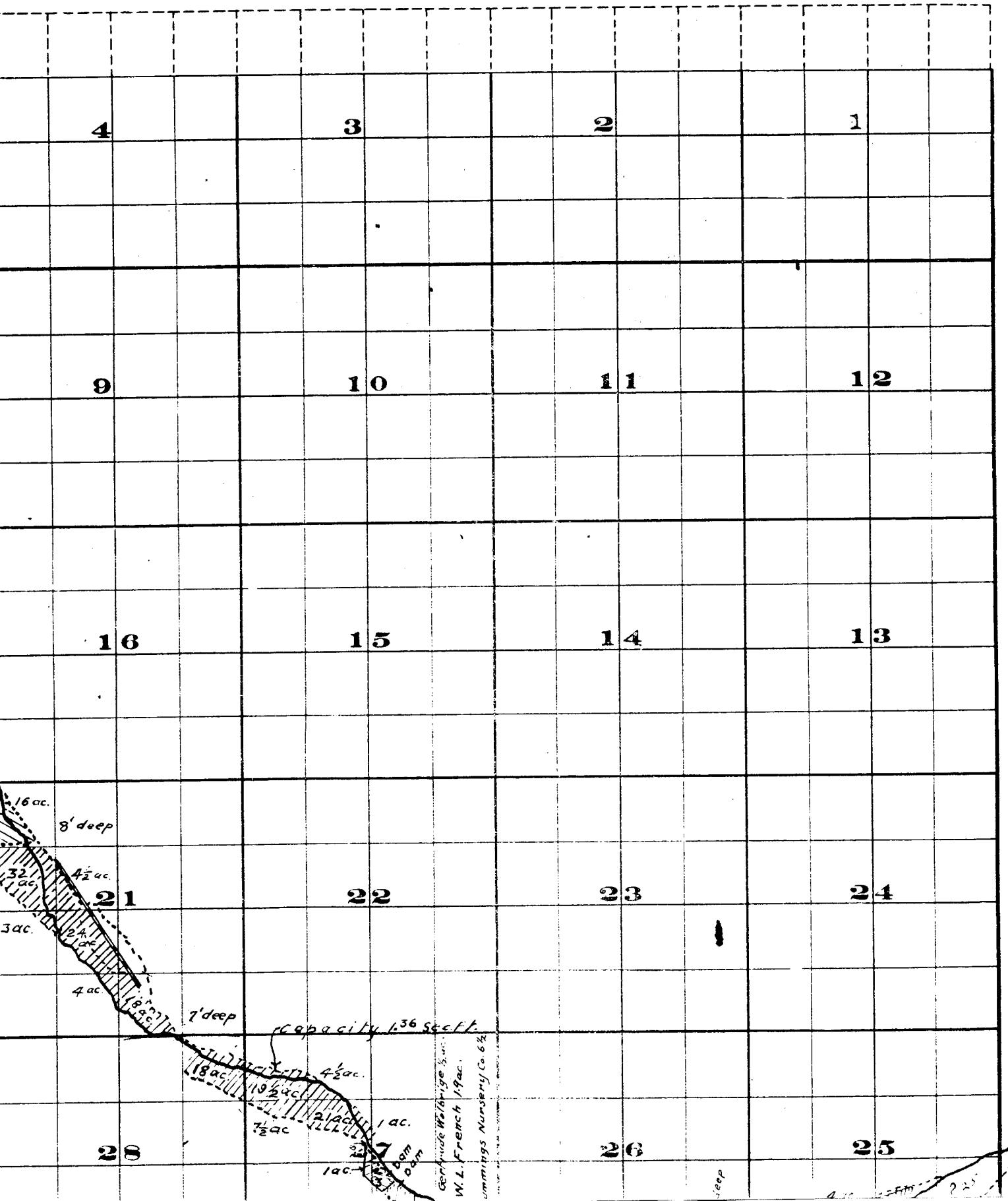

# Township 2 S. ,

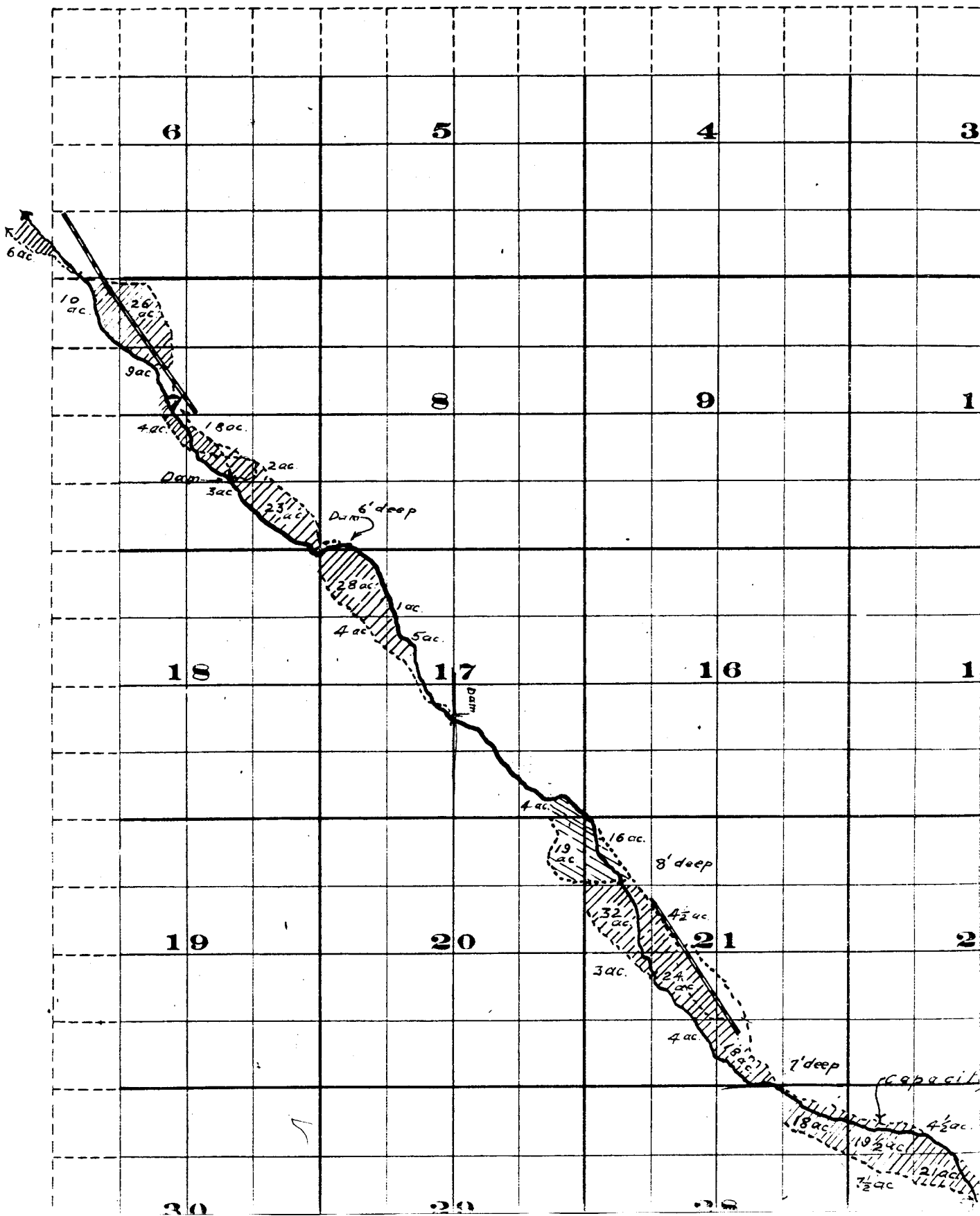



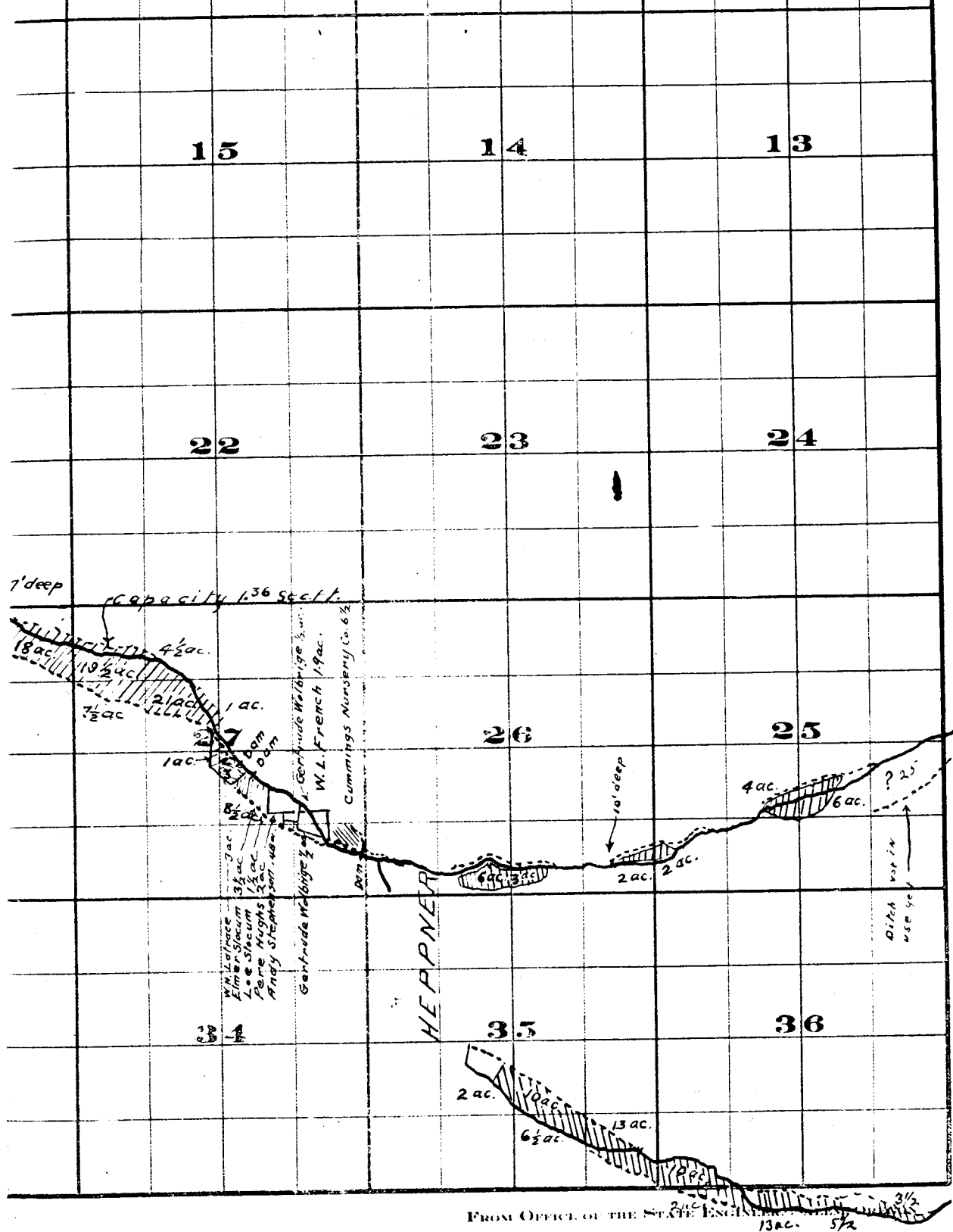

## Willow Creek Adjudication



Part 35.26  
25.26