

T. 8S. R. 4W. W.M.

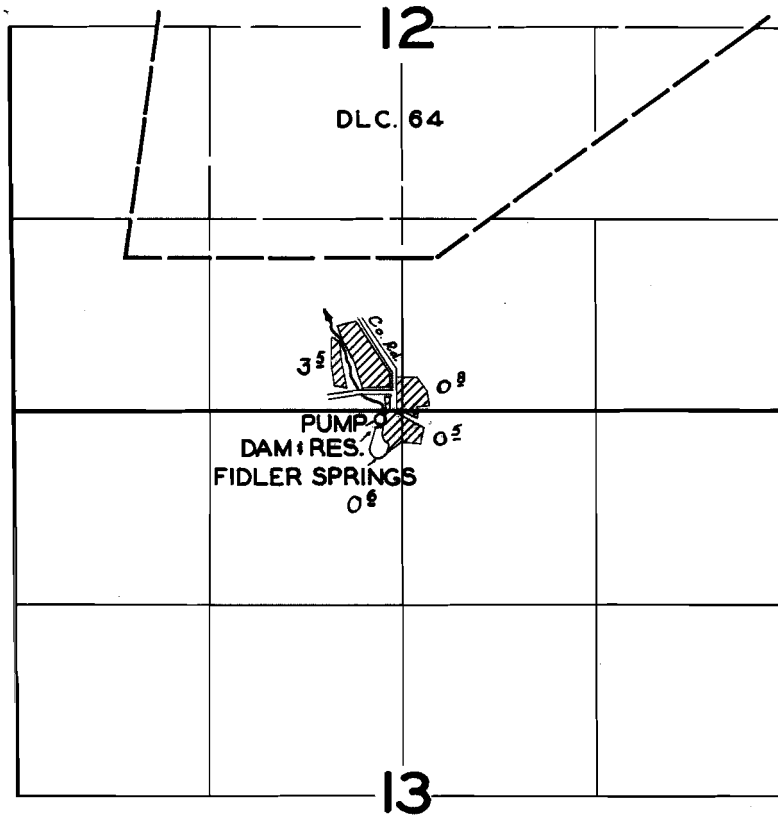

FINAL PROOF SURVEY

UNDER

R-27590

R-1586

Application No. 27591 Permit No. 22732

IN NAME OF

EDNA M. BARKER

Surveyed APR. 4. 1957, by C.O. BARTELS

N 1° 13' E 182.15
N 3° 38' W 213.84

N 89° 32' W. 493.02

SECTION 12
1/4 COR.

SECTION 13

S 73° 32' W 206

TOP OF DAM 10'± WIDE
TOP OF DAM ELEV. 49.7 AVG.
LENGTH OF DAM 70'±
SPILLWAY EL. 46.88

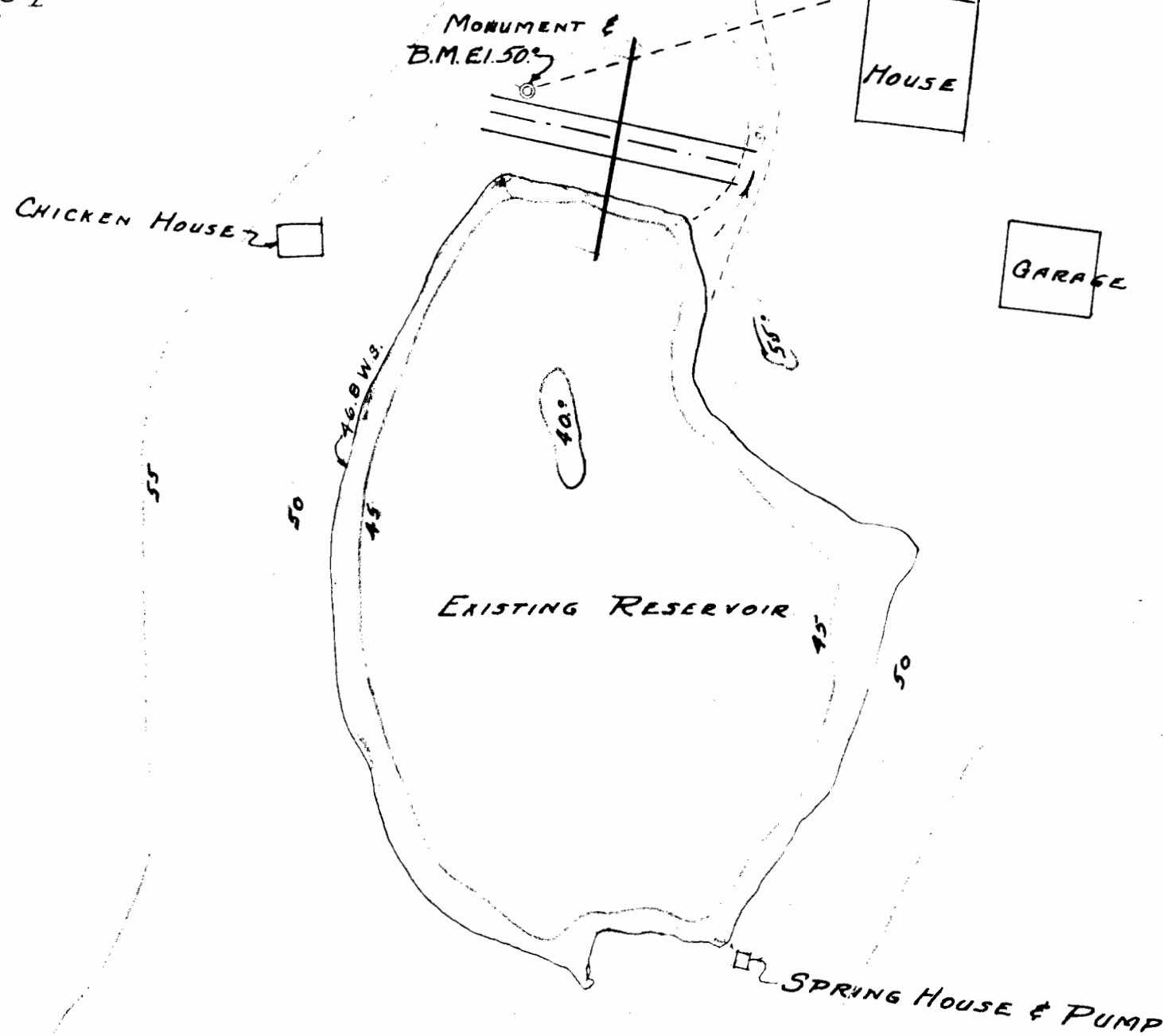

SCALE 1"=40'

N.E. 1/4 OF N.E. 1/4 OF N.W. 1/4
SEC. 13.

N 88° 41' W. 1141.80

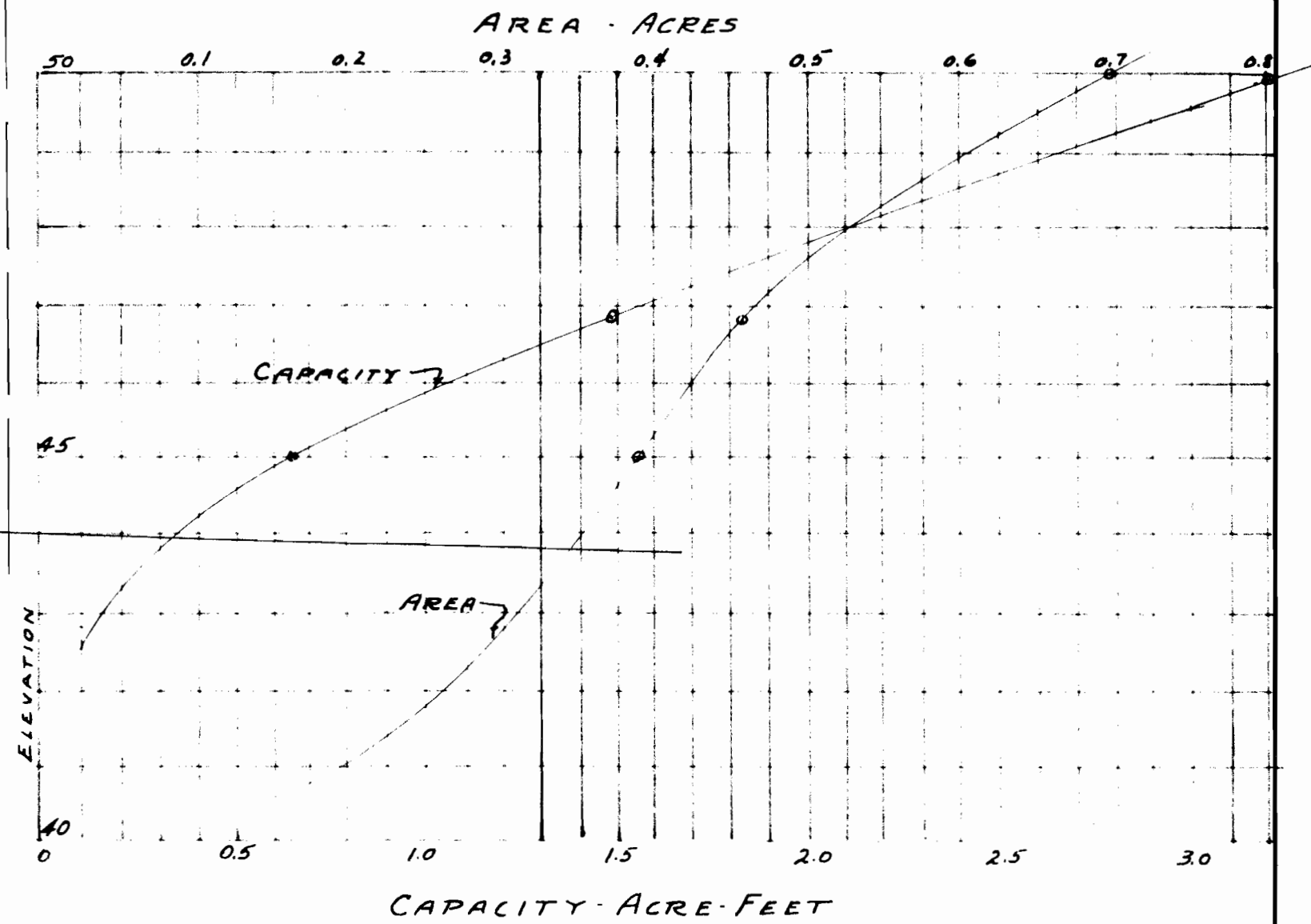

MRS. EDNA M. BARKER
RESERVOIR TOPO, AREA-CAPACITY
RE: APP. Nos. 27590 & 27591

SCALE SHOWN	DATE FEB. 24, 1954	J.O. 5407-211
DRWG AC	CLARK & GROFF ENGINEERS 3245 S. COMMERCIAL ST. SALEM, OREGON	SHEET
DSGN SURVEY B		NO. → 1
CHKD AC		OF 1