

Klamath River

I, J.W. Kerns of Keno Ore. do hereby certify that this map was made from notes taken during an actual survey made by me on June 20, 1911, and that it correctly represents the works described in the accompanying application together with the location of streams and other ditches in the immediate vicinity

J.W. Kerns

MAP

Applying for permit to appropriate water for Power

J.W. Kerns

Aug 5, 1911
Scale 2" = 1 Mile

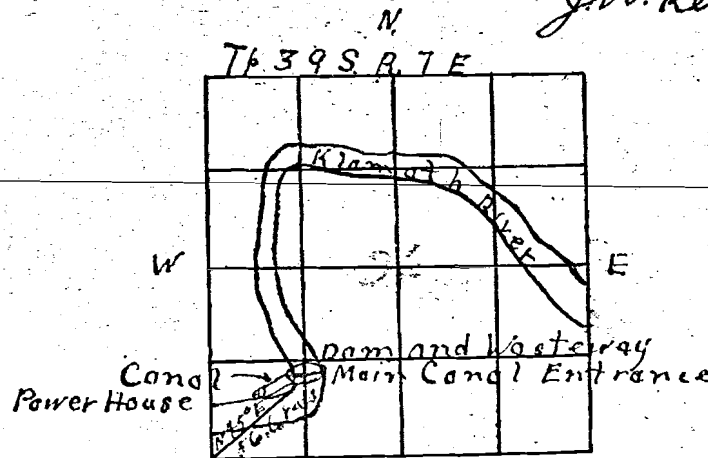

OFFICE OF STATE ENGINEER
RECEIVED
OCT 9 1911
SALT LAKE CITY, UTAH

Application No. 1503
Permit No. 861

Profile of Dam

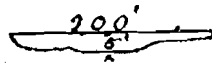

Scale 1" = 200'

Cross section of Dam

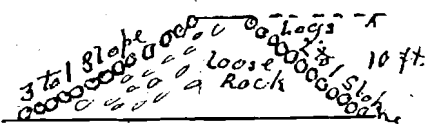

Scale 1" = 20'

Cross Section of Canal

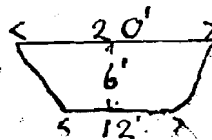

Scale 1" = 20'

861
2437
19251