

Klamath Co. Misc

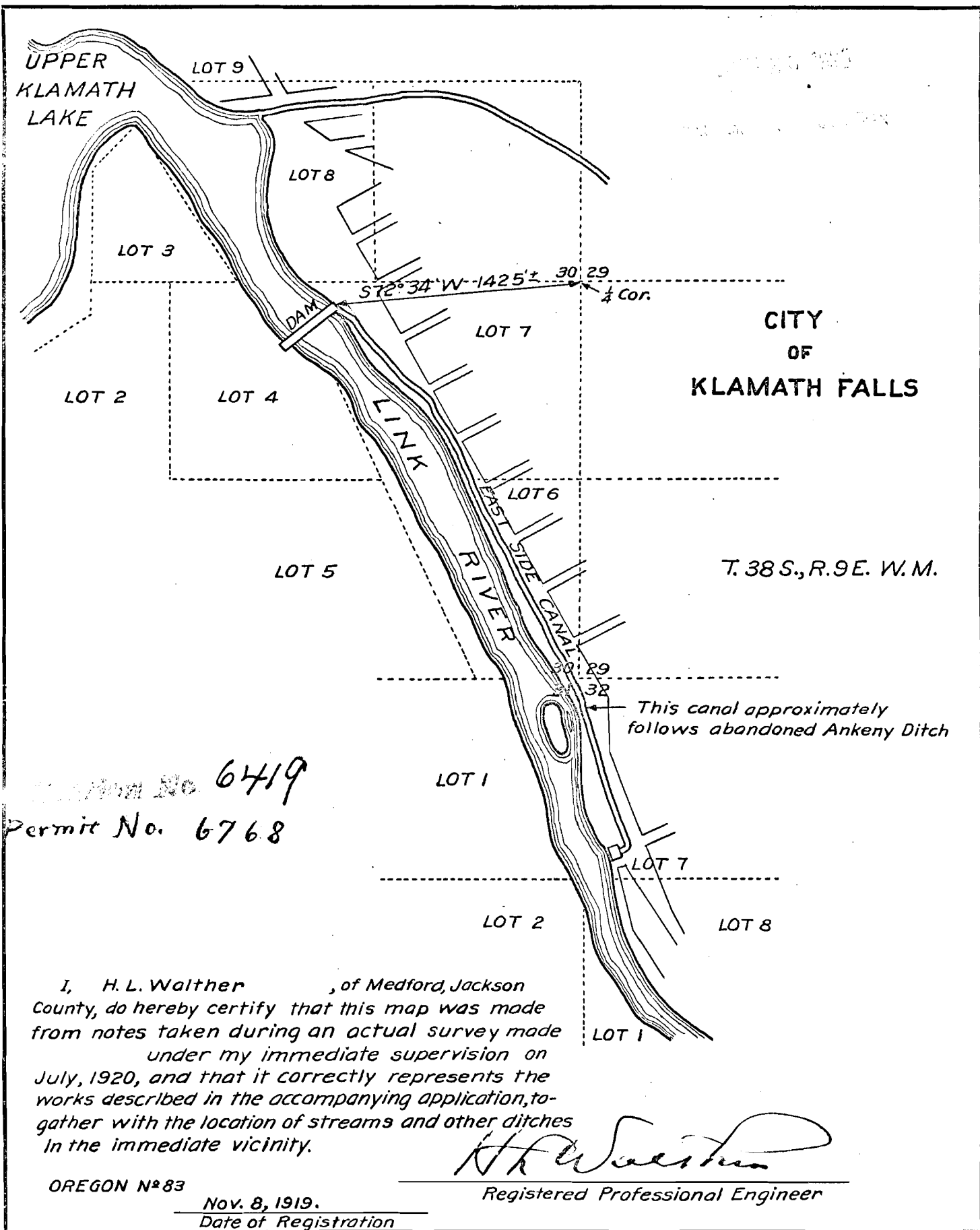

Application No. 6419
 Permit No. 6768

I, H. L. Walther, of Medford, Jackson County, do hereby certify that this map was made from notes taken during an actual survey made under my immediate supervision on July, 1920, and that it correctly represents the works described in the accompanying application, together with the location of streams and other ditches in the immediate vicinity.

H. L. Walther
 Registered Professional Engineer

OREGON N^o 83
 Nov. 8, 1919.
 Date of Registration

DRAWN BY
 TRACED BY L.d.L.
 CHECKED BY *EBW.*
 APPROVED BY *W.A.D.*

SCALE 850 Ft. To 1 in.

**KLAMATH FALLS - EAST SIDE PLANT
 OUTLINE OF DEVELOPMENT TO ACCOMPANY
 APPLICATION N^o 6419 TO STATE OF OREGON**