

Range 26 E. W. M.

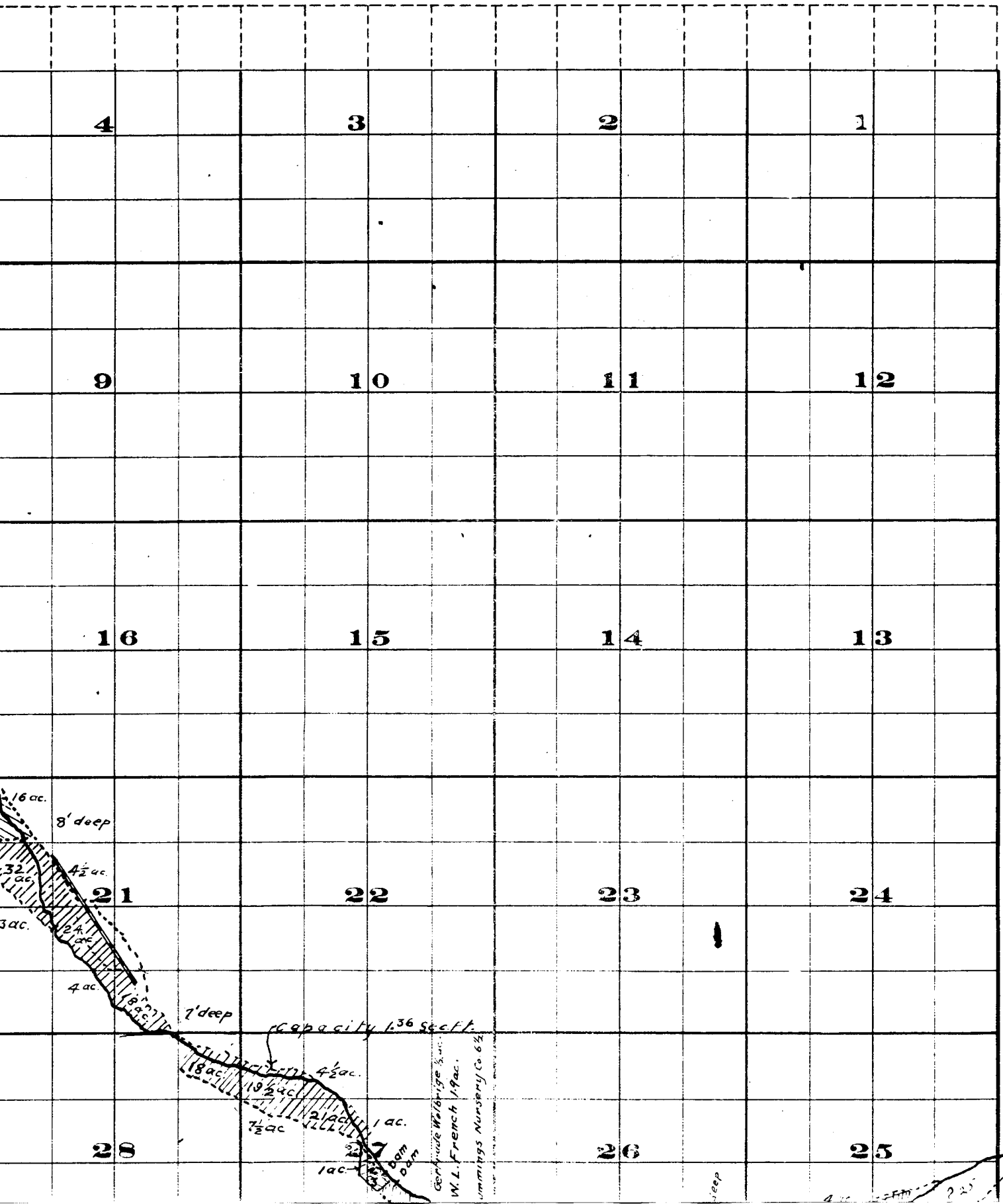

Township 2 S.

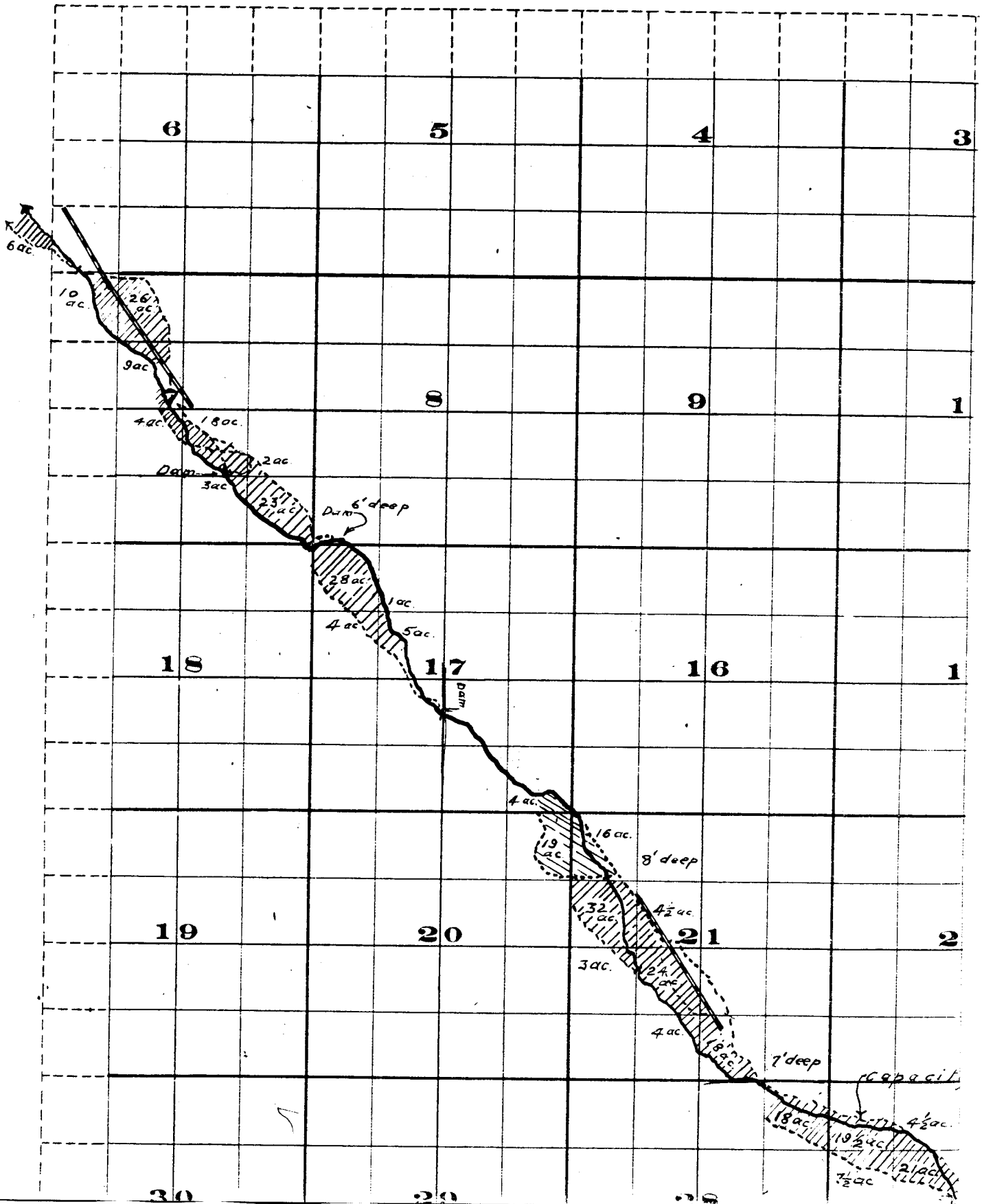

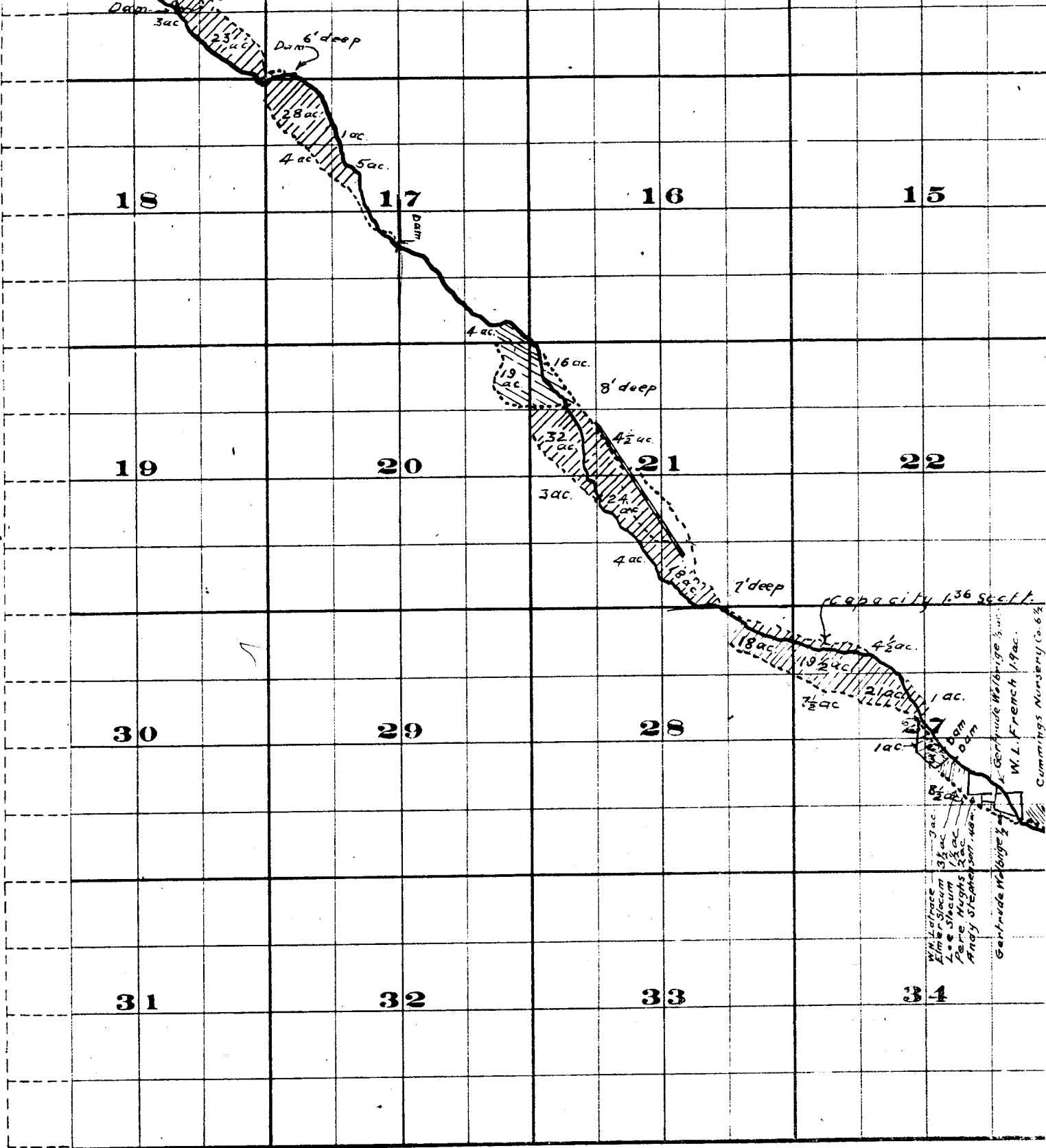

THE B. BRISTOL CO., PRINTERS & ROAD-BUILDERS CHRYSTIANE W.V.

Surveyed by R.D. Cooper July 1909
 John H. Lewis - State Engineer.
 Examined July 14, 1909.



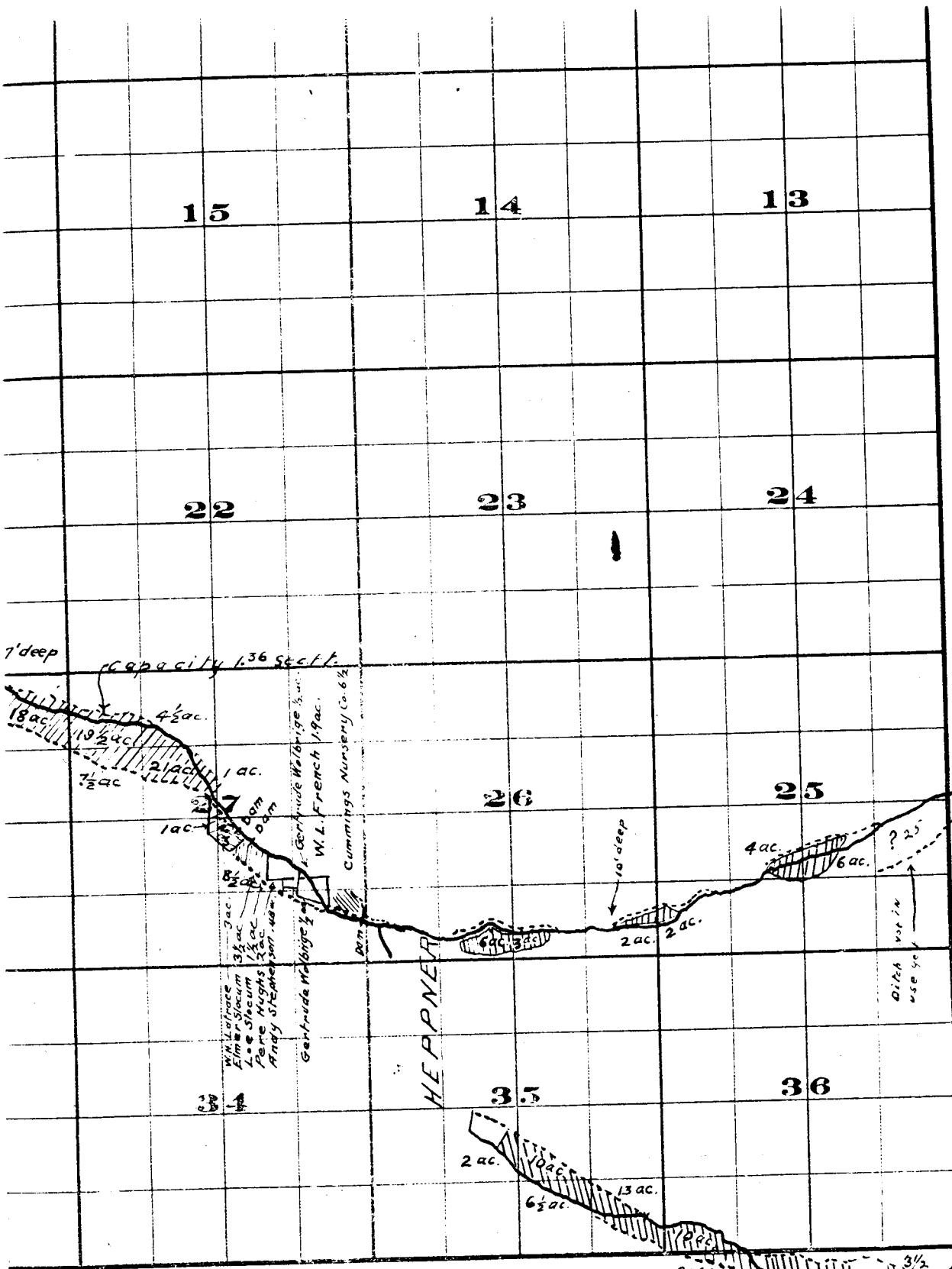

FROM OFFICE OF THE STATE ENGINEER
13ac. 5/2

Willow Creek Adjudication



Part 35.26
25.26

Range 26 E.W.M.

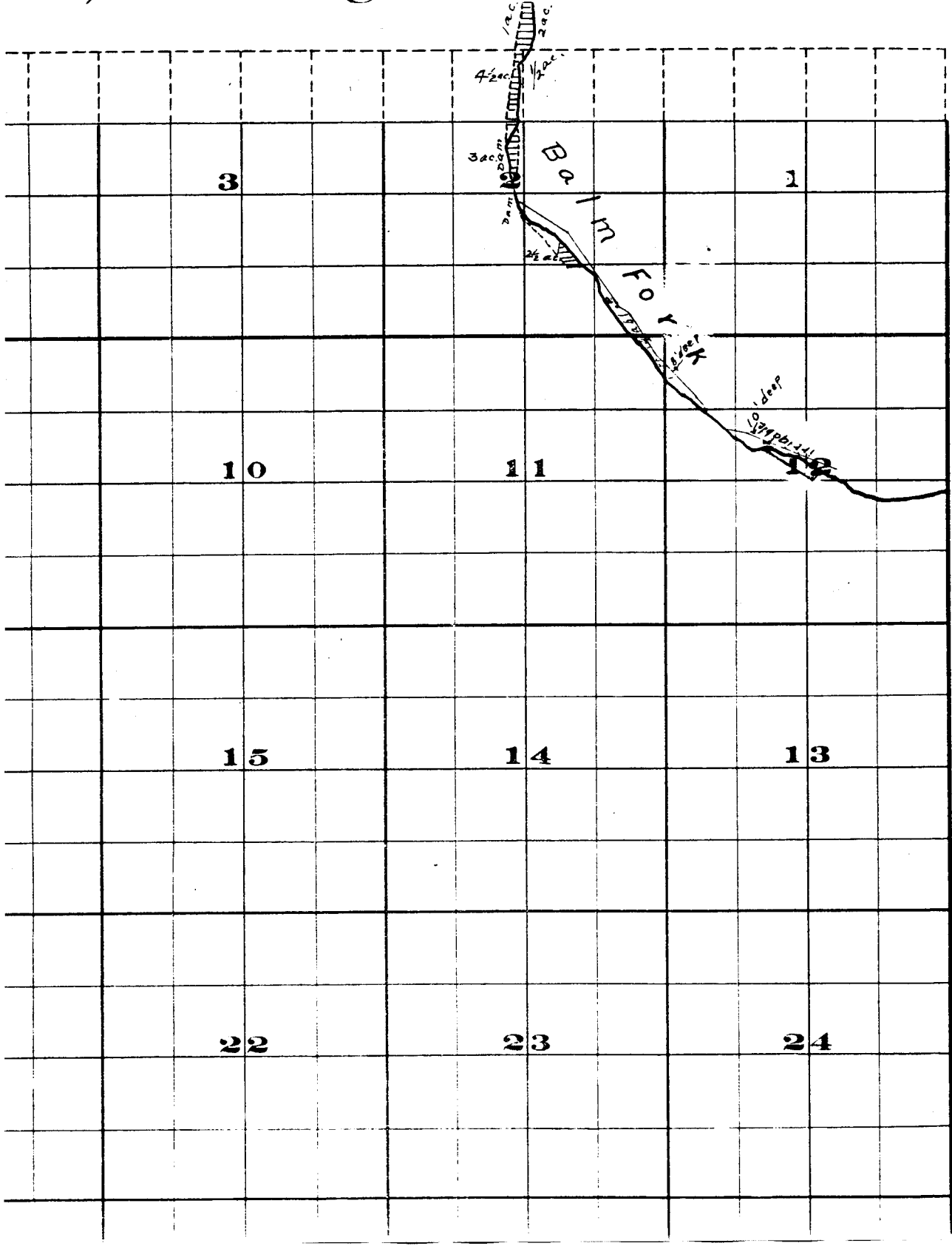

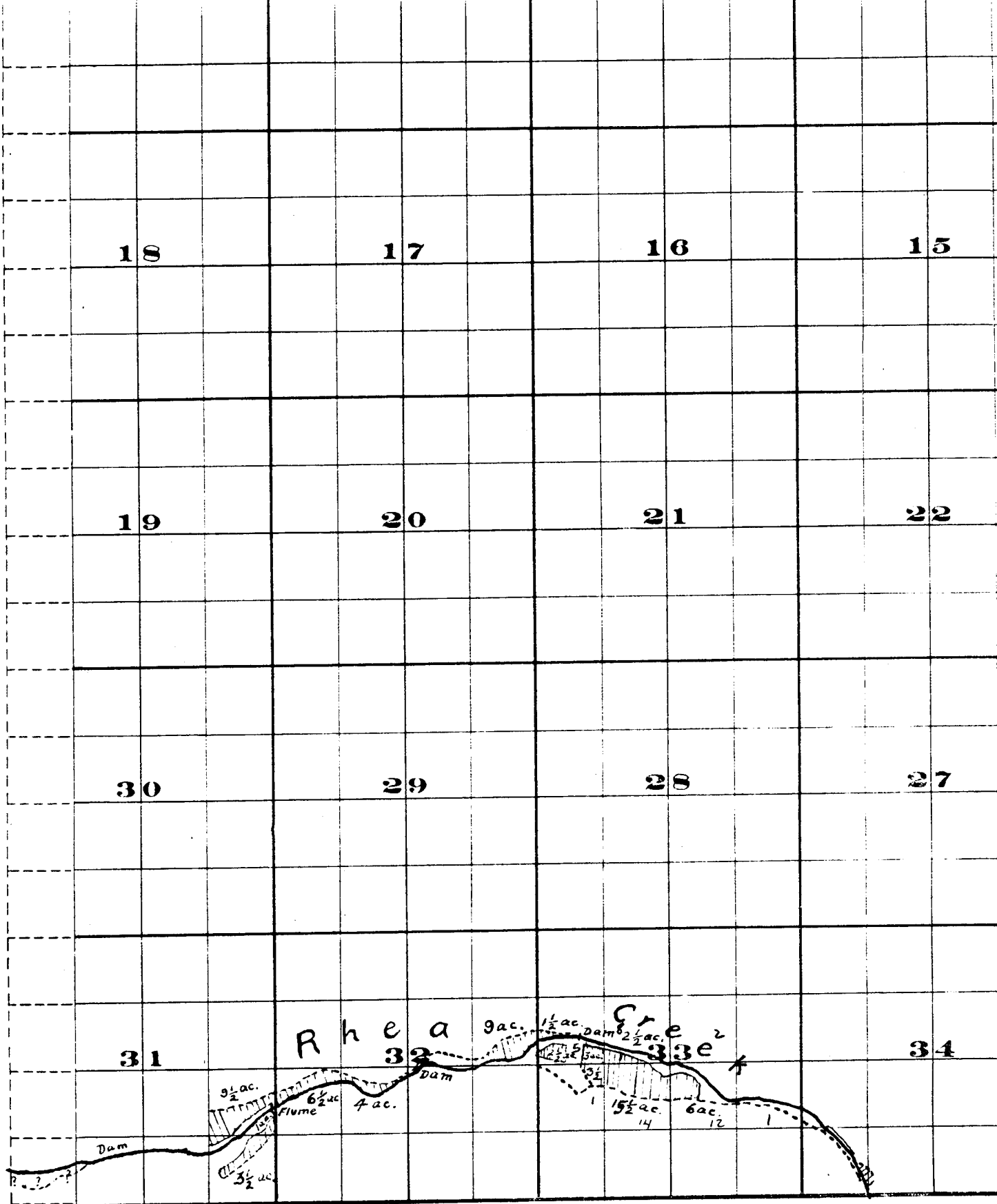

THE S. A. BRISTOL CO. PRINTERS & BOUNDERS CHICAGO, ILL.

Surveyed by H. M. Donnelly July 1909

John H. Lewis - State Engineer

Examined - July 14, 1909.

	15			14				13	
	22			23				24	
	27			26				25	
	34			35				36	

FROM OFFICE OF THE STATE ENGINEER, SALEM, OREGON

Willow Creek Adjudication

3 S. 26 E.