

13

14

15

24

23

22

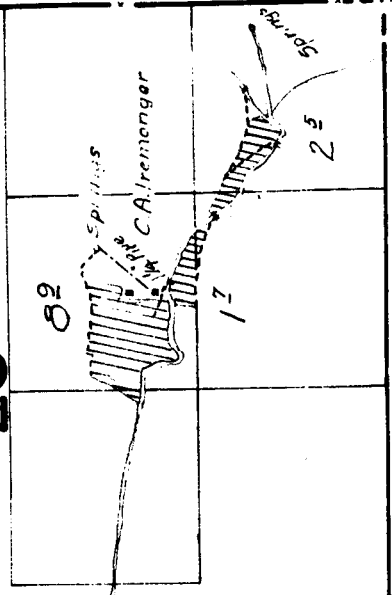

sketched in approximate  
at in the vicinity of

27

26

25

34

35

36

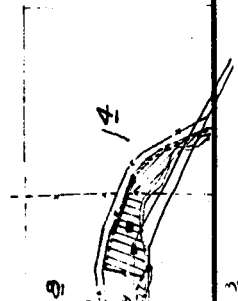

18

17

16

19

20

21

CREEK

HOOVER

O.C. Veatch

19

24

Brush

Spring

RIM

WASH

5096

28

Surveyed Nov. 12, 14, 2

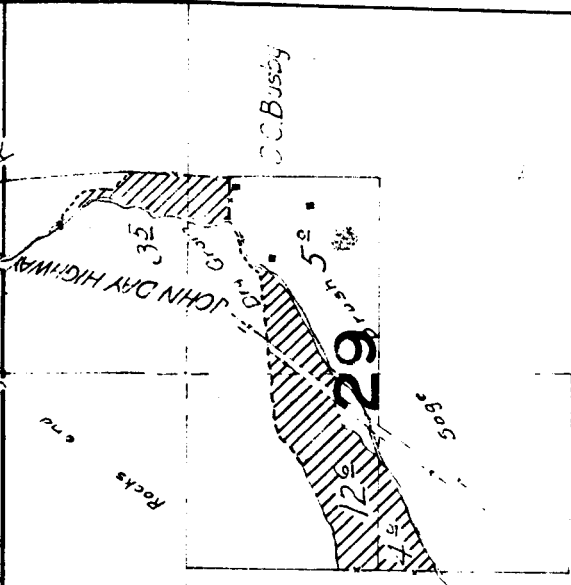

30

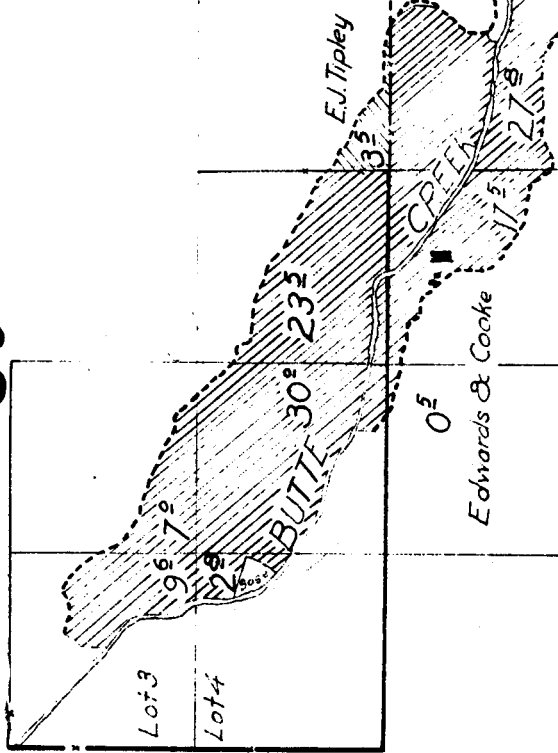

31

32

33

FOSSIL

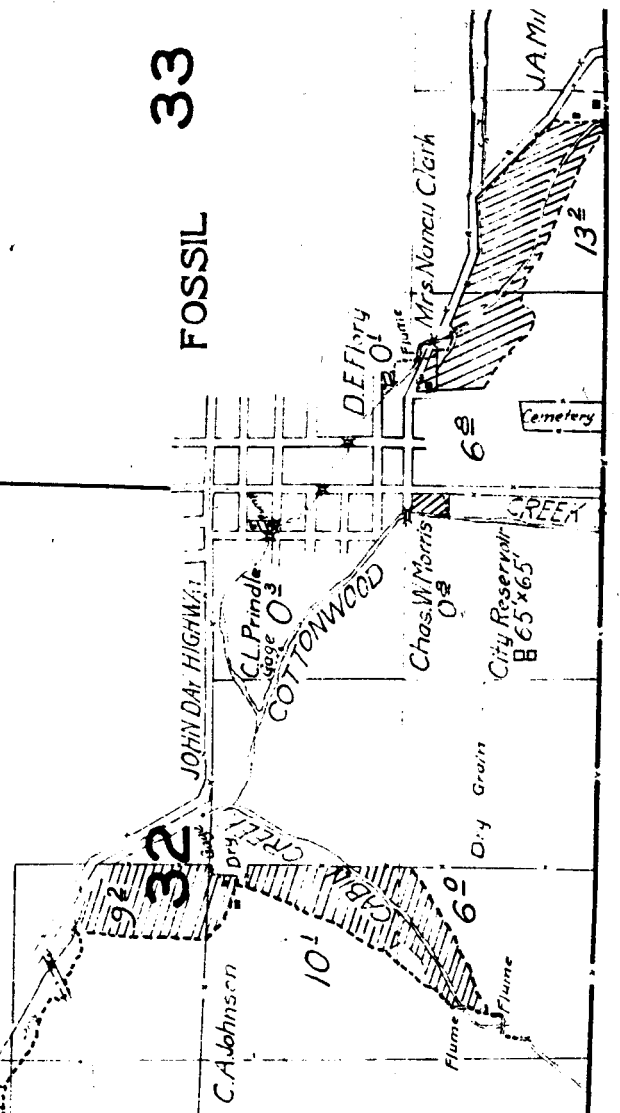

Cemetery

DEER CREEK

City Reserve

B 65' x 65'

Dry Grain

Flume

Flume

Flume

Flume

Flume

Flume

Flume

Flume

Flume

Flume

Flume

Flume

Flume

Flume

Flume

Flume

Flume

Flume

Flume

Flume

Flume

Flume

Flume

Flume

Flume

Flume

Flume

Flume

Flume

14

13

11

12

2

1

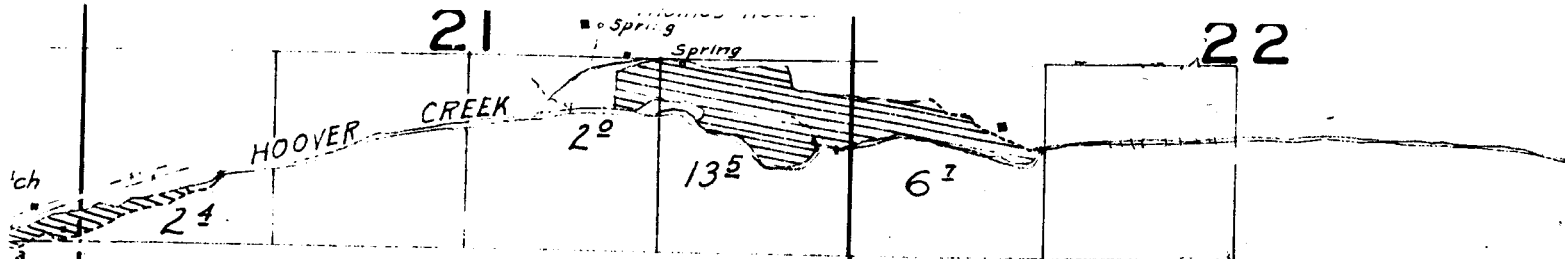

NOTE: Streams sketched in approximate location except in the vicinity of irrigated land.

28

27

Surveyed Nov. 12, 14, 20, & 21, 1925.

FOSSIL 33

34

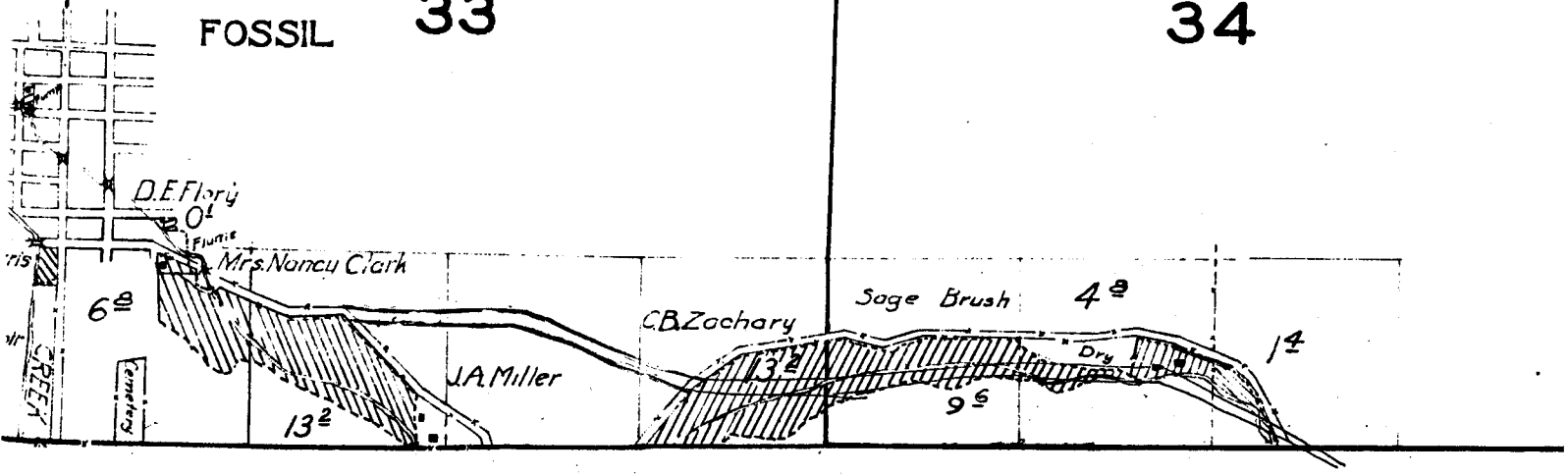

**TOWNSHIP 6 S., RANGE 21 E.**

|  |   |  |    |
|--|---|--|----|
|  |   |  |    |
|  | 3 |  | 10 |
|  | 4 |  | 9  |
|  |   |  |    |

15

16

22

21

Thomas Hoover  
Spring

CREEK

HOOPER

O.C. Veatch  
12

24

20

13E

61

NOTE: Streams sketched in approximate location except in the vicinity of irrigated land.

Brush  
Spring Forks  
10

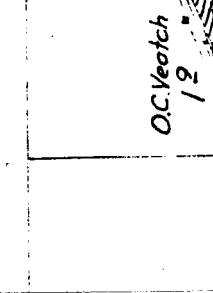
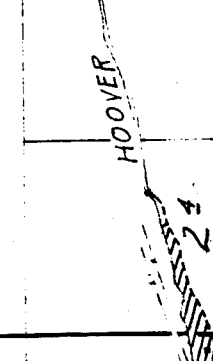
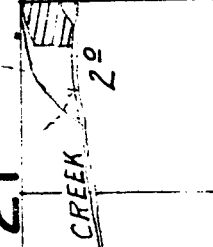
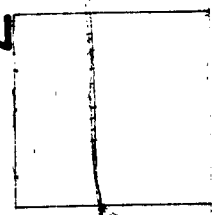



18

17

7

8

9

5