

FROM OFFICE OF THE STATE ENGINEER, SALEM, OREGON
Willow Creek Adjudication

35.27E.

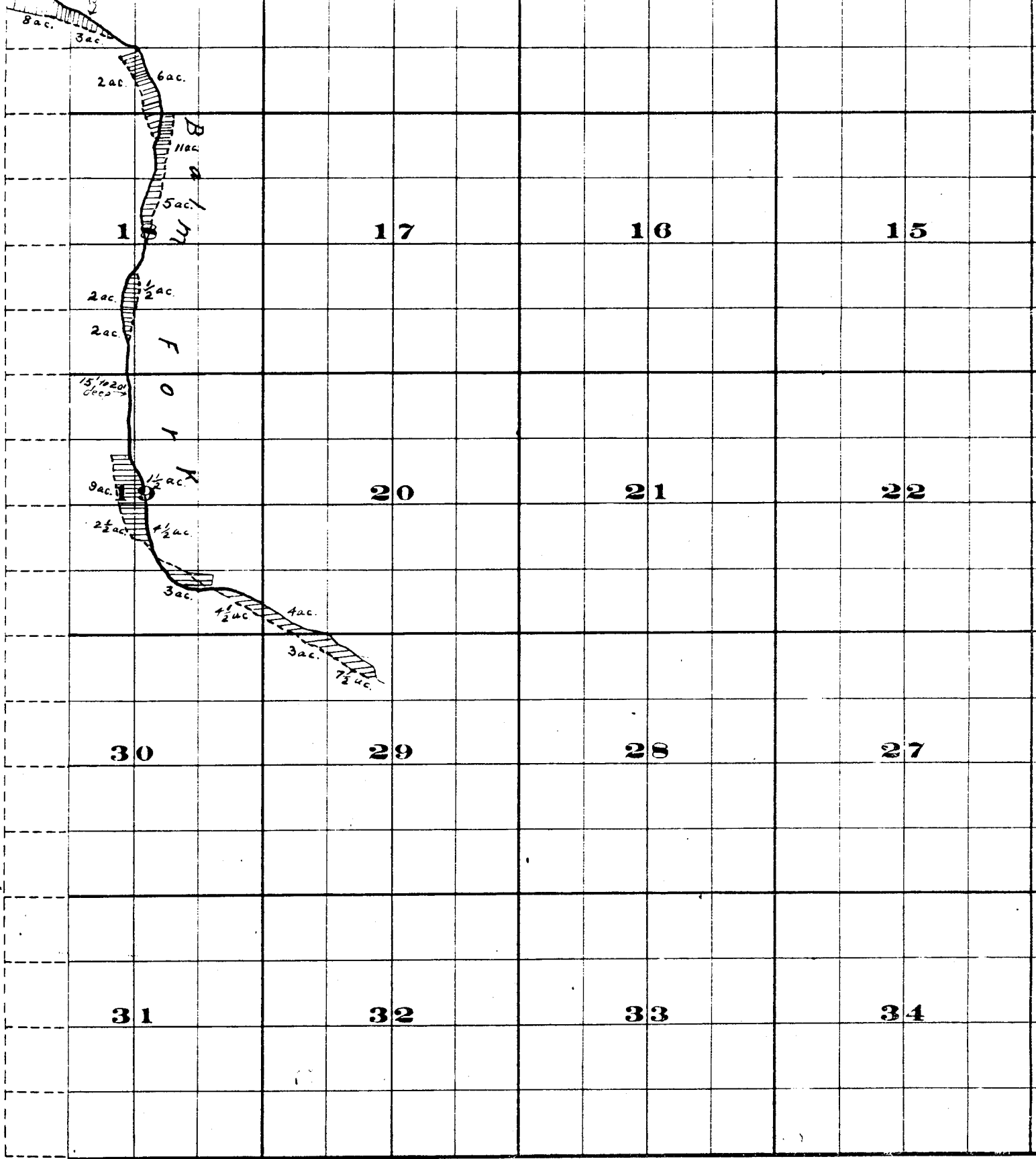

THE S. A. BRISTOL CO. PRINTERS & BOUNDINGERS CLEVELAND, OHIO

Surveyed by H. K. Donnelly July 1909
 Surveyed by R. D. Cooper July 1909
 John H. Lewis - State Engineer
 Examined, July 14, 1909.

Township 35

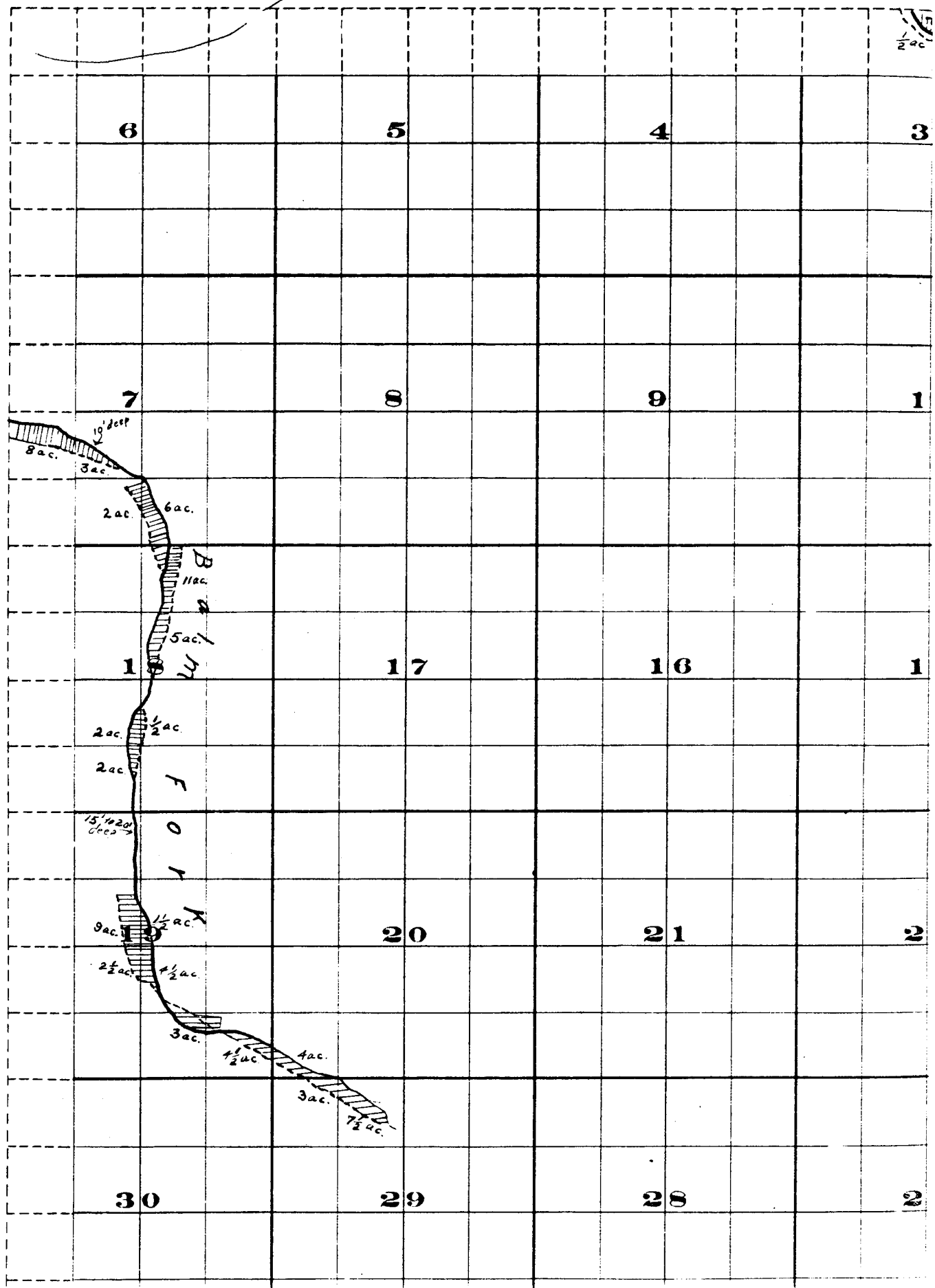

, Range 27 E.W.M.

