

TOWNSHIP 1 N., RANGE 20 E

4

3

9

10

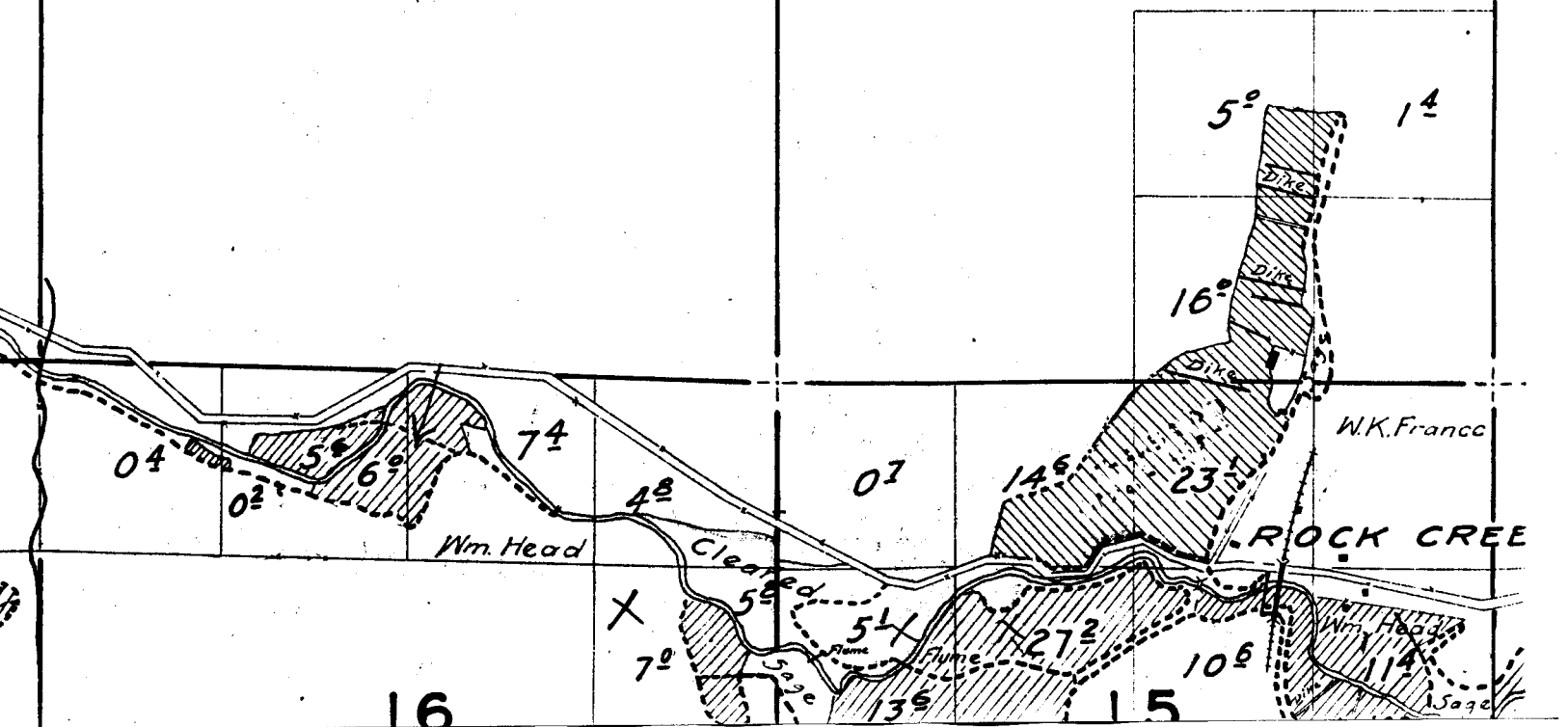

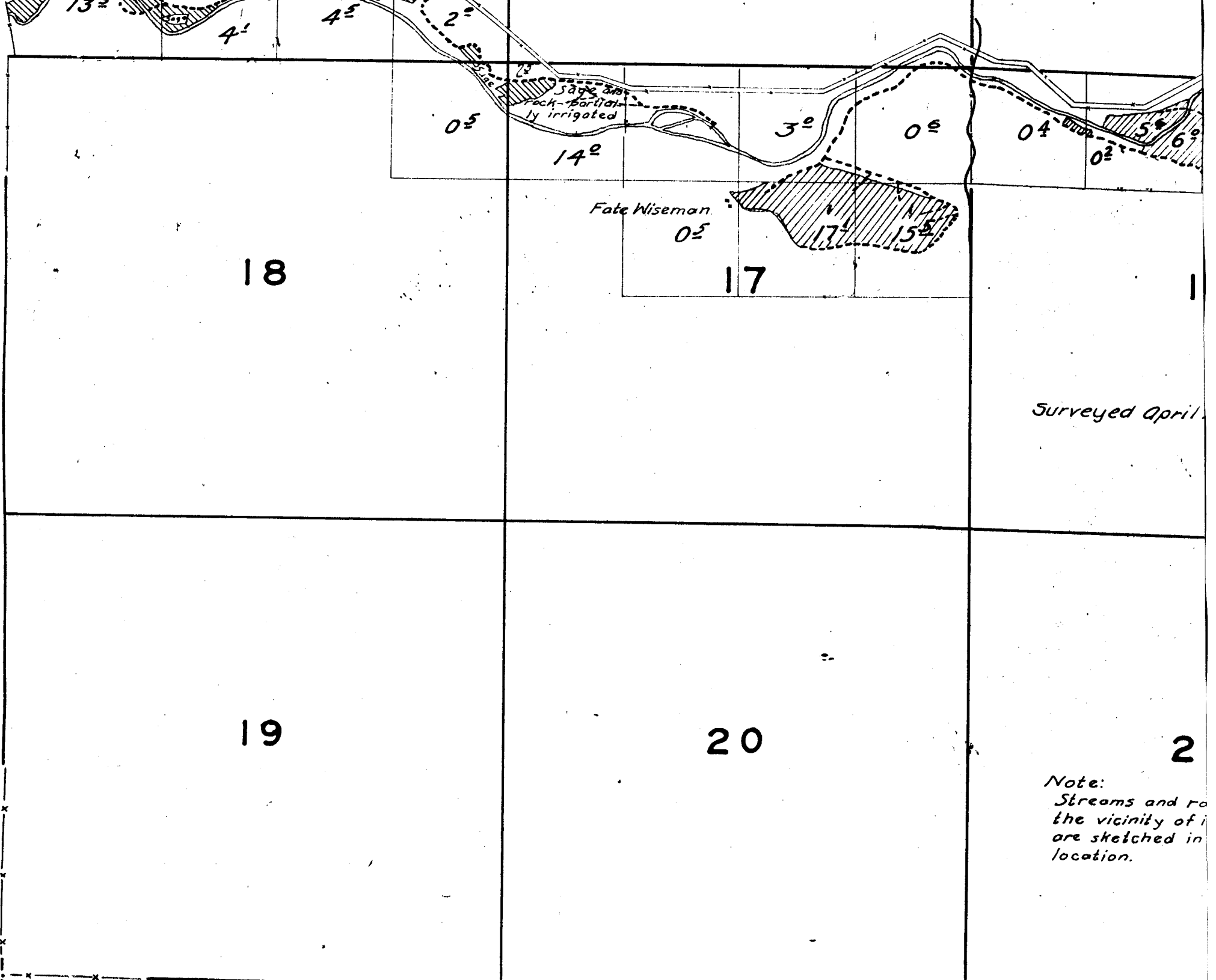

TOWNS

6

5

7

8

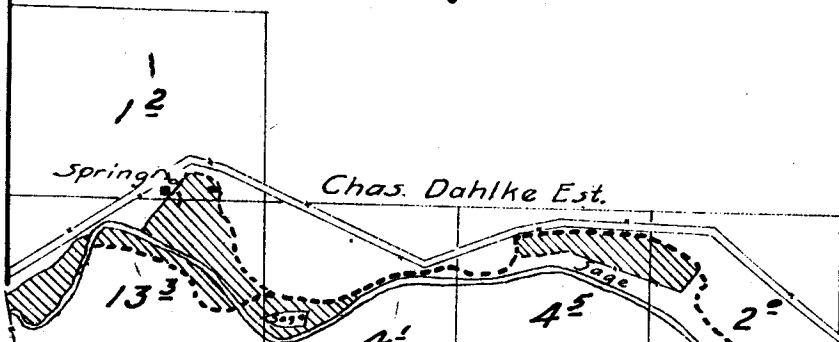

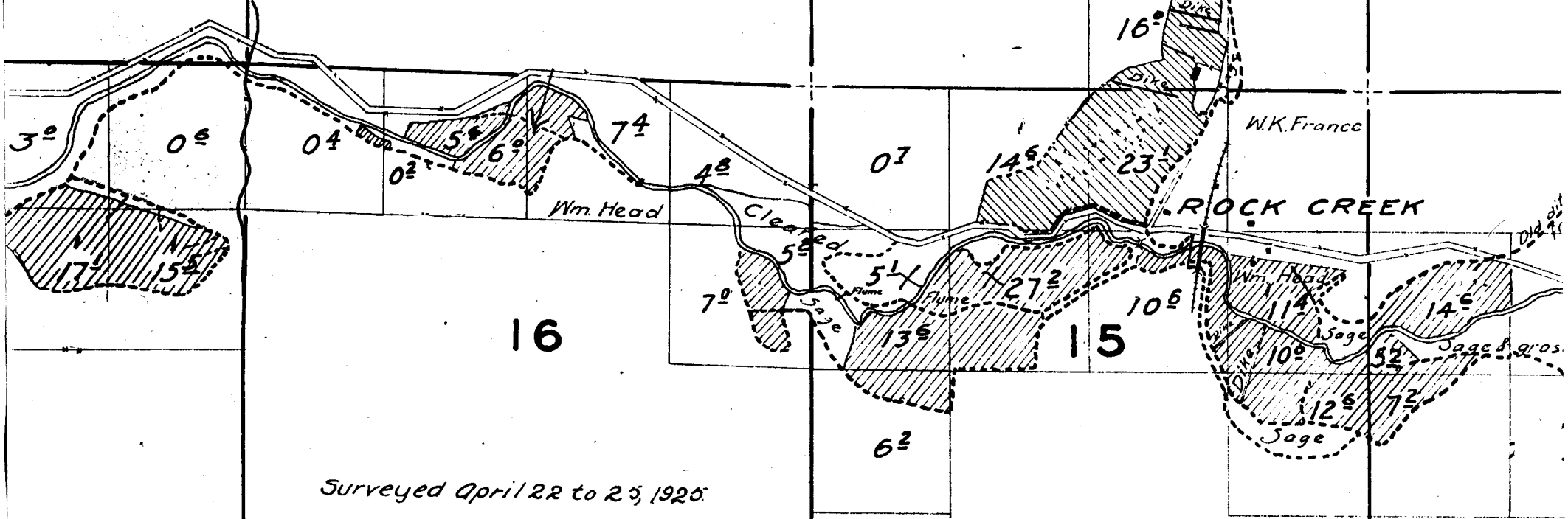

Surveyed April 22 to 25, 1925.

21

22

Note:
Streams and roads, except in
the vicinity of irrigated land,
are sketched in approximate
location.

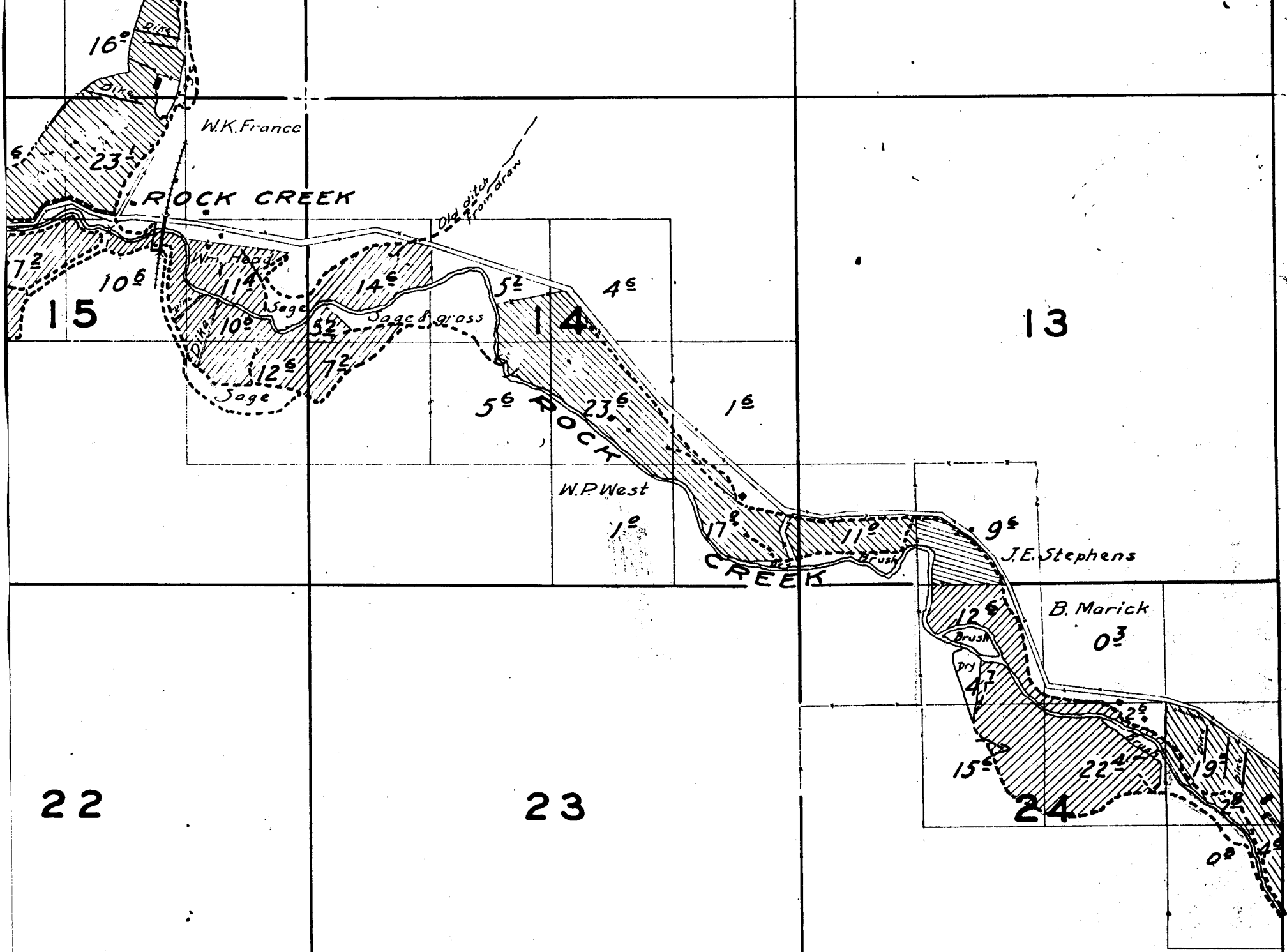

28

27

33

34

19

20

30

29

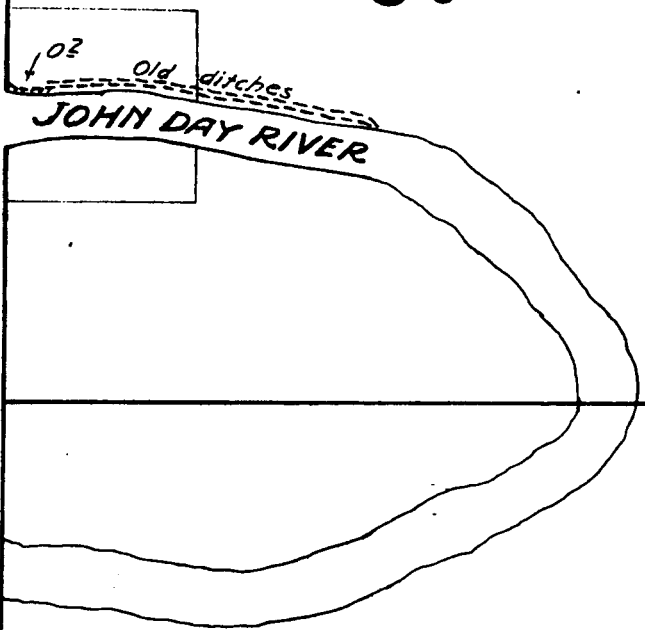

JOHN DAY RIVER

31

32

23

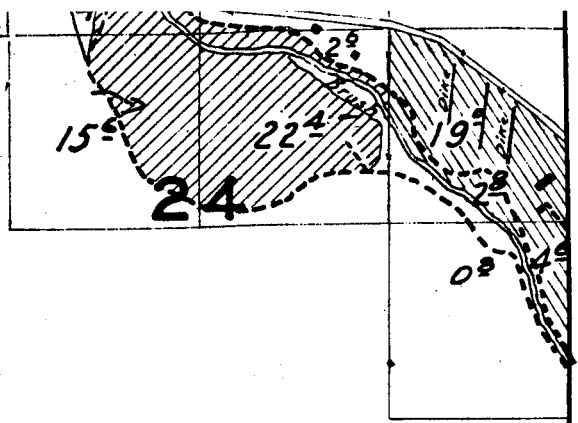

26



25

35

36

3

2

1

10

11

12

