

29

roads, except in  
of irrigated land,  
d in approximate

28

27

Surveyed April 28 and 29, 1925.

32

187

169

33

53

43

73

W.H. Weatherford

Grain (No ditches)

34

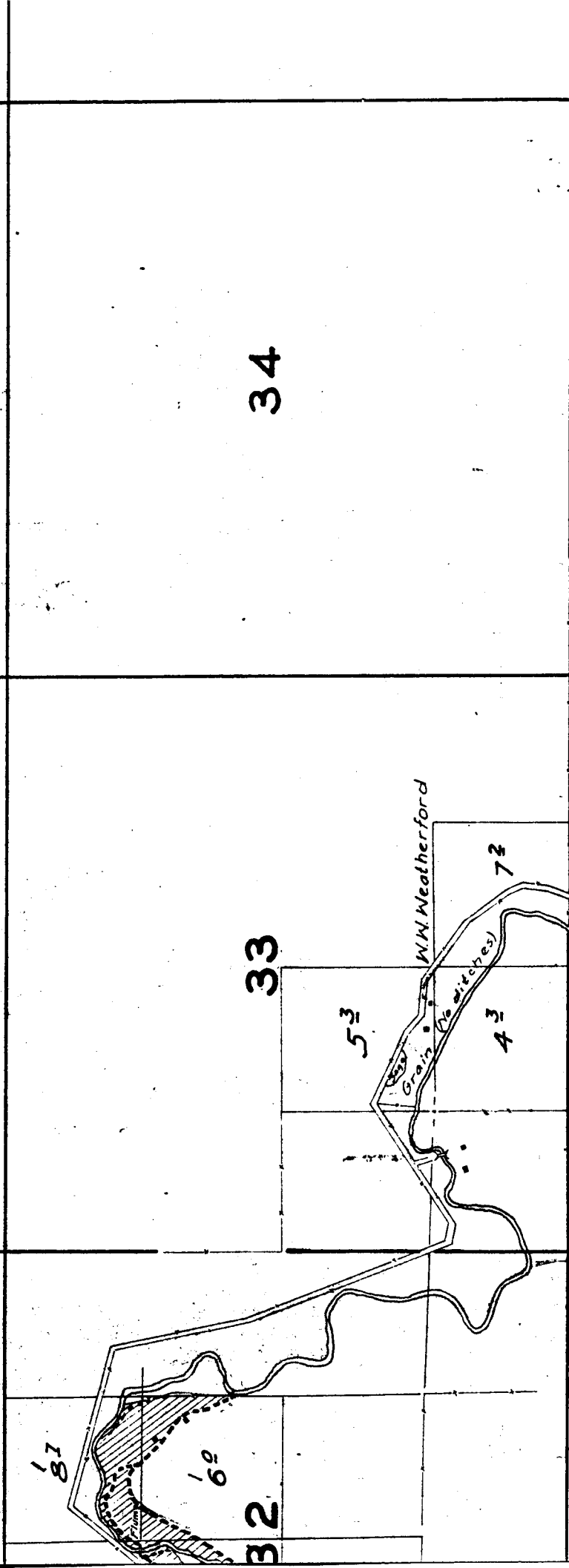

17

16

15

20

21

22

J. Stephens

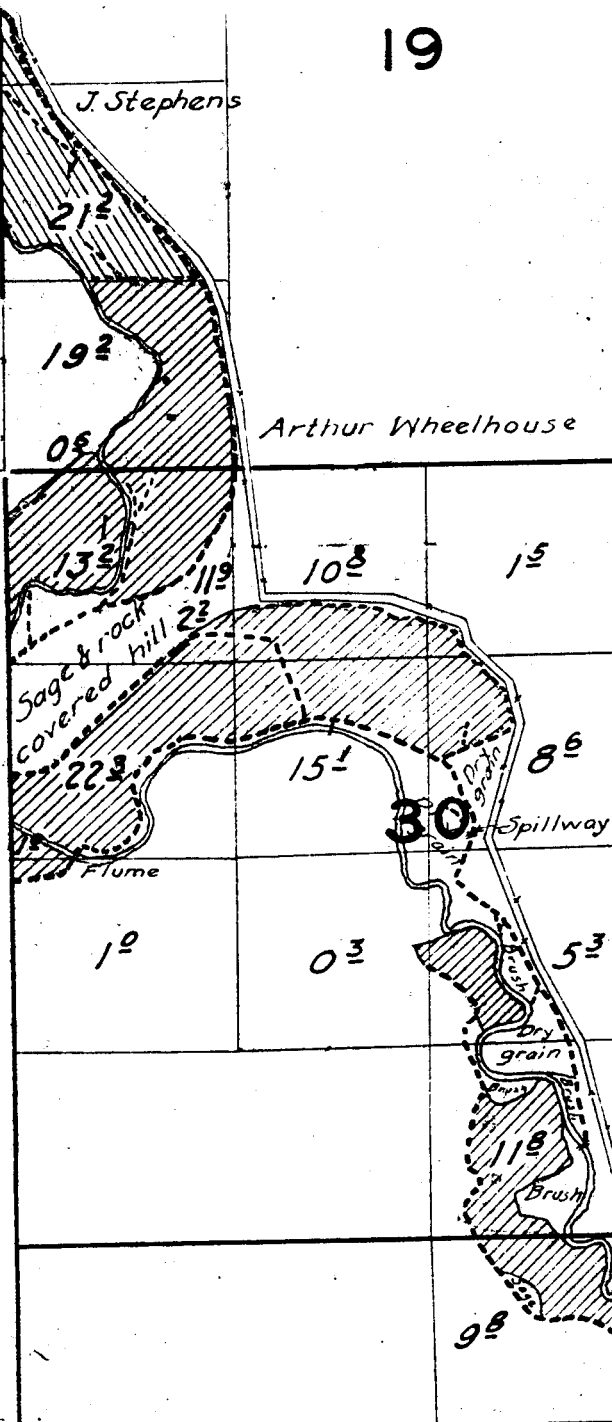

Arthur Wheelhouse

29

Note:

Streams and roads, except in the vicinity of irrigated land, are sketched in approximate location.

31

Arthur Wheelhouse

32

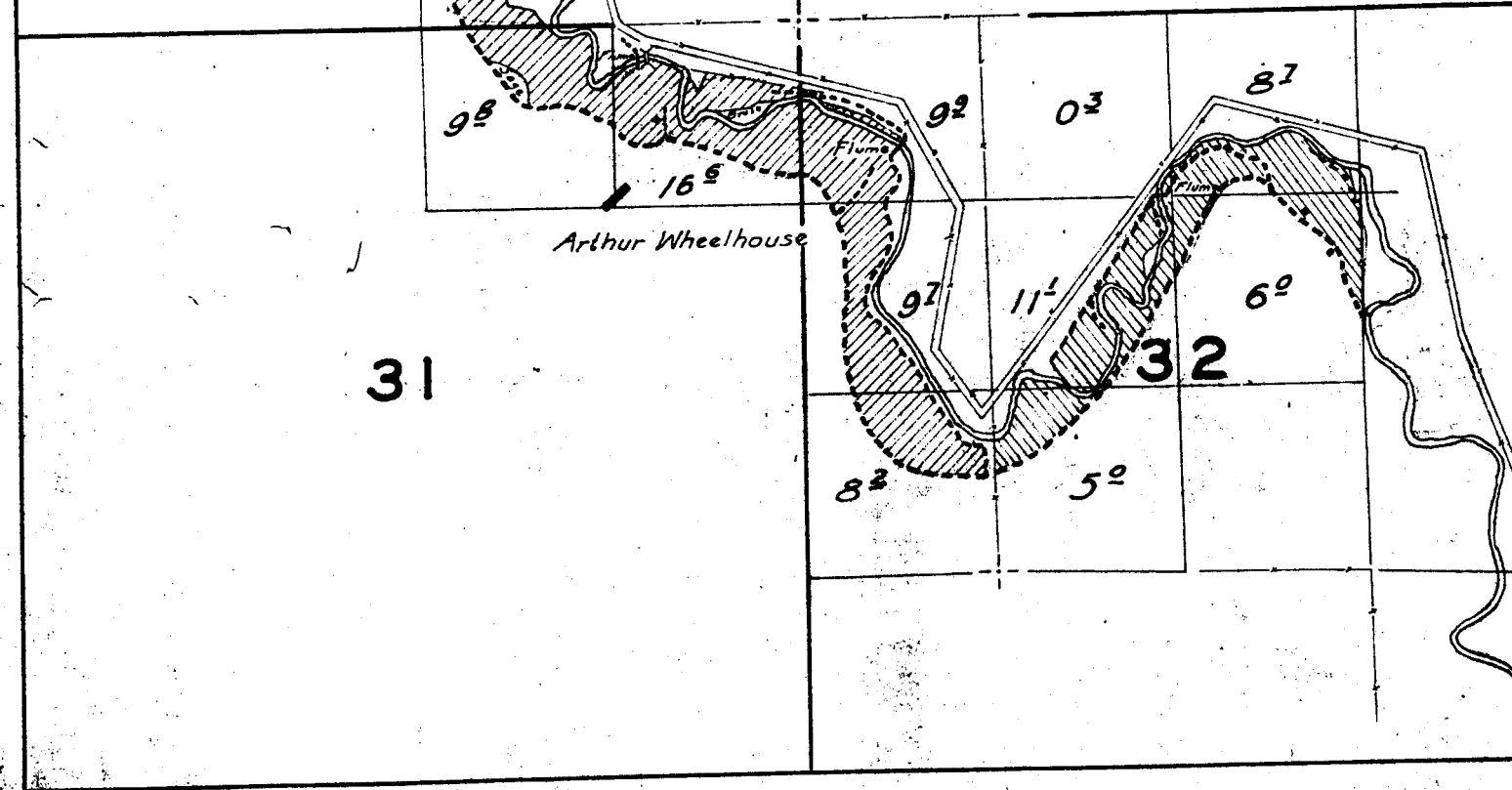

# TOWNSHIP

4	5	6
9	8	7

16

17

18

21

20

19

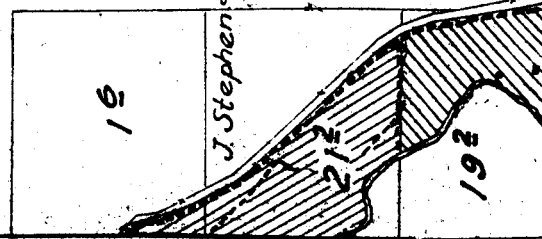

TOWNSHIP 1 N., RANGE 21 E.

4

3

9

10

16

15

23

24

26

25

35

36

ANGE 21 E.

5-2-1

3	2	1
---	---	---

10	11	12
----	----	----



15

14

13

22

23

24