

19

20

30

29

Sage Brush
MUDDY

Sage Brush
Prineville Land & Livestock
James Scott (Supt.)

31

32

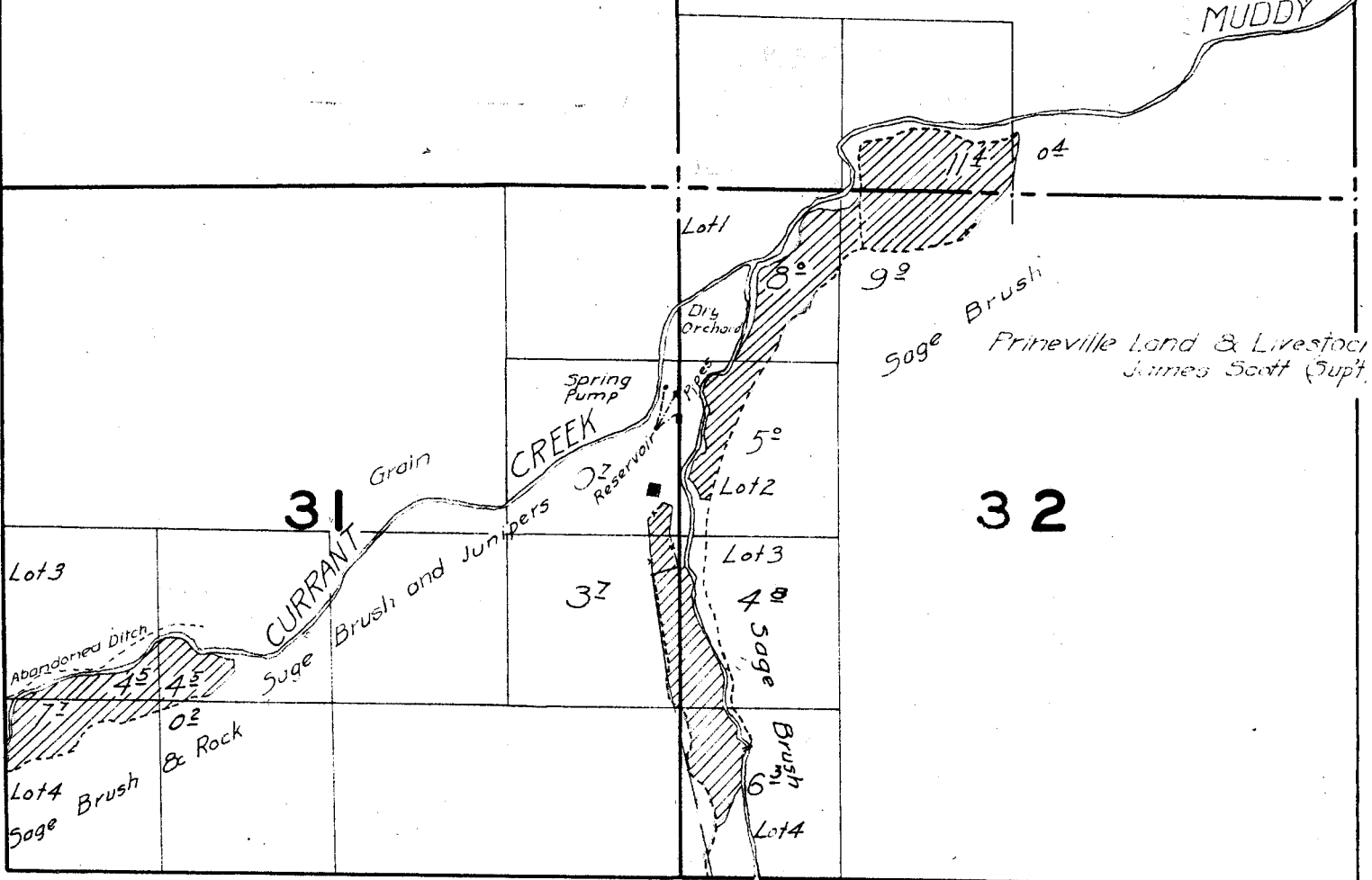

23

24

26

25

35

36

C.S. Hicks
Sub-irrigated
Farm Land

Rim Rock

4°

Sage

Brush

0°

6' Pump

Location sketched from U.S. Plats.

Location sketched from U.S. Plats.

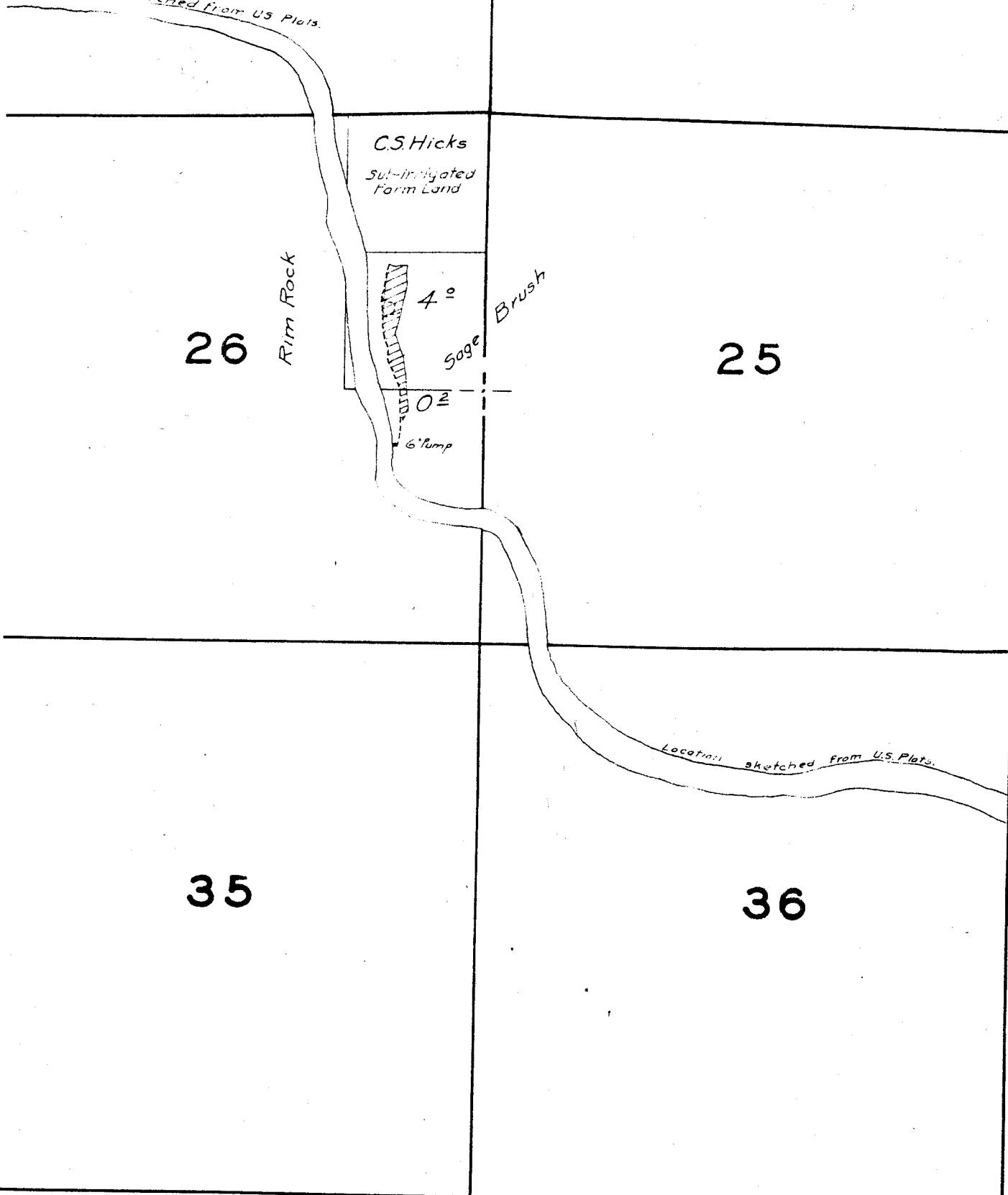

29

28

27

32

33

34

509^e *Prineville Land & Livestock Co*
James Scott (Supr)

Brush

Sage
Brush

and Junipers
CREEK

Muddy
Rim
Rock

Flume

92

04

32

15

2074

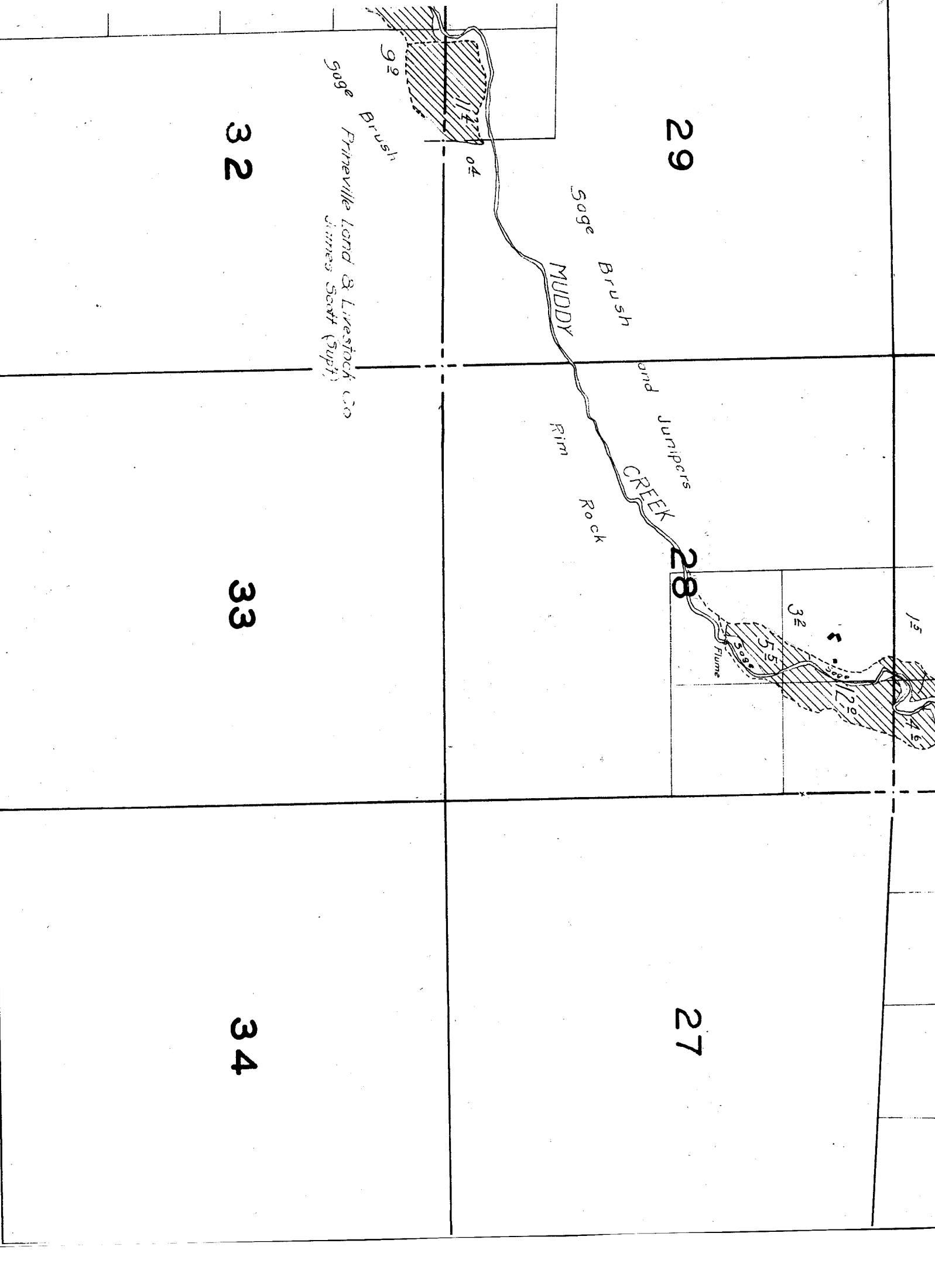

3E 19 E.

42-2-1

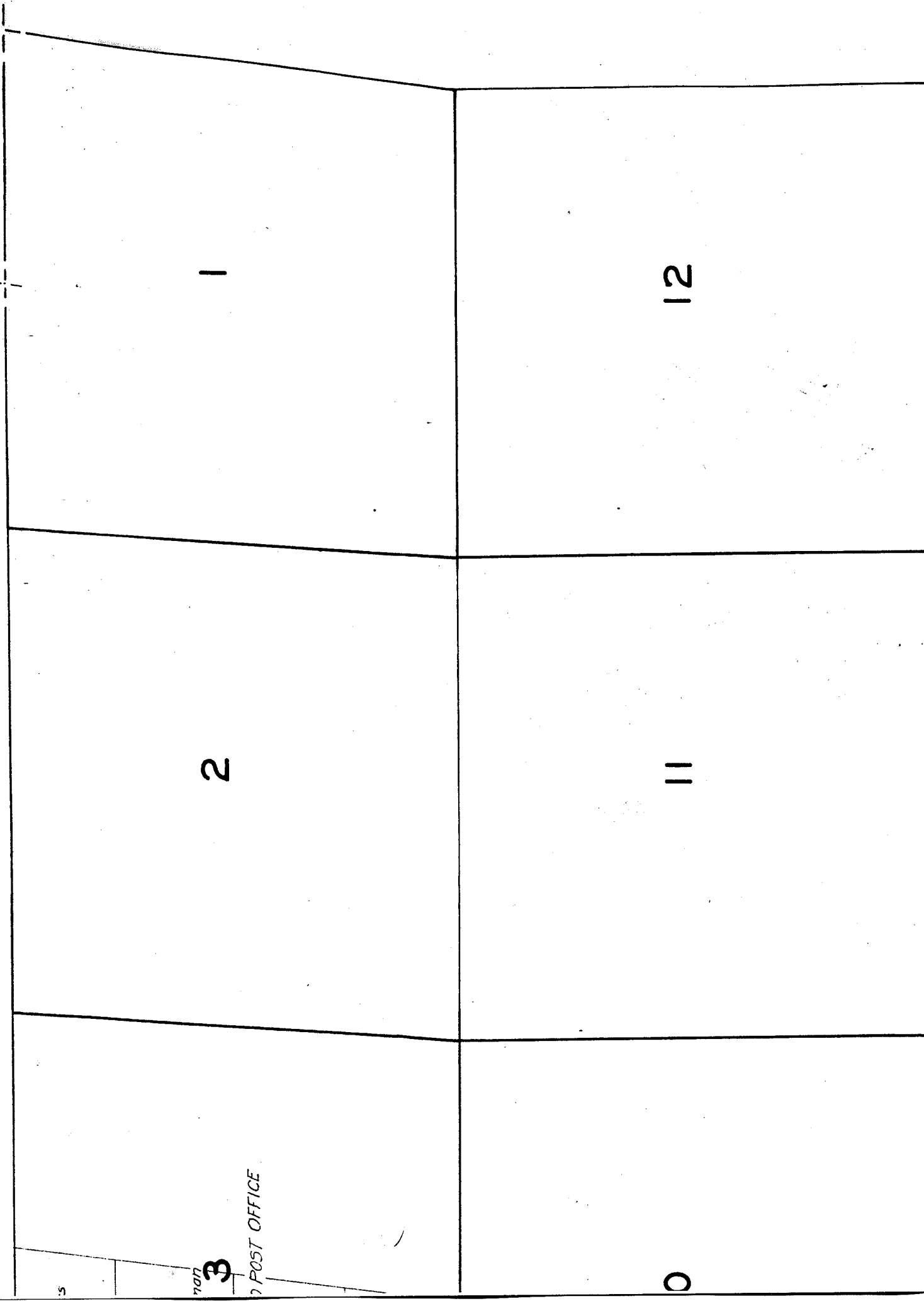

5

3

POST OFFICE

0

2

1

11

12

15

16, 17, 18, 19, & 20, 1926.

14

13

2



Sub-irrigated.

F.T. Easter

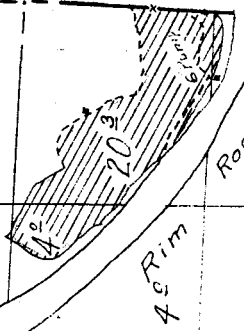

Rock 0 3

Co. Supt)

23

24

Locality sketched from US Plots.

19

20

30

29

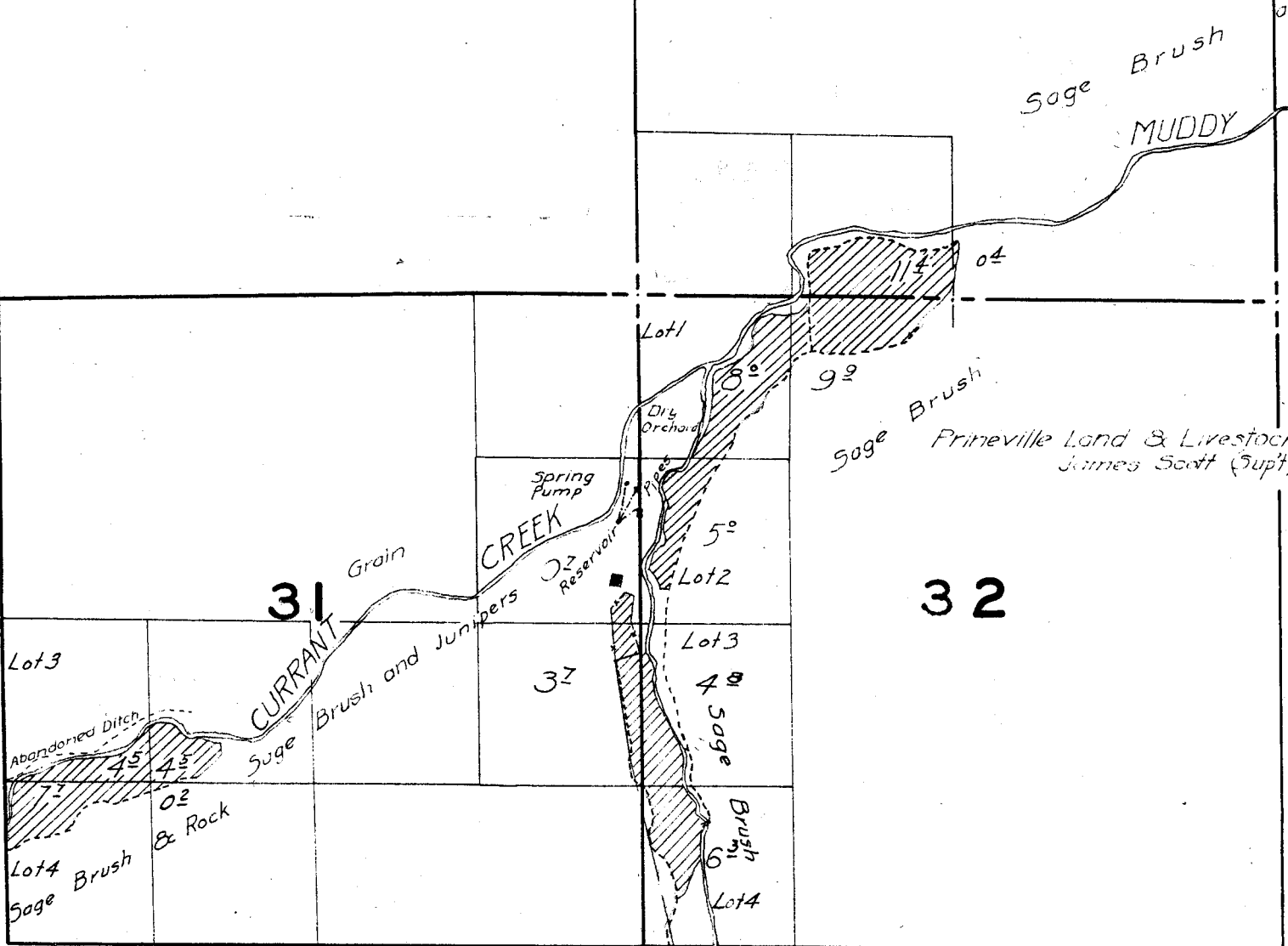

Sage Brush
MUDDY

Sage Brush
Prineville Land & Livestock
James Scott (Supt)

31

32

Lot 3

Lot 4
Sage Brush

& Rock

CURRENT CREEK
Grain
Brush and Junipers

37

Lot 1

Lot 2

Lot 3

Lot 4

Sage

Brush

Lot 4

Spring Pump

Reservoir

Dirt Orchard

Abandoned Ditch

45

45

02

80

90

50

04