

28

33

27

34

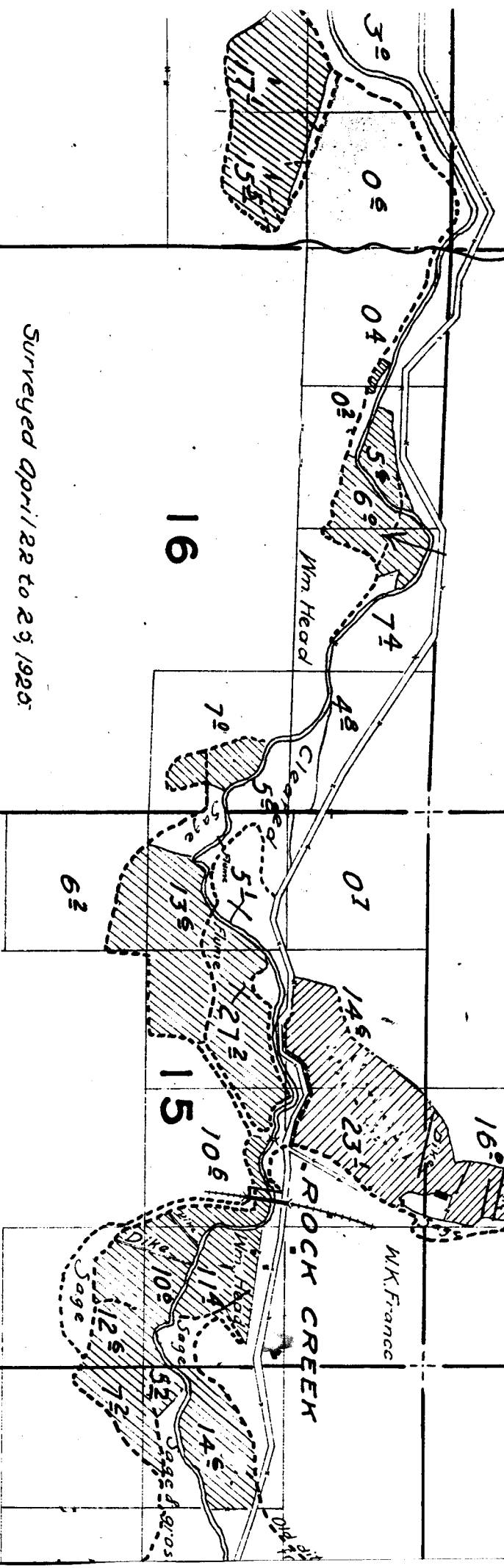

Surveyed April 22 to 23, 1920

Note:
Streams and roads except in
the vicinity of irrigated land,
are sketched in approximate
location.

21

22

19

20

30

29

02
old ditches
JOHN DAY RIVER

31

32

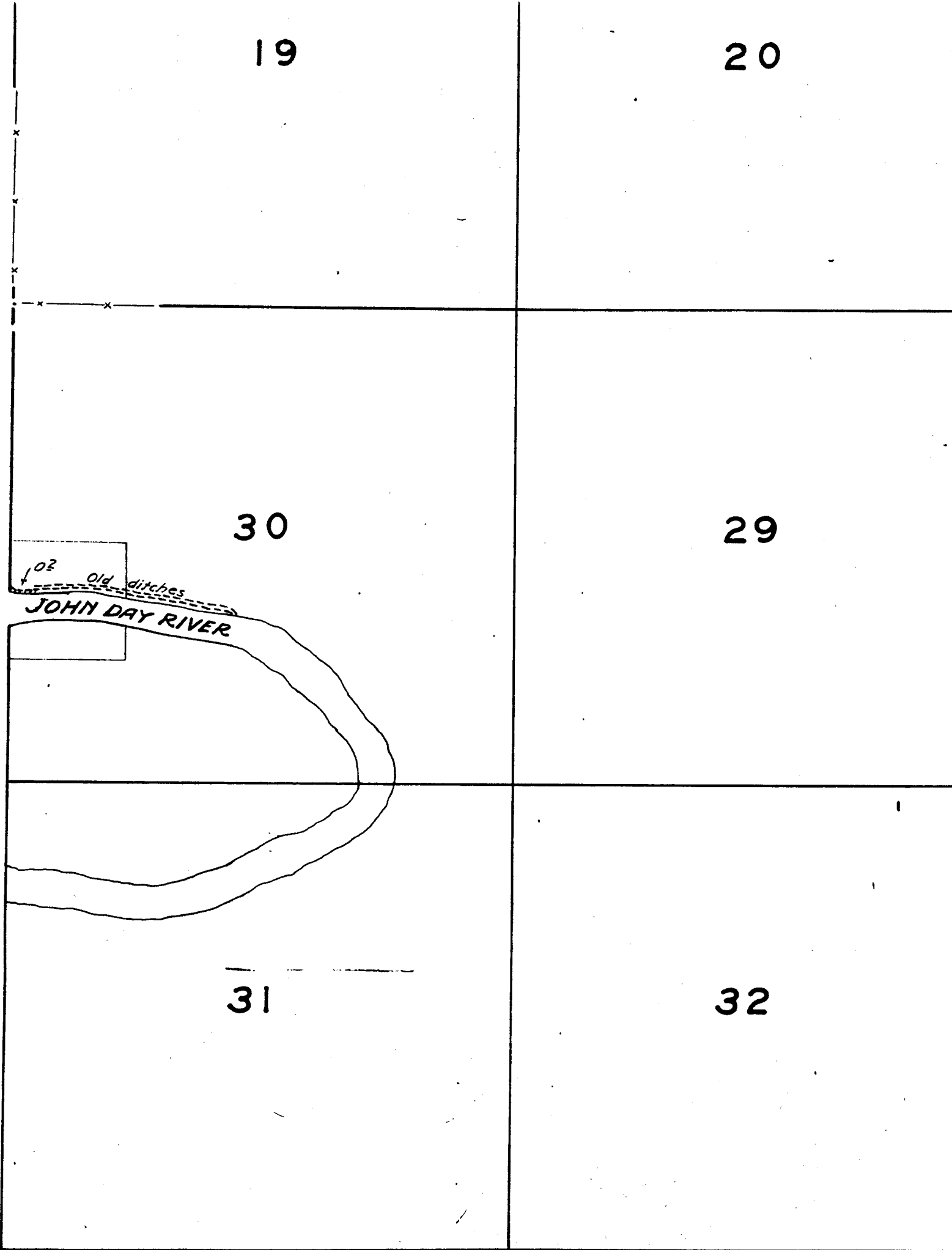

23

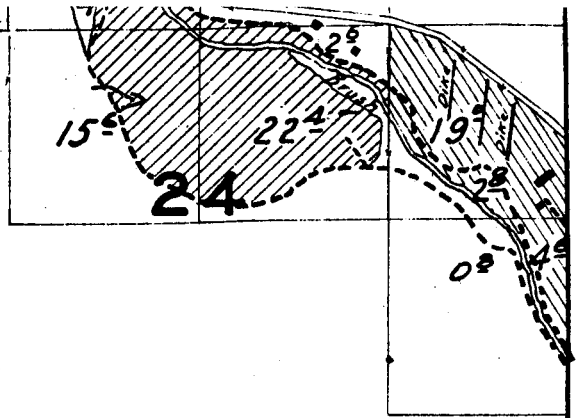

26

25



35

36

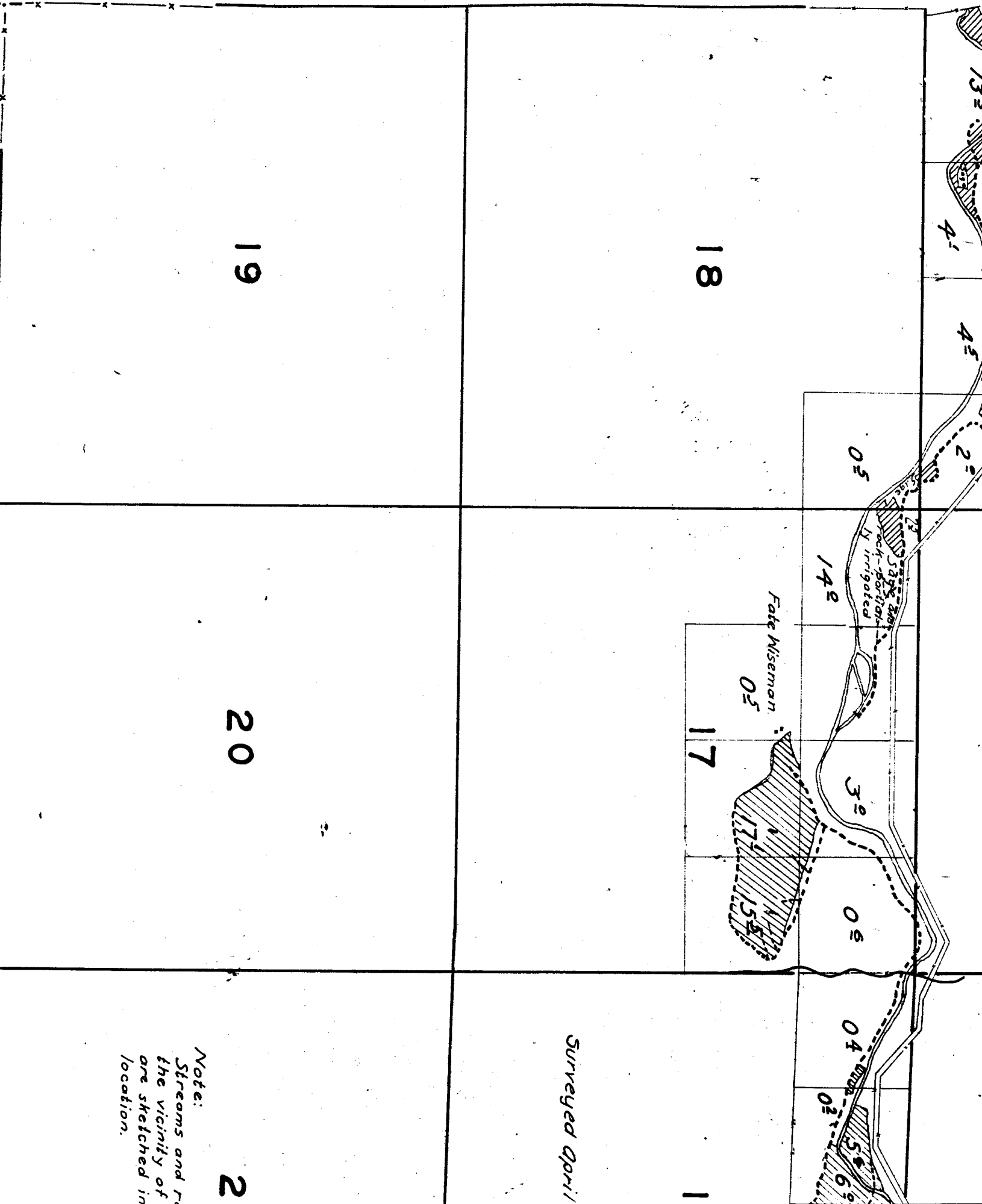

Surveyed April

Note:
Streams and rock-pool
are sketched in
location.

19

18

20

2

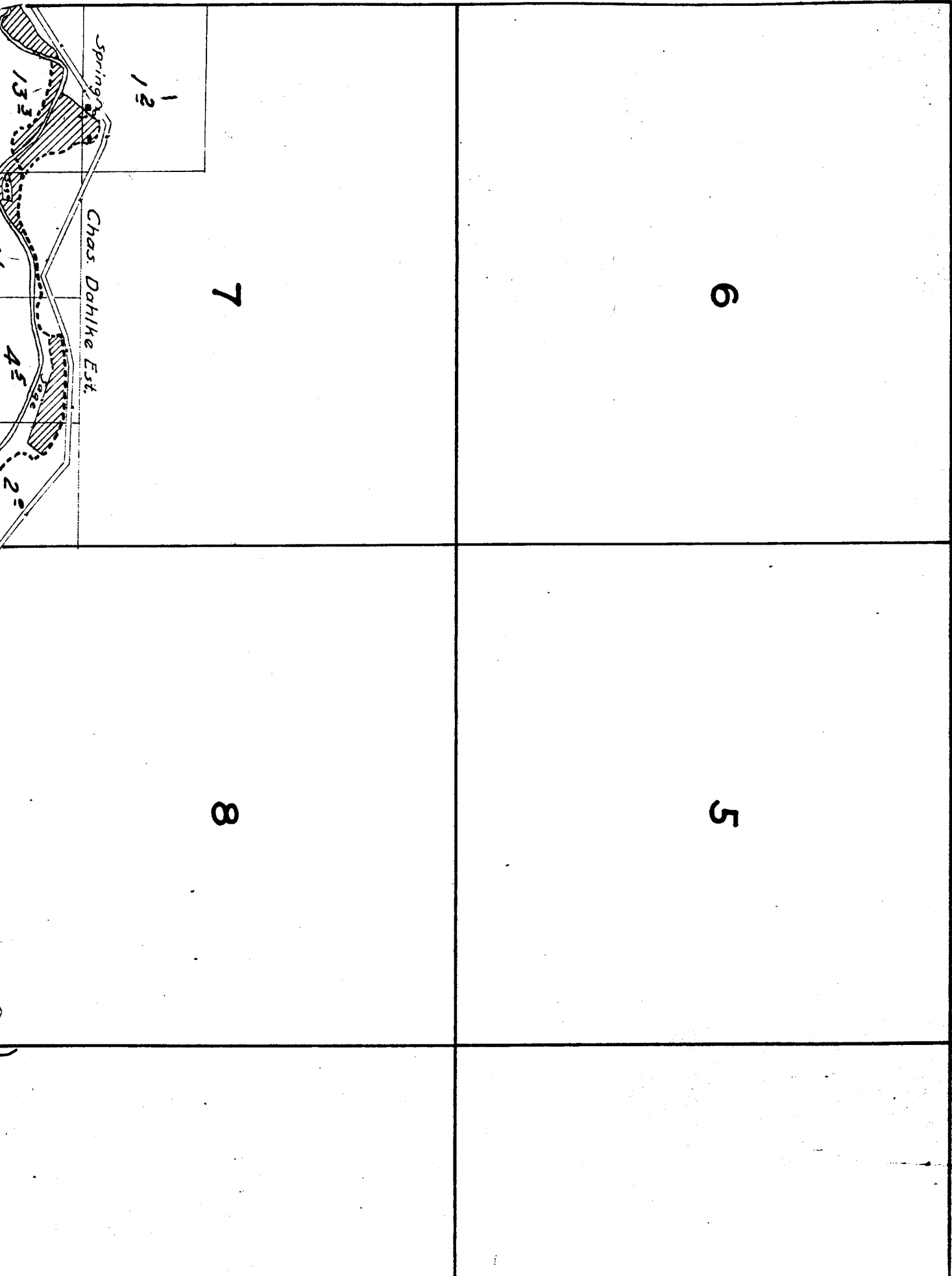

ANGE 20 E.

4-2-1

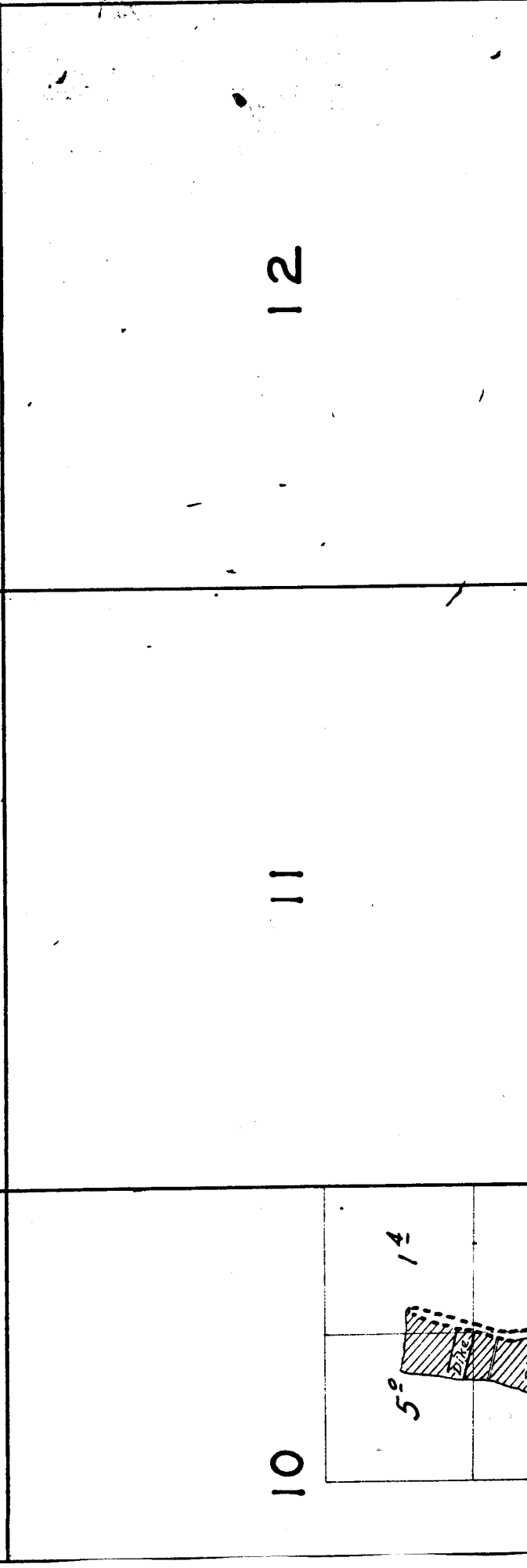
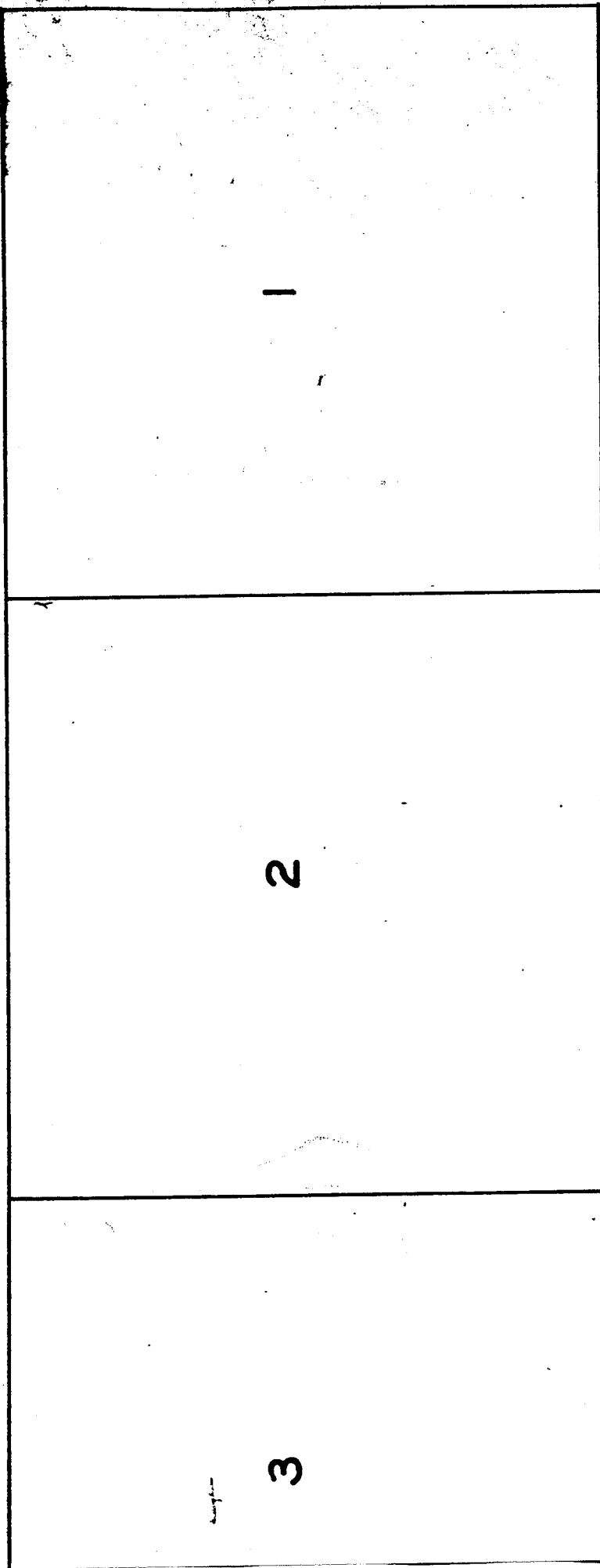

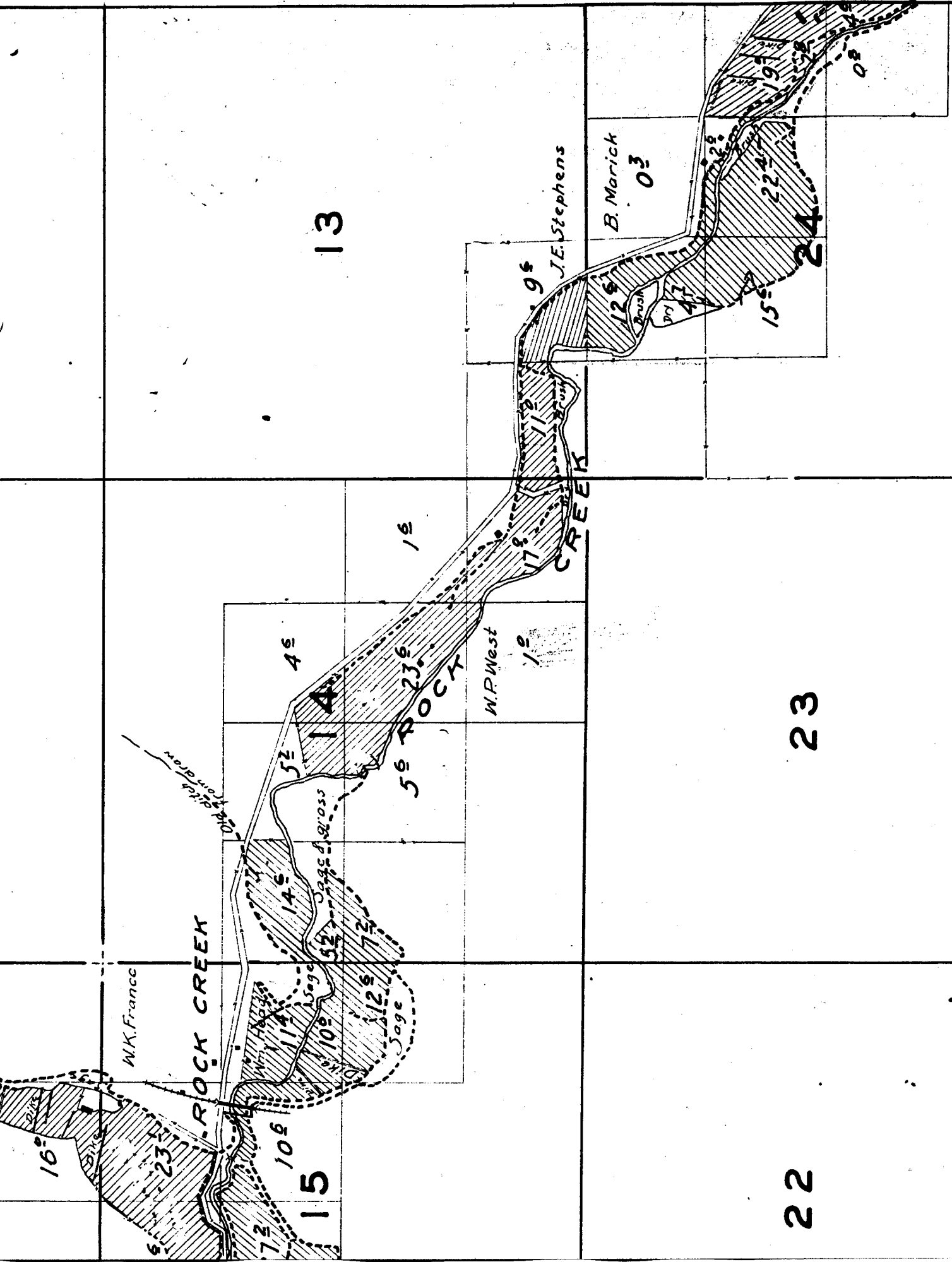

22

23

24

TOWNSHIP 1 N., RANGE 20 E

4

3

9

10

