

TOWNSHIP 1 N., RANGE 20 E

4

3

9

10

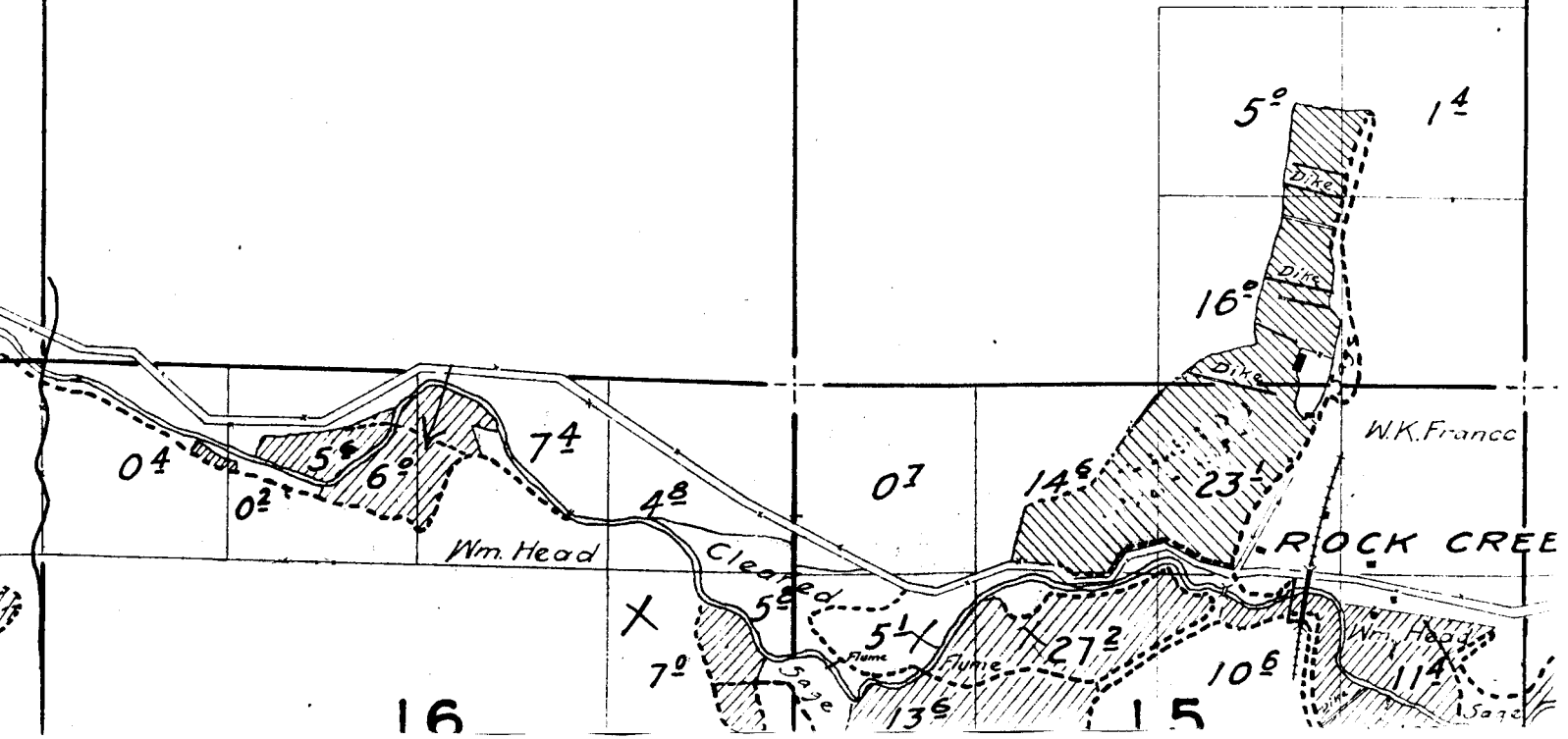

ANGE 20 E.

4-2-1

3

2

1

10

11

12

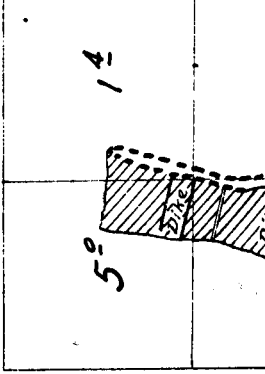

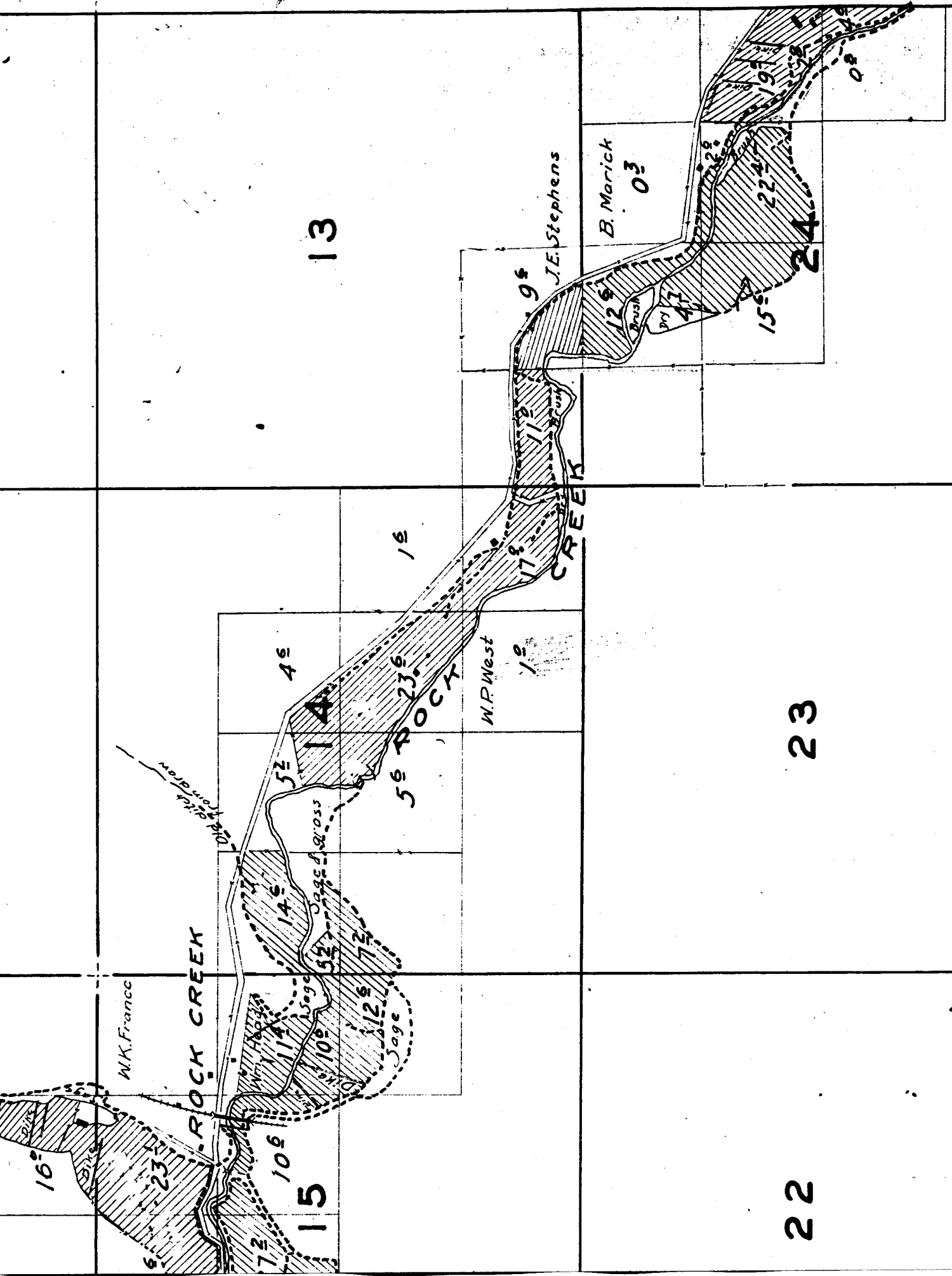

22

23

24

13

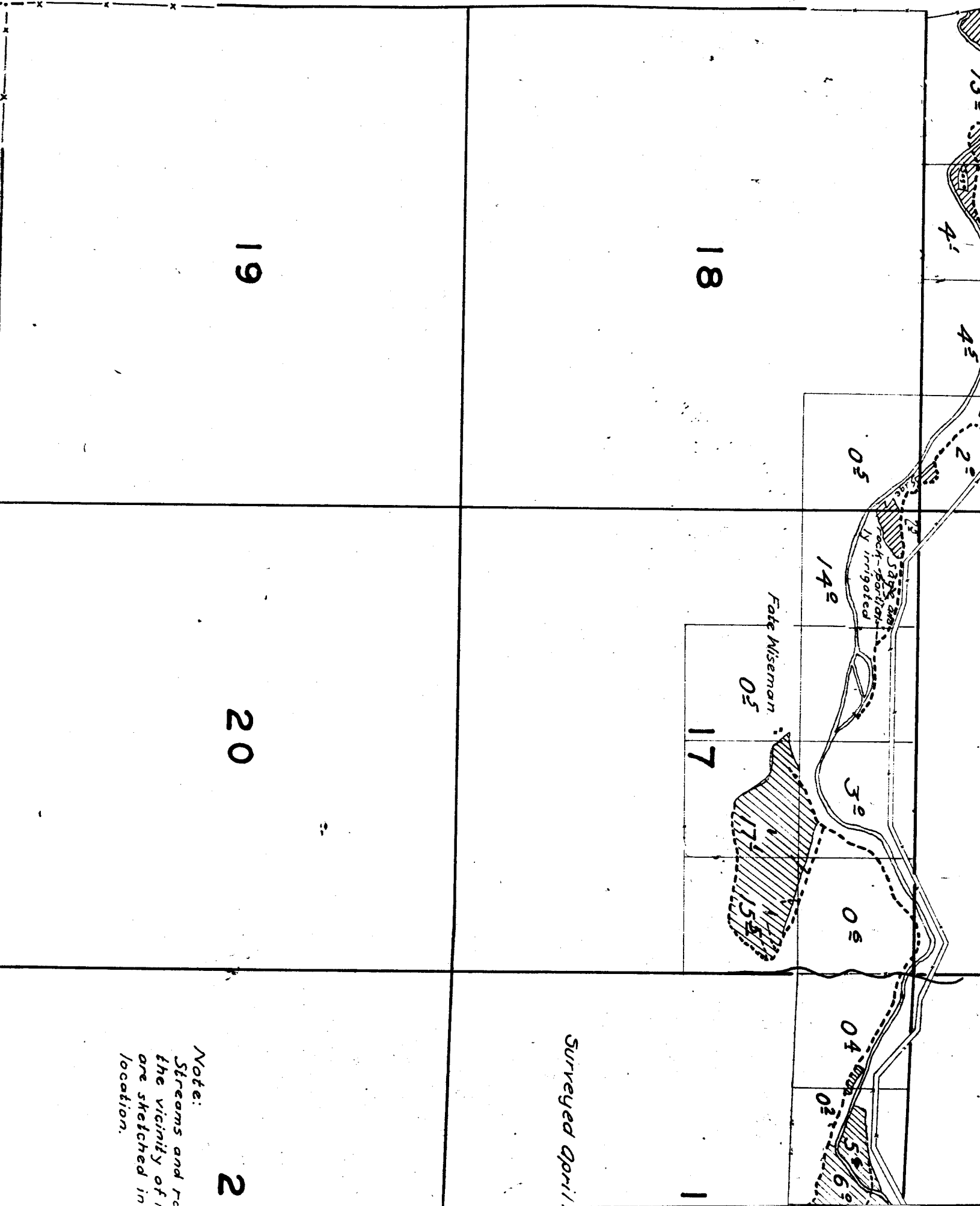

Surveyed April

19

18

20

17

2

*Note:
Streams and roads
in the vicinity of
this location
are sketched in
location.*

23

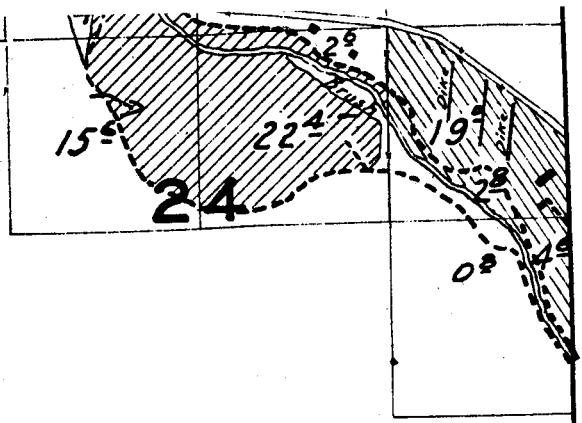

26

25



35

36

19

20

30

29

↓ 02
old ditches
JOHN DAY RIVER

31

32

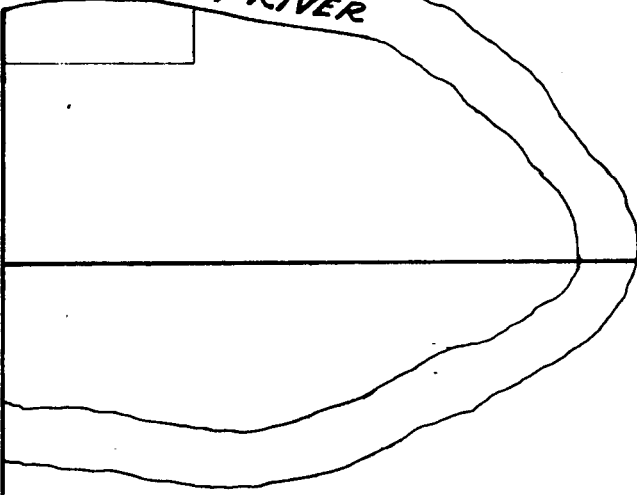

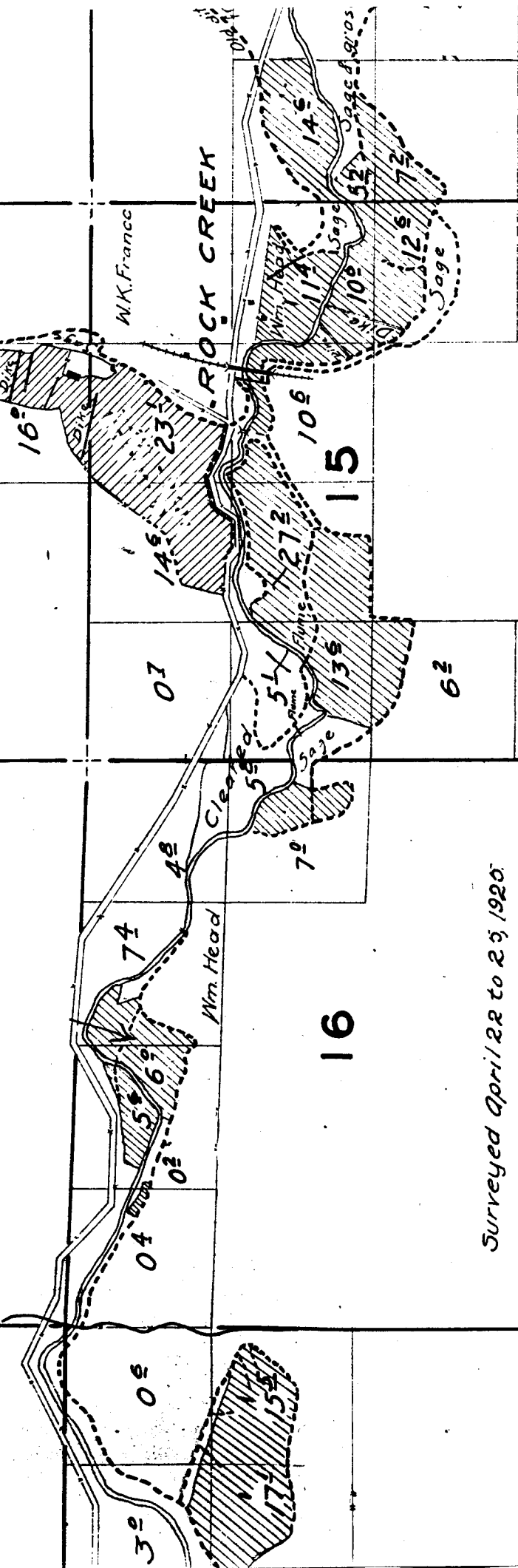

Surveyed April 22 to 29, 1920.

21

Note:
Streams and roads, except in
the vicinity of irrigated land,
are sketched in approximate
location.

22

28

27

33

34

TOWNSHIP 1 N., RANGE 21 E.

4

3

9

10

16

15

23

24

26

25

35

36

15

14

13

22

23

24

3	2	1
10	11	12

19

20

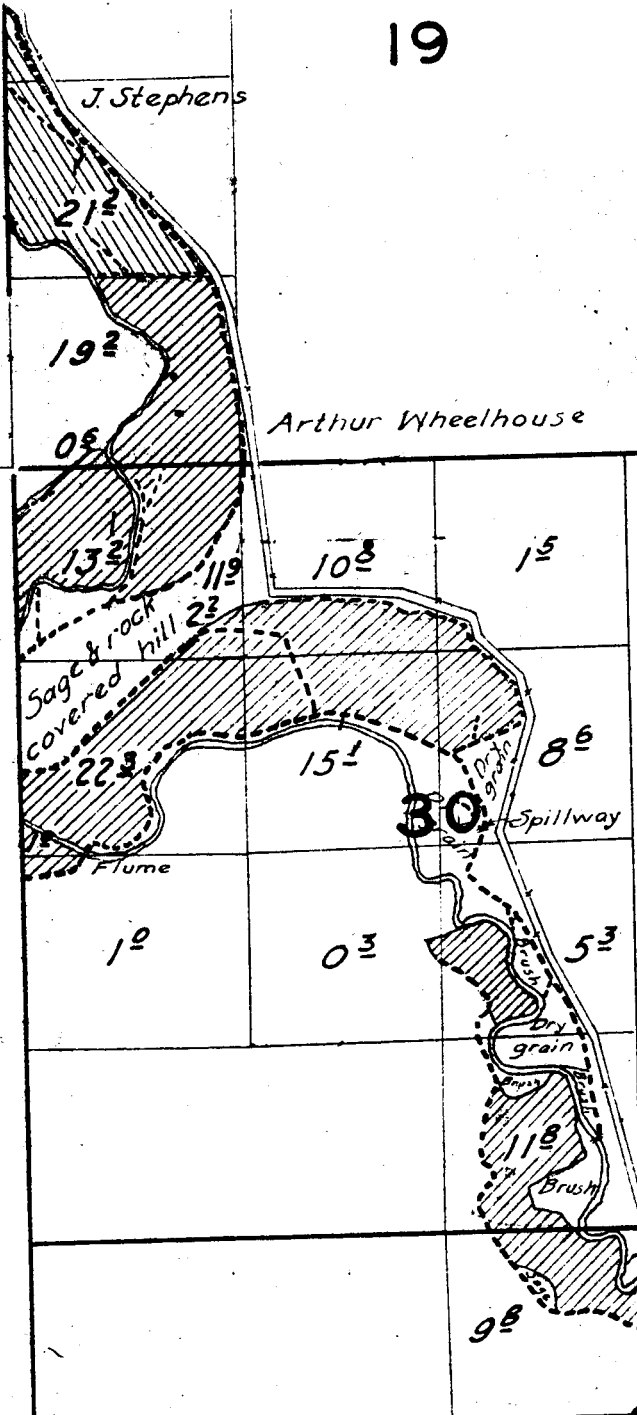

29

Note:

Streams and roads, except in the vicinity of irrigated land, are sketched in approximate location.

31

Arthur Wheelhouse

32

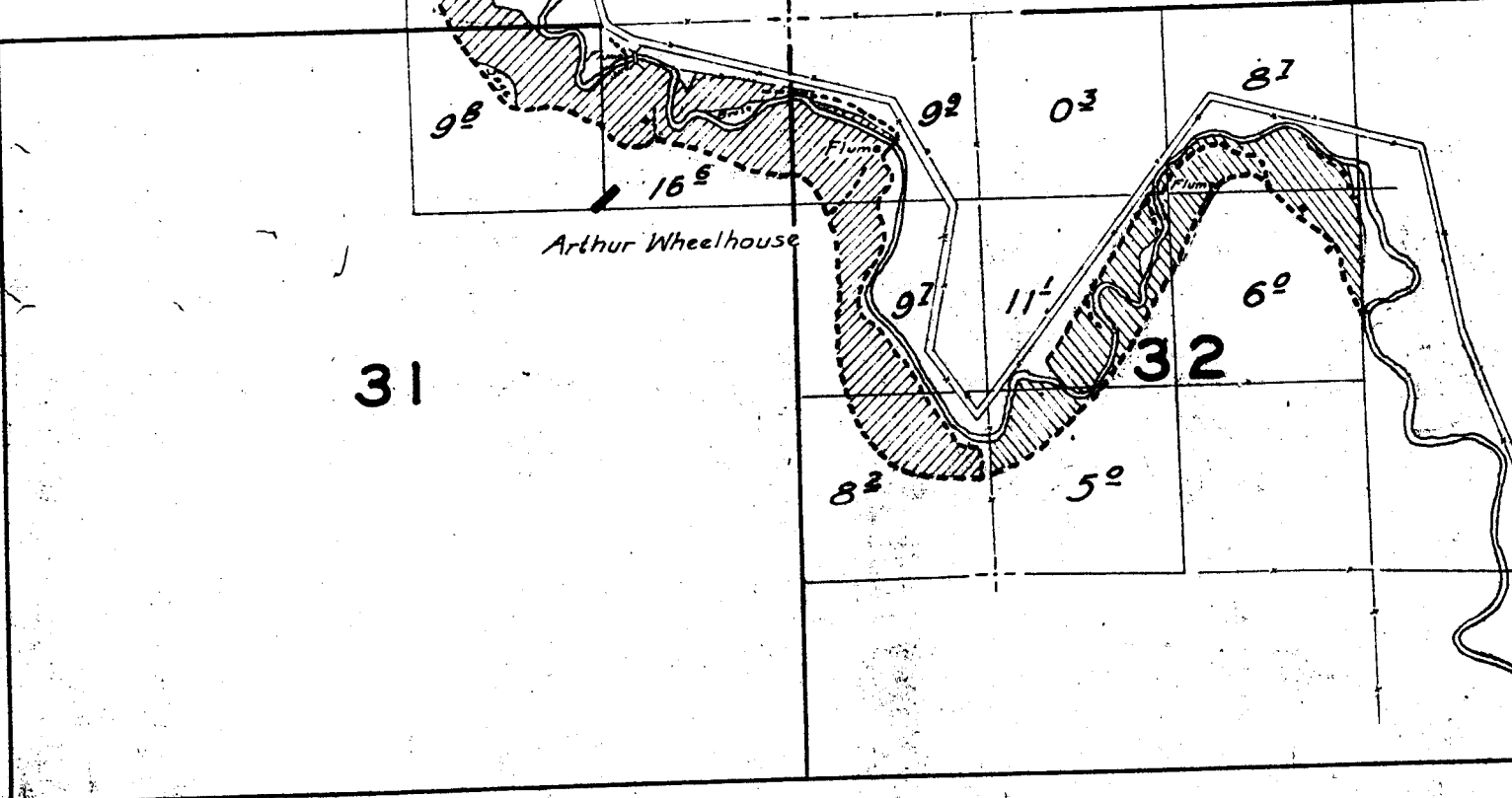

17

16

15

20

21

22

29

roads, except in
of irrigated land,
d in approximate

28

27

Surveyed April 28 and 29, 1986.

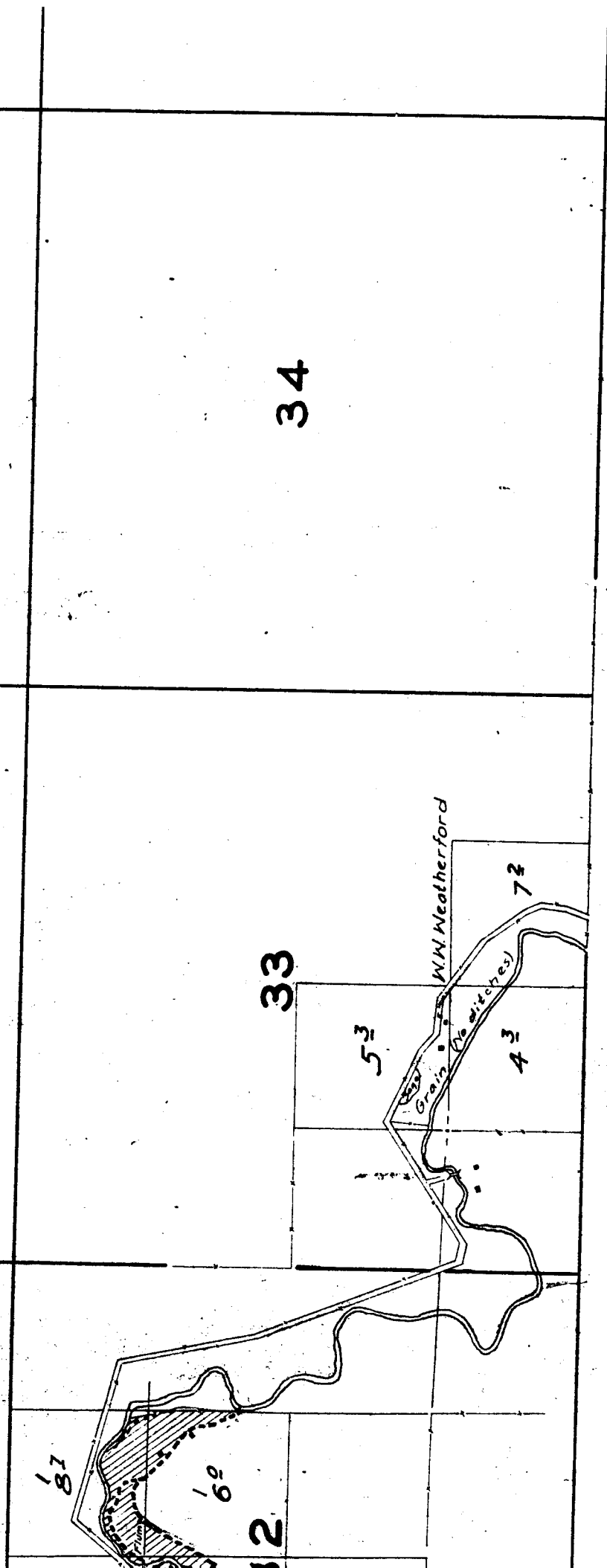

34

33

187

169

112

53

43

72

NW Weatherford

Grain No. 100

TOWNSHIP

6	5	4
7	8	9

16

17

18

21

20

19

