

# MAP

To accompany the application of the Chewacan Land and Cattle Company to appropriate water from Long Creek for irrigation purposes.

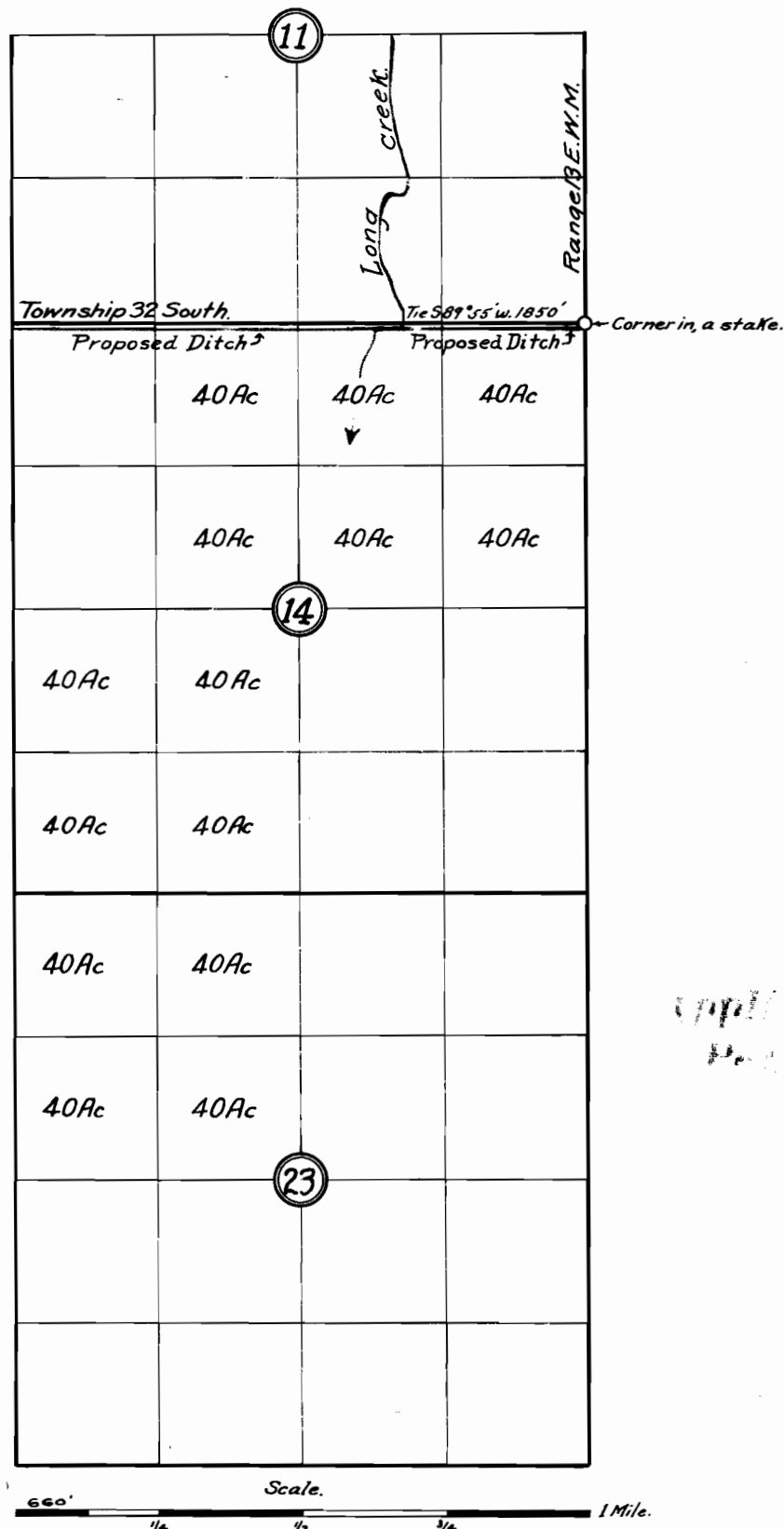

JUN 3 1921  
SALMON, OREGON

APPLICATION No. 7916  
Parcel No. 25658

I, R. H. Rogers, of Lakeview Oregon do hereby certify that this map was made from notes taken during an actual survey made by me on May the 26th 1921, and that it correctly represents the works described in the accompanying application, together with the location of streams and other ditches in the immediate vicinity, and has written thereon the area in each smallest legal subdivision which it is proposed to irrigate.

*R. H. Rogers*  
County Surveyor for Lake County Oregon.