

T. 38S. R. 9E. W.M.

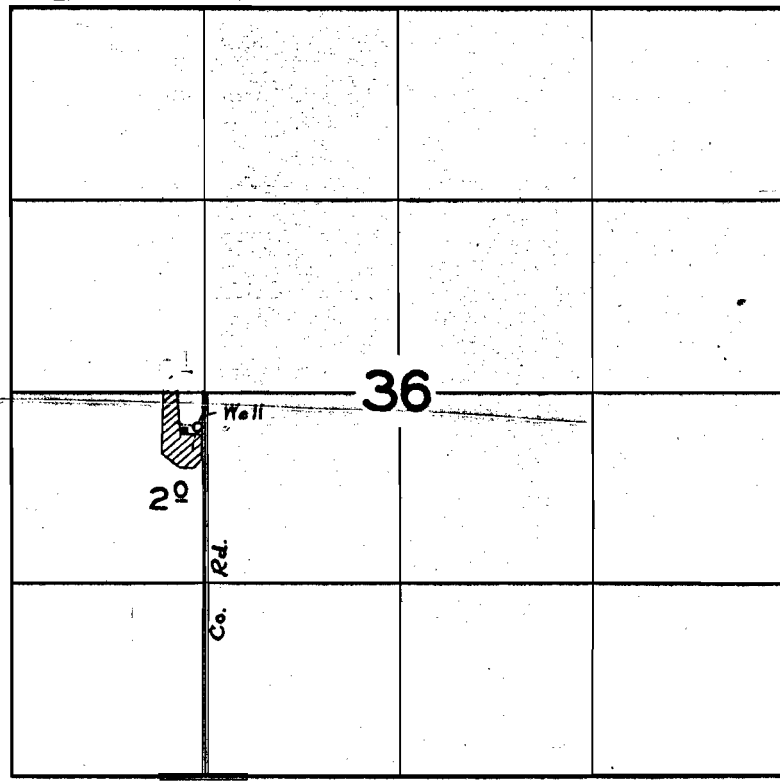

Klamath River weedy

FINAL PROOF SURVEY
UNDER

Application No. U-831 Permit No. U-740
IN NAME OF

Dr. Raymond Tice

Surveyed May 6 1958., by C.O. Smith

See Letter From
Jamie 2/22/73
Cancellation File in