

27122 U-266  
27121 U-220

# T.39S.R.11 1/2 E.W.M.

Bucke Crk: Yonma Valley wells

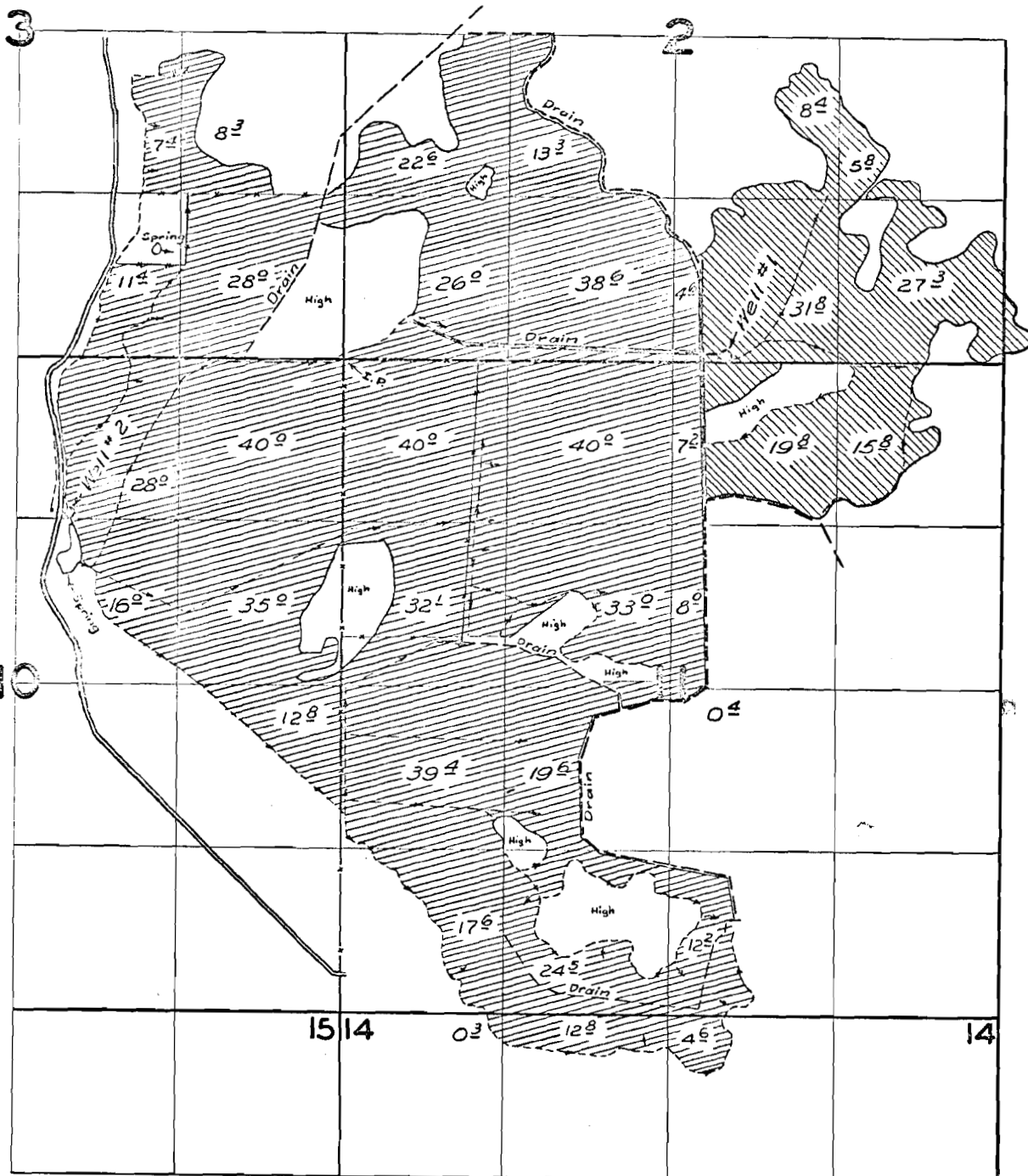

## FINAL PROOF SURVEY

UNDER

Application No. U-246 ... Permit No. U-220  
U-293 ... U-266

IN NAME OF

L. J. HORTON & ANNE S. HORTON

Surveyed 16 Oct. 19 59, by M. B. Bick