

T.41 S.R.12 E.W.M.

Just W. wells

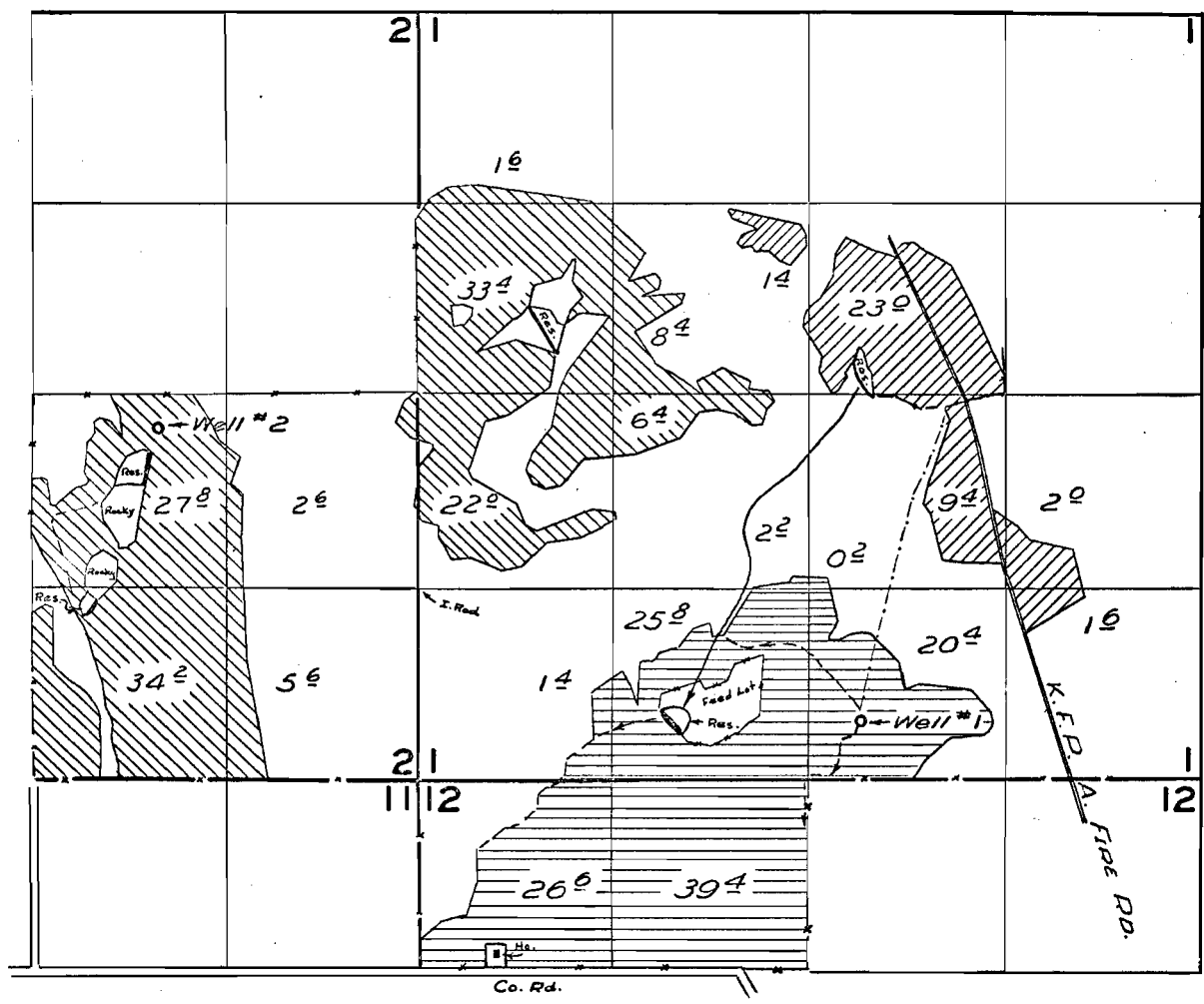

- U-483 Well #1 [diagonal lines]
- G-221 Well #1 [horizontal lines]
- G-221 Well #2 [vertical lines]

FINAL PROOF SURVEY

UNDER

Application No. U-483 Permit No. U-468
G-221

IN NAME OF

JERRY V. & HELEN M. RAJNUS

Surveyed 22 Oct. 1959, by M. B. Rich