

T.41 S.R.12 E.W.M.

Just River wells

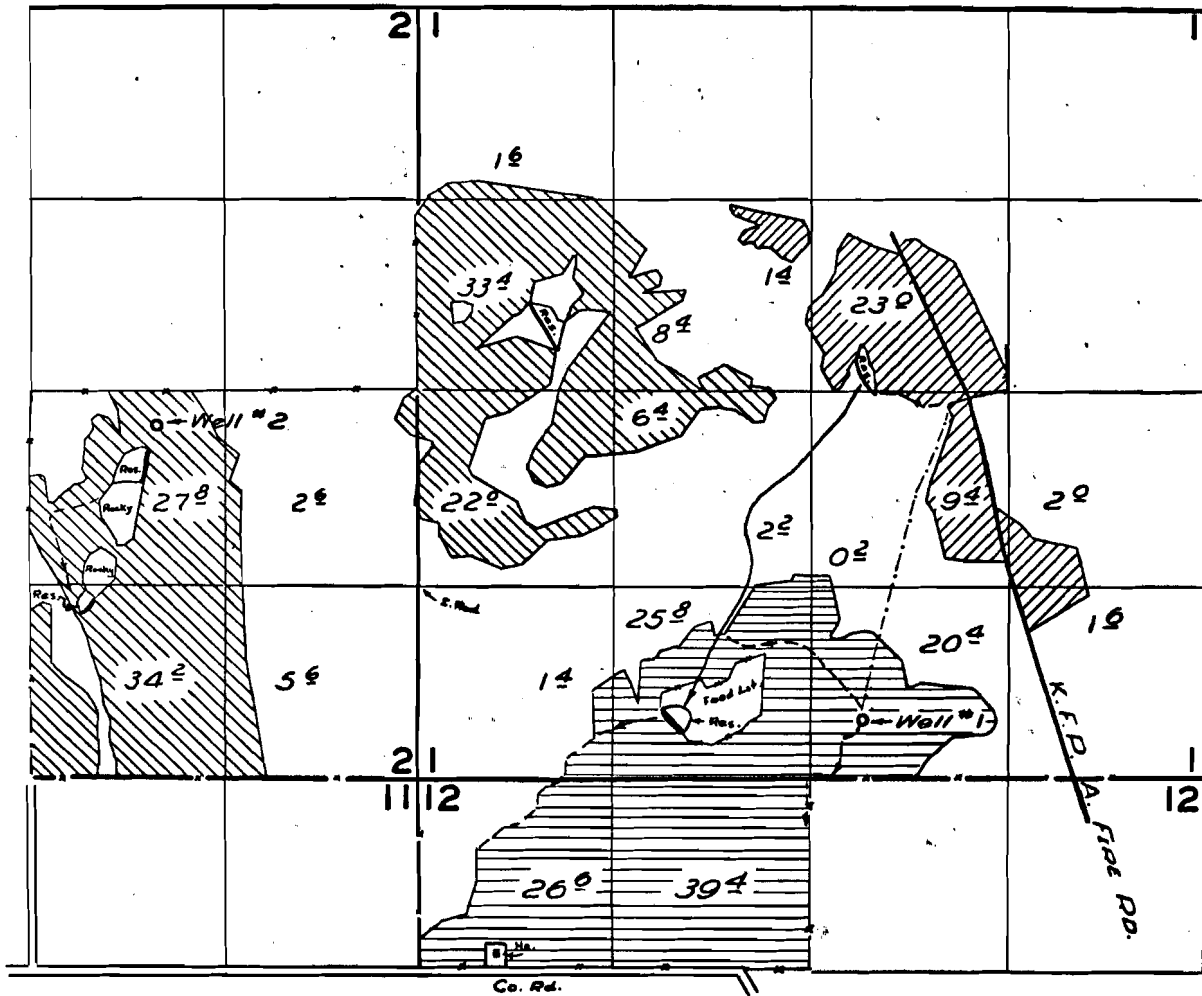

U-483 Well #1 
 G-221 Well #1 
 G-221 Well #2 

FINAL PROOF SURVEY

UNDER

Application No. U-483 Permit No. U-468
G-221 G-138

IN NAME OF

JERRY V. & HELEN M. RAJNUS

Surveyed 22 Oct. 1959, by M. B. Siche