

Note: Between Broadway and Court Ave., 20th St., 21st St. and Alley of Block 31 are Vacated.

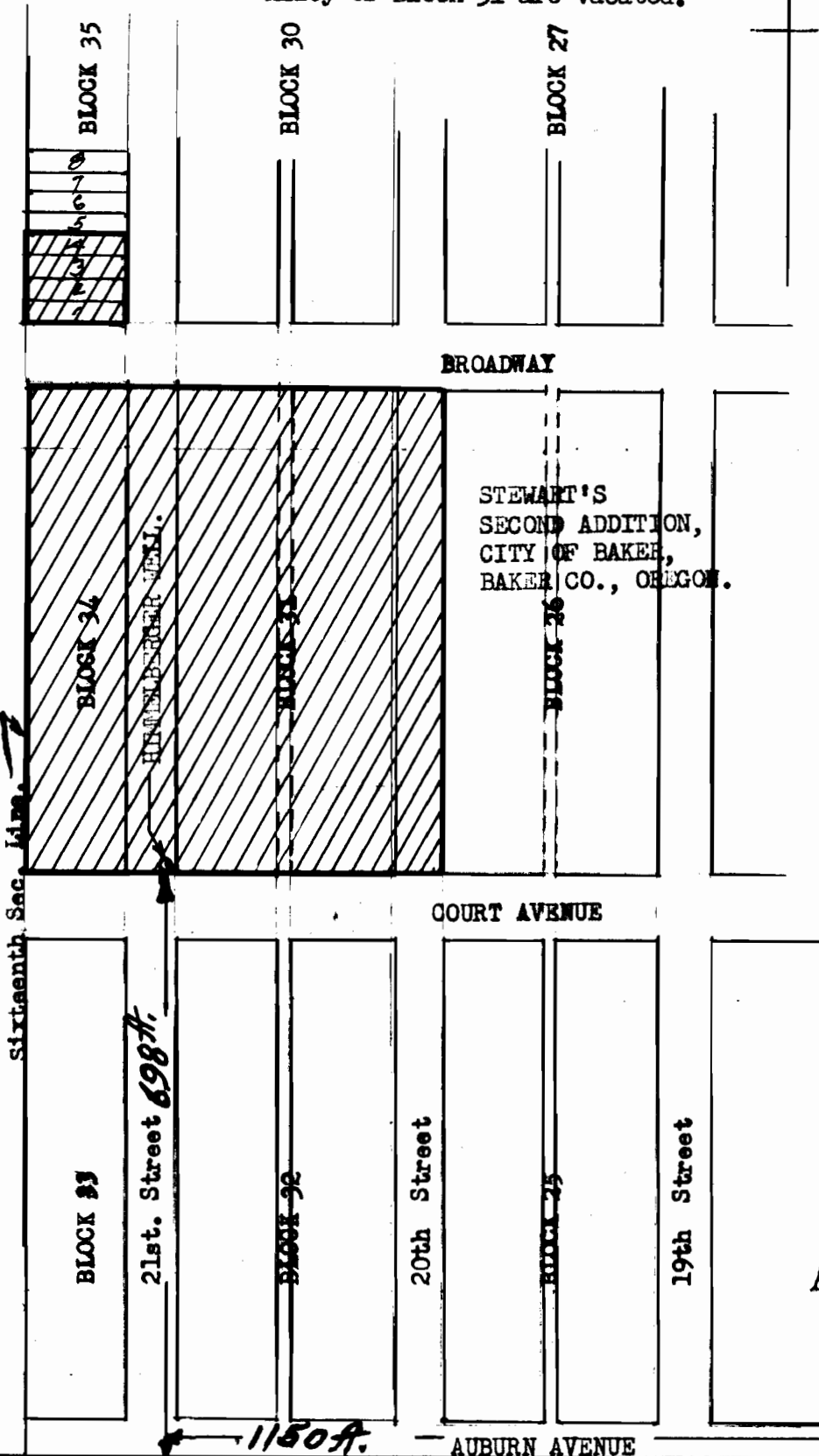

I, Philo H. Anderson, of Baker, Oregon, certify that this map was made from notes taken during an actual survey made by me July 13 1957, that the pump in place constitutes a monument, and that the section corner indicated hereon is marked by a stone and an iron pipe 1 1/2" diameter driven into the ground to the surface thereof.



MAP TO ACCOMPANY APPLICATION FOR PERMIT TO APPROPRIATE WATER FOR IRRIGATION PURPOSES, John Himmelberger, Applicant, of 3815 Broadway, Baker, Baker Co., Oregon. Well is in SE 1/4 Sec. 18, T. 9 S., R. 40 E., W. M., within the City of Baker, Baker County, Oregon. Scale of map: 1" = 200'. R.F. 1/2400. Irr. Area - 6.81 ac.

Application No. G-739
Permit No. G-635

T. 9 S., R. 40 E.,
W. M., Oregon.