

Map accompanying the application, by L.C. Wampler, for a permit to use Public Water for irrigation, domestic and stock water on land area located in the SE<sup>4</sup> of NE<sup>4</sup>; and NE<sup>4</sup> of SE<sup>4</sup>; Sec. 25, T36 S.R. 6 E.W.M., Klamath County, Oregon.

Upper Klamath Lake in view

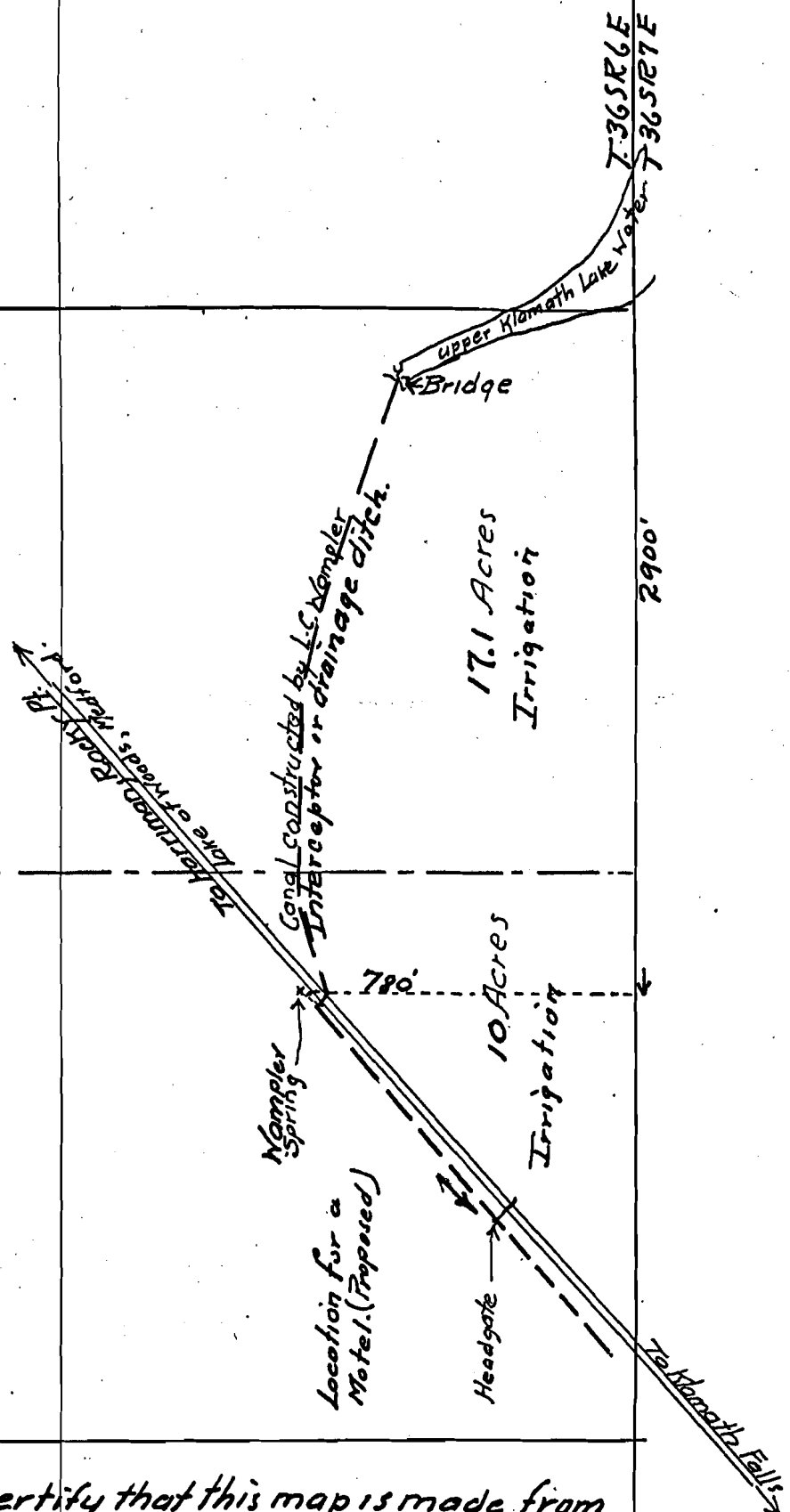
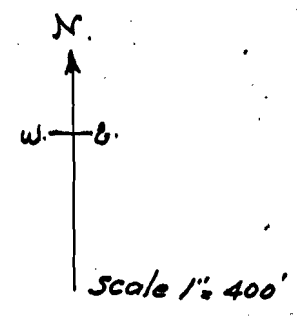

*C.T. Darley*

I, C.T. Darley, do hereby certify that this map is made from notes taken during a field survey made by me in August 1954 and that it correctly indicates the location of existing ditches and the land area on which the water pertenant to this application is now used; also the approximate location for the proposed application for domestic use. Signed *C.T. Darley* Application No. 29406

Permit No. 23160