

SCALE: 1"=50'

SOUTH SOUTHEAST CORNER
EUGENE SKINNER
D.L.C. NO. 64, T17S,
R3W, W.M.
(BRASS PLATE SET IN CONC.)
IN N.E. 1/4 OF SEC. 31,
T17S, R3W, W.M.

PEARL ST.

EAST BROADWAY

NORTH 540.47'

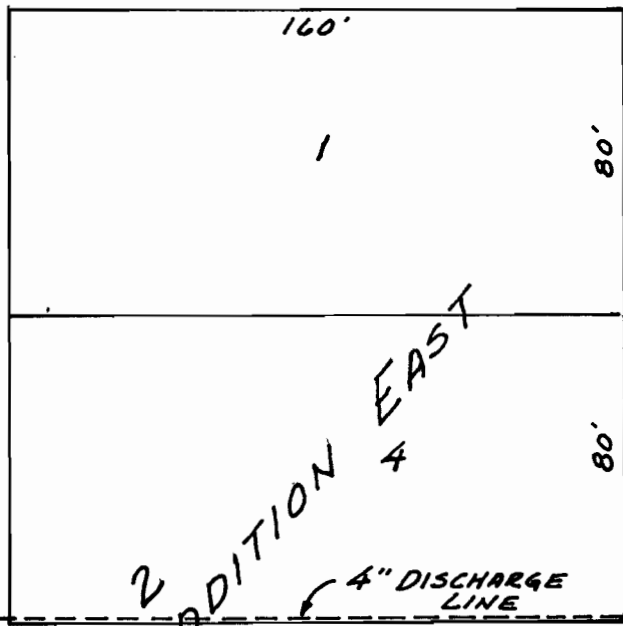
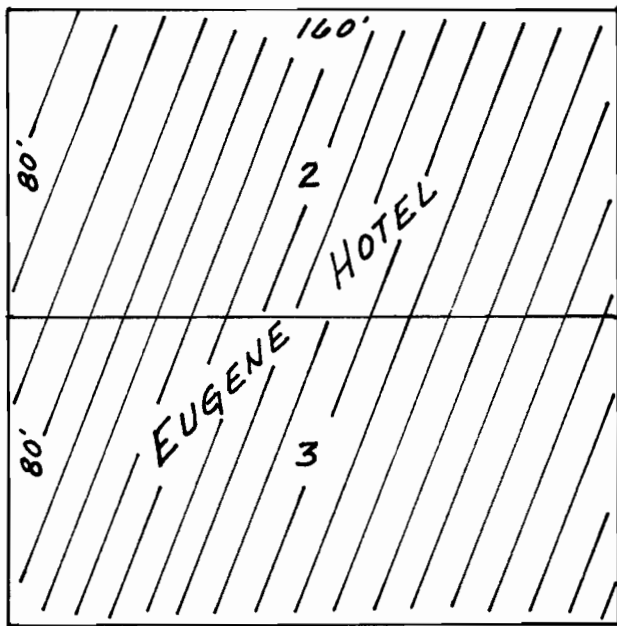

4" DISCHARGE LINE

14 FT. ALLEY 183.6'

10" WELL,
120' DEEP
WITH SUBMERGED
20 H.P. PUMP
(MULTI-STAGE)

BLOCK
MULLIGAN'S

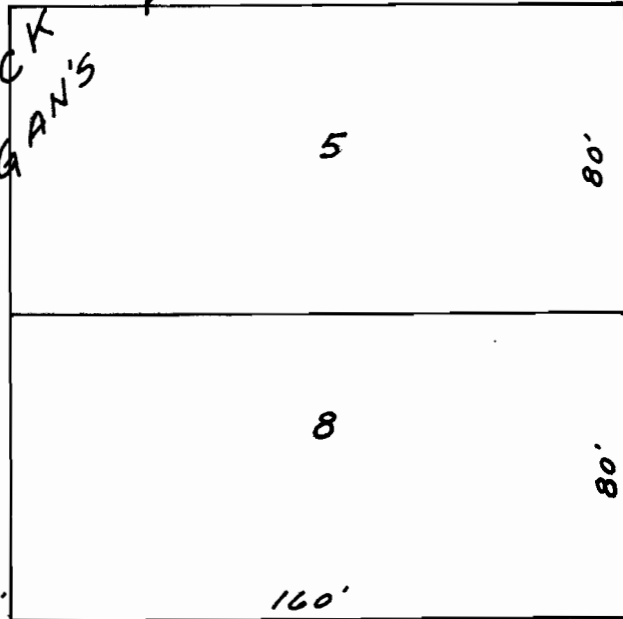
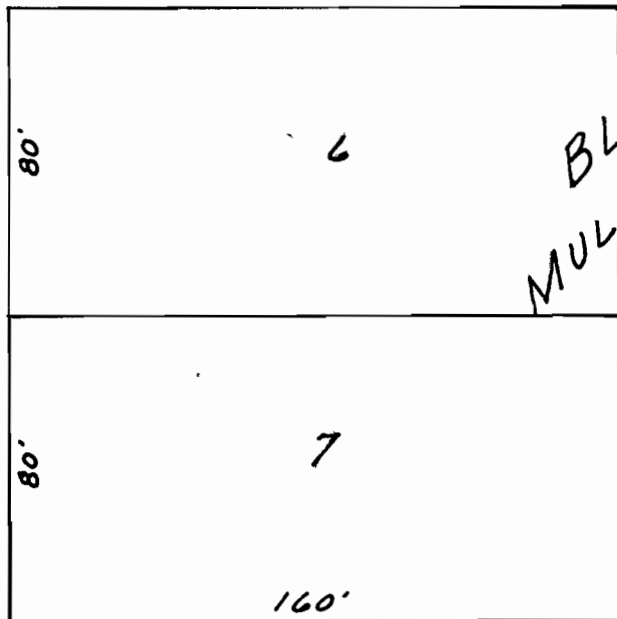

EAST 10TH AVE.

HIGH ST.



WELL LOCATION MAP
FOR EUGENE HOTEL
EUGENE, OREGON
SEC. 31, T17S, R3W, W.M.
LANE COUNTY, OREGON
WESTERN ENGINEERING CONSULTANTS
110 EAST 12TH AVE., EUGENE, OREGON
DRAWN: J.L. 5/22/58 JOB NO. 654

Application No. G-993
Permit No. G-893