

T.18S. R.5W.W.M.

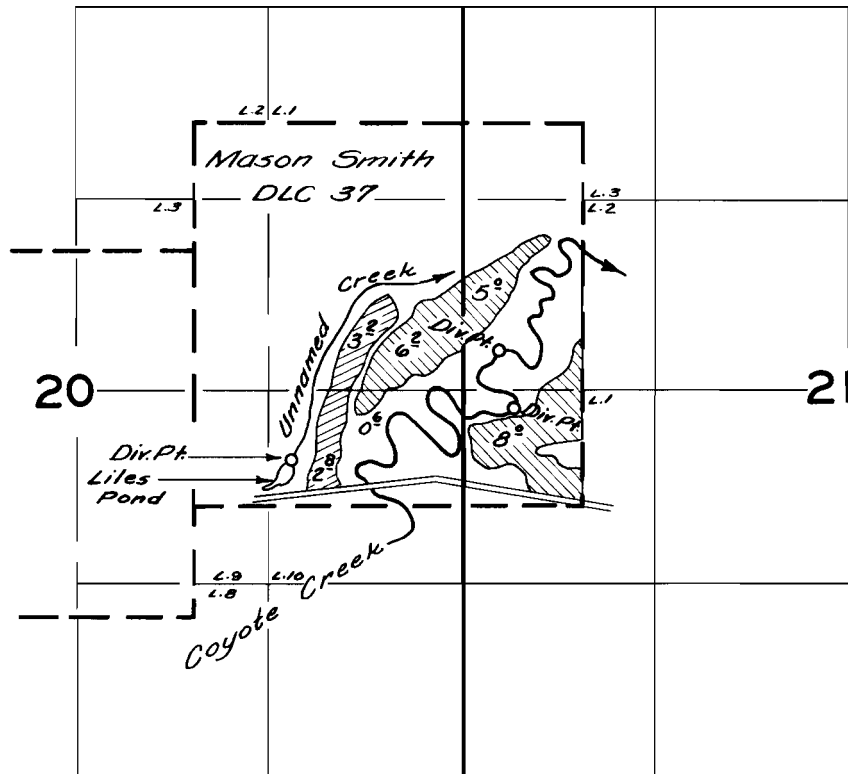

-  FROM COYOTE CREEK
-  FROM LILES POND (Unn. Creek)

FINAL PROOF SURVEY UNDER

Application No. 30545 Permit No. 24050
IN NAME OF

RODNEY L. LEATHERWOOD

Surveyed May 4, 1960, by C. O. Baer